



STORMSHIELD



GUIDE

STORMSHIELD NETWORK SECURITY

# PRODUCT PRESENTATION AND INSTALLATION 2024

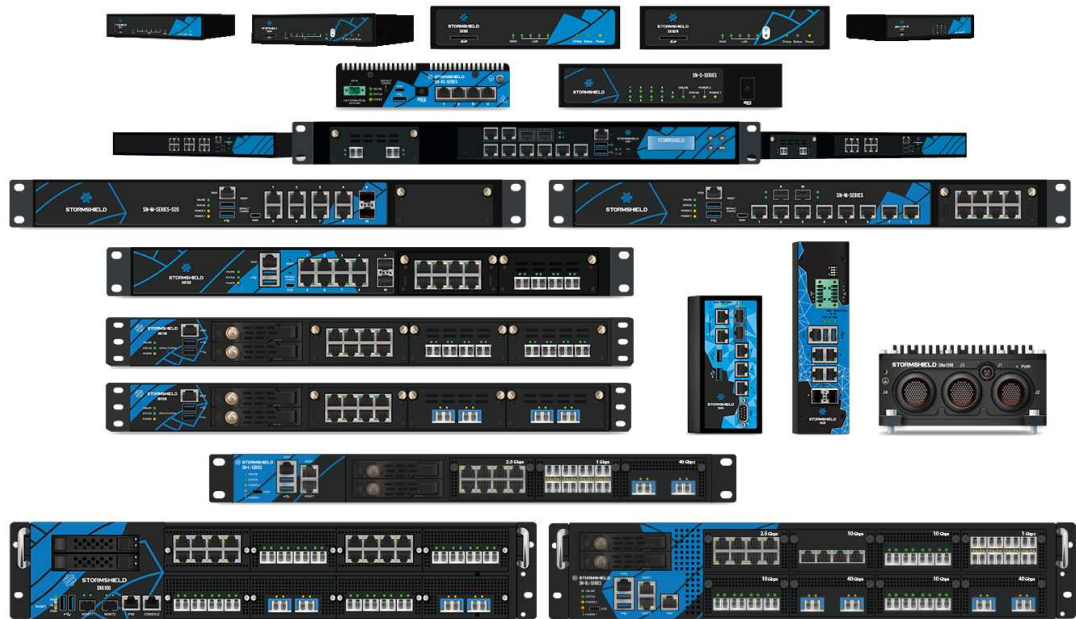

Date : December 10, 2024

Document version: 1.0

Reference: sns-en-SNrange\_installation\_guide



# Table of contents

<b>Foreword</b>	<b>4</b>
Products concerned	4
Recommendations on the operating environment	4
Regulations	6
<b>Introduction</b>	<b>7</b>
Administration tools	7
<b>Upon receiving your firewall</b>	<b>9</b>
Integrity of the product	9
Contents of the packaging	10
<b>Safety rules</b>	<b>12</b>
All models except SNi20, SNi40 and SNxr1200	12
SNi10, SNi20, SNi40, and SNxr1200 models	14
<b>Installation precautions</b>	<b>16</b>
Conditions of use (all models except SNi20, SNi40 and SNxr1200)	16
Conditions of use (SNi10, SNi20, SNi40 and SNxr1200 models)	17
Connecting to the mains	19
Connecting a DC power supply unit (SN-XS-Series-170, SNi10, SNi20, SNi40 and SNxr1200)	20
Connecting to the network	21
<b>Installation in a 19" rack and cabinet</b>	<b>22</b>
Installing SN160, SN160W, SN210, SN210, SN310, SN-XS-Series-170, SN-S-Series-220, SN-S-Series-320 and SNi10 models on a 19" cabinet shelf	22
Installing SN210, SN210W, SN310, SN-XS-Series-170, SN-S-Series-220, SN-S-Series-320 and SNi10 models on a 19" cabinet 1U shelf	23
Fastening SN160, SN160W, SN-XS-Series-170 and SNi10 models to a wall	25
Installing SN510, SN-M-Series-520, SN710, SN910, SN-M-Series-720 and SN-M-Series-920 models in a 19" cabinet	25
Installing SN1100, SN2100, SN3100, SN-L-Series-2200, SN-L-Series-3200, SN6100, SN-XL-Series-5200 and SN-XL-Series-6200 model in a 19" cabinet	25
Installing SN-XS-Series-170, SNi10, SNi20 and SNi40 models on DIN rails	26
<b>Presentation of the SNS range</b>	<b>27</b>
SN160 and SN160W models	27
SN210 and SN210W models	28

SN310 model	29
SN-XS-Series-170 and SNi10 models	30
SN-S-Series-220 and SN-S-Series-320 models	31
SN510 and SN710 models	33
SN-M-Series-520 models	34
SN910 model	34
SN-M-Series-720 and SN-M-Series-920 models	35
SN1100 model	36
SN2100 and SN3100 models	38
SN-L-Series-2200 and SN-L-Series-3200 models	39
SN6100 model	41
SN-XL-Series-5200 or SN-XL-Series-6200 models	41
SNi20 model	43
SNi40 model	45
SNxr1200 model	48
<b>Network connectors</b>	<b>53</b>
RJ45 Ethernet connectors	53
Fiber Ethernet connectors (all models except SN160, SN210, SN310 and SNxr1200)	58
Extension modules (SN710 and upwards)	63
<b>Initial connection to the product</b>	<b>68</b>
Requirements	68
Connections	68
Configuration	70
Startup	71
Shutting down	80
General remarks	81
<b>Updating the license</b>	<b>83</b>
Retrieving licenses	83
Install license	83
<b>Documentation &amp; assistance</b>	<b>84</b>
Documentation	84
MyStormshield personal area	84
Knowledge Base	84
Help desk	84
<b>Appendix A. Resetting firewalls</b>	<b>85</b>
All models except SN-L-Series-2200, SN-L-Series-3200, SN6100, SN-XL-Series-5200, SN-XL-Series-6200, SNi40 and SNxr1200	85
SN-L-Series-2200, SN-L-Series-3200, SN6100, SN-XL-Series-5200, SN-XL-Series-6200, SNi40 and SNxr1200 models	87
<b>Annexe B. Storing logs</b>	<b>88</b>
External log storage on SD/micro SD cards (SN160, SN160W, SN210, SN210W, SN310, SN-XS-Series-170, SN-S-Series-220, SN-S-Series-320, SNi10 and SNi20)	88



Enabling log storage .....	89
Reading logs .....	90
<b>Appendix C. Managing SSDs .....</b>	<b>91</b>
Detecting issues .....	91
Replacing an SSD .....	91
RAID option (SN2100) .....	92
Big Data option (SN2100, SN3100, SN-L-Series-2200, SN-L-Series-3200, SN6100, SN-XL-Series-5200 and SN-XL-Series-6200) .....	92
<b>Appendix D. Exchanging a power supply module .....</b>	<b>93</b>
SN1100, SN2100, SN3100, SN-L-Series-2200, SN-L-Series-3200, SN6100, SN-XL-Series-5200 and SN-XL-Series-6200 models .....	93
SN6100 .....	95
<b>Appendix E. Managing firewalls via IPMI .....</b>	<b>97</b>
SN6100, SN-XL-Series-5200 and SN-XL-Series-6200 models .....	97



## Foreword

We strongly recommend that you read this whole document before installing a Stormshield Network Security firewall.

This document presents the **Stormshield Network Security range** models marketed by Stormshield. In it, we explain the process of the physical installation needed to integrate an appliance into your network architecture. It also provides the necessary details for adding transceivers and network modules to SN-M-Series-520, SN710, SN910, SN-M-Series-720, SN-M-Series-920, SN1100, SN2100, SN3100, SN-L-Series-2200, SN-L-Series-3200, SN6100, SN-XL-Series-5200, SN-XL-Series-6200, SNi20 and SNi40 models.

The aim of this document is to allow you to quickly integrate a Stormshield Network Security firewall into your network but does not provide any information on how to configure the product. Several documents (guides and technical notes) explaining the configuration of the firewall are available in the Network Security section of the Stormshield documentation website: <https://documentation.stormshield.eu>.

For more information on using and configuring your firewall, refer to the [SNS user guide](#).

## Products concerned

SN160, SN160W, SN210, SN210W, SN310, SN-XS-Series-170, SN-S-Series-220, SN-S-Series-320, SN510, SN-M-Series-520, SN710, SN910, SN-M-Series-720, SN-M-Series-920, SN1100, SN2100, SN3100, SN-L-Series-2200, SN-L-Series-3200, SN6100, SN-XL-Series-5200, SN-XL-Series-6200, SNi10, SNi20, SNi40 and SNxr1200.

### NOTE

For earlier products in the **Stormshield Network Security range** (SN150, SN200, SN300, SN500, SN700, SN900, SN2000, SN3000 and SN6000), refer to the 2016 version of this [Product presentation and installation guide](#).

## Recommendations on the operating environment



### Definition

On an Evaluation Assurance Level or EAL scale of 1 to 7, the Common Criteria evaluate a product's capacity to provide security functions for which it had been designed, as well as the quality of its life cycle (development, production, delivery, operation, and updates).

## Introduction

The installation of a firewall is often part of implementing a global security policy. To ensure optimal protection of your assets, resources and information, installing a firewall between your network and the Internet is only the first step. This is mainly because the majority of attacks come from the inside (accidents, disgruntled employees, dismissed employee having retained internal access, etc.). And anyone would agree that installing a steel security door defeats its purpose when the walls are made of paper.

Stormshield Network Security therefore adopts and applies the usage recommendations defined in the Common Criteria in its administration suite and firewalls. These



recommendations set out the usage requirements to meet to ensure that your firewall operates within the context of the common criteria certification.

For further information on Common Criteria compliance, go to:  
<https://documentation.stormshield.eu/common-criteria.html>.

## Security watch

Check regularly for the Stormshield security advisories published on  
<https://advisories.stormshield.eu>.

Always apply updates if they fix security flaws on your firewall. Updates are available here:  
<https://mystormshield.eu>.

## Physical security measures

Stormshield Network Security firewalls must be installed and stored in compliance with the state of the art regarding sensitive security devices: secured access to the premises, shielded cables with twisted pairs, labeled cables, etc.

## Organizational security measures

The default password of the admin user (super administrator) must be changed the very first time the product is used. In the web administration interface, this password can be changed in **Configuration > System > Administrator > Administration account**.

This password must be set in line with the best practices described in the *User awareness* section in the [SNS user guide](#).

A particular administrative role – that of the super-administrator – has the following characteristics:

- The only administrator authorized to log in via the local console on firewalls, and only during the installation of the firewall or for maintenance operations outside of normal production use,
- In charge of defining the profiles of other administrators,
- The premises where the firewalls are stored must only be accessed under this administrator's supervision, regardless of whether the purpose of the access is to conduct operations on the product or on other equipment. All operations on firewalls have to be conducted under this administrator's responsibility.

## IT security environment

Stormshield Network Security firewalls must be installed in line with the current network interconnection policy, and must be the only gateways between the various networks to which the information flow control policy has to be applied. They are scaled according to the capacities of the adjacent devices or these devices restrict the number of packets per second, positioned slightly below the maximum processing capacities of each appliance installed in the network architecture.



## Regulations

### WEEE (Waste Electrical and Electronic Equipment) directive



All Stormshield Network Security products to which the WEEE directive applies are marked with the mandated crossed-out wheeled bin symbol. This symbol means that the product meets the requirements laid down by the WEEE directive with regard to the destruction and reuse of waste electrical and electronic equipment.



### RoHS (Restriction of Hazardous Substances) directive

For further information on RoHS compliance or on the Stormshield Network firewall recycling program (WEEE), refer to: <https://www.stormshield.com/about-us/recycling/>.

## Certifications





## Introduction

Thank you for choosing Stormshield Network Security. Designed to protect networks of all sizes, **Stormshield Network Security - SNS range** appliances are pre-configured: no hardware or software installation is needed and no UNIX knowledge is necessary, just a user-friendly configuration via a graphical interface.

The **Stormshield Network Security (SNS)** range consists of 26 products:

SN160, SN160W, SN210, SN210W, SN310, SN-XS-Series-170, SN-S-Series-220, SN-S-Series-320, SN510, SN-M-Series-520, SN710, SN910, SN-M-Series-720, SN-M-Series-920, SN1100, SN2100, SN3100, SN-L-Series-2200, SN-L-Series-3200, SN6100, SN-XL-Series-5200, SN-XL-Series-6200, SNi10, SNi20, SNi40 and SNxr1200.

The architecture of the new-generation SNS range was specifically designed to maximize the performance of the Stormshield Network Security protection engine. Complex application traffic is therefore inspected at high speed at the heart of the network and without discernible latency [less than 1 millisecond].

Hardware acceleration for data encryption also anticipates multiple high-speed VPN sessions.

The SNS firewall makes it possible to define incoming or outgoing access control rules. Its concept is simple: any incoming or outgoing transmission passing through the firewall is monitored, allowed or blocked according to the rules, packet by packet.

The SNS firewall is based on a sophisticated packet filtering mechanism that provides a high level of security. All firewalls integrate the ASQ (Active Security Qualification) technology developed by Stormshield Network Security. This technology makes it possible to detect and block hacking attempts in real time: illegal packets, denial of service attempts, anomalies in a connection, port scans, buffer overflows, etc.

In an intrusion attempt, depending on the instructions set in the security policy, the SN firewall blocks the transmission, generates an alarm and stores the information linked to the packet which set off the alarm. You will therefore be able to analyze the attack and trace its source.

The SNS firewall not only allows you to prevent, or restrict to just certain services, incoming connections on your network, but also makes it possible to monitor your internal users' Internet usage (HTTP, FTP, SMTP, etc.). You can also monitor your users by authenticating them via an internal or external authentication database.

The SNS firewall also manages port and address translation mechanisms. These mechanisms provide security (by masking your internal address range) and flexibility (by enabling the use of any private internal addressing range) and reduce costs (by enabling the provision of several servers on the Internet with a single public IP address).

Stormshield Network Vulnerability Manager, the risk management solution, is based on the detection of applications and the associated vulnerabilities. It allows you to quickly zero in on the most vulnerable hosts, identify affected applications and know which bug fixes to apply.

Lastly, the SNS firewall includes VPN gateway functions allowing you to establish encrypted tunnels with other VPN equipment. In this way, your communications between sites or with your mobile users may be secured even while using an insecure communication infrastructure like the Internet.

## Administration tools

Thanks to the web administration interface, you can administer your Stormshield Network Security firewall from the operating system of your choice. The new firewall configuration





interface, accessible from a web browser, benefits from the latest breakthroughs in user friendliness and simplicity of use.

## Monitoring tab

The **dashboard** gives an overview of information relating to the firewall's activity and its configuration.

The **Logs - Audit logs** module, available on firewalls equipped with storage media, allows you to read logs generated by appliances and stored locally. These logs are grouped by views, i.e., by alarm, connection, web log, etc. Advanced filters make it possible to analyze logs even deeper.

In the **Reports** module, you will be able to view how Internet access is used, which attacks your firewall has blocked, and which hosts are vulnerable on your corporate network. Many interactive features allow you to modify the configuration of your firewall. These reports appear as Top 10 lists in Web, Security, Viruses, Vulnerabilities and Spam.

The **Monitoring** module shows graphs and data in real time, and history graphs can be added to these if this option is enabled in the **Report configuration** module.

## Stormshield Management Center

With the SMC administration tool, you can manage and supervise a pool of SNS firewalls. Common or specific filter rules and VPN access can be set up to optimize configuration tasks. Always keep your firewall pool up to date, make regular backups and configure the privileges of your SMC administrators.





## Upon receiving your firewall

Several security mechanisms have been implemented to guarantee the integrity of the product that you receive, and confirm that your product has not been tampered with. **Check them carefully to avoid any ambiguity regarding the application of the warranty.**

If your product does not match your order, report any anomaly to your reseller within 48 hours after you receive the product.

### Integrity of the product

#### Seals and labels on the packaging

Every firewall is delivered in a cardboard box sealed with one or two warranty seals. A label on the packaging indicates information that identifies the product it contains and its version. Check that this information matches your order.

#### Seals

Every firewall is sold in a closed cardboard box sealed with a "STORMSHIELD QUALITY SEAL".

#### ! IMPORTANT

If this seal is missing or has been tampered with, contact your distributor as soon as possible to find out why the packaging has been opened.



Figure 1: "Stormshield Quality seal" label

#### Identification labels

These labels indicate the information relating to the firewall (product reference, part number, serial number, software version installed, etc). Check that this information matches your order. You can also check whether the version installed has been certified.



Figure 2: Product labels on the cardboard box

#### Labels on the product

##### Warranty label

A warranty label is pasted on all firewalls. Once this label is torn, the warranty will be void.



Figure 3: Warranty label



## Serial number label

This label displays your product's serial number and registration password. It is pasted on:

- The underside of SN160, SN160W, SN210, SN210W, SN310, SN-XS-Series-170, SN-S-Series-220, SN-S-Series-320, SN2100, SN3100, SN-L-Series-2200, SN-L-Series-3200, SN-XL-Series-5200, SN-XL-Series-6200 and SNI10 models,
- The back of SN510, SN-M-Series-520, SN710, SN910, SN-M-Series-720, SN-M-Series-920, SN1100, SN6100 and SNxr1200 models,
- The side of SNI20 and SNI40 models.

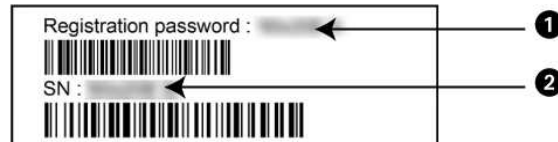

Figure 4: Serial number label

### ! IMPORTANT

Take note of your registration password (1) and your serial number (2). You will be asked for these during the installation and registration of your product.

## Product label

This label, found on your product, provides information relating to the firewall, such as the part number and the product's electrical power characteristics.

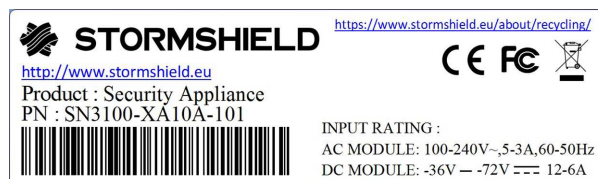

Figure 5: Product label

## Contents of the packaging

Keep the cardboard packaging in a safe place in case you need it later to transport the firewall. The packaging is shock resistant to protect your SNS firewall optimally.

Upon delivery, check that all the following components are included:

- Your Stormshield Network Security firewall,
- A power cord (two for SN-M-Series-520, SN-M-Series-720, SN-M-Series-920, SN1100, SN2100, SN3100, SN-L-Series-2200, SN-L-Series-3200, SN6100, SN-XL-Series-5200 and SN-XL-Series-6200 models),
- A power adapter (SN160, SN160W, SN210, SN210W, SN310, SN-XS-Series-170, SN-S-Series-220, SN-S-Series-320 and SNI10 models),
- A 2-pole screw connector (SN-XS-Series-170 and SNI10 models),
- A 6-pole screw connector (SNI20 and SNI40),
- A Category-5e RJ45 crossover cable,
- An "A to B" USB cable (SN160, SN160W, SN210, SN210W and SN310 models) or "A to C" USB cable (SN-XS-Series-170, SN-S-Series-220, SN-S-Series-320, SN-M-Series-520, SN-M-Series-720, SN-M-Series-920, SN-L-Series-2200, SN-L-Series-3200, SN-XL-Series-5200, SN-XL-Series-6200 and SNI10 models),



- An RJ45 to DB9F serial DB9F (SN510, SN-M-Series-520, SN710, SN910, SN-M-Series-720, SN-M-Series-920, SN1100, SN2100, SN3100, SN-L-Series-2200, SN-L-Series-3200, SN6100, SN-XL-Series-5200, SN-XL-Series-6200 and SNi20) or DB9F serial (SNi40 and SNxr1200 models),
- An "A to B" micro USB cable (SN1100),
- Three Wi-Fi antennae to be screwed to the back of the appliance (SN160W and SN210W).

For SN510, SN-XS-Series-170, SN-S-Series-220, SN-S-Series-320, SN-M-Series-520, SN710, SN910, SN-M-Series-720, SN-M-Series-920, SN1100 and SNi10 models, the packaging should also contain four non-slip rubber feet.

SN6100 models have brackets mounted by default so that they can be installed in a rack. Depending on the model, the following components are also included for racking:

- SN510, SN-M-Series-520, SN710, SN910, SN-M-Series-720 and SN-M-Series-920 models: a set of brackets and screws,
- SN1100: a set of brackets, rails and screws,
- SN2100, SN3100, SN-L-Series-2200, SN-L-Series-3200, SN-XL-Series-5200 and SN-XL-Series-6200 models contain a set of brackets, slide rails and screws,
- SN6100: a set of slide rails and screws.

SN-XS-Series-170, SNi10, SNi20 and SNi40 models are equipped with a fastener for a 35 mm-wide DIN rail (EN50022 standard).

#### **i** NOTE

As SN160, SN160W, SN210, SN210W, SN310, SN510, SN-XS-Series-170, SN-S-Series-220, SN-S-Series-320, SN-M-Series-520, SN710, SN910, SN-M-Series-720, SN-M-Series-920, SN1100 and SNi10 firewalls can be installed on a desk or in a rack, their non-slip rubber feet come separately.

The documentation provided includes:

- General Conditions of Use and User License,
- Safety Rules and Installation Precautions,
- Quick Installation Guide (accessible via QR code on SN-XS-Series-170 and SNi10 models),
- Installation guide for mounting the firewall in a rack (SN1100, SN2100, SN3100, SN-L-Series-2200, SN-L-Series-3200, SN6100, SN-XL-Series-5200 and SN-XL-Series-6200 models).

If any component is missing, contact your distributor immediately.



## Safety rules

Before installing anything, carefully read and follow the safety instructions.

### All models except SNI20, SNI40 and SNxr1200



#### IMPORTANT

You must use the power adapter provided with the product.

### Before plugging in any devices

- Ensure that neither your Stormshield product, the power cord nor power adapter is damaged.
- Ensure that the power supply or power adapter of your firewall is compatible with the voltage of your power supply network.
- When the product's power cord or power adapter has a ground pin, it must be plugged into a properly grounded electrical outlet. Ensure that the connection is reliable and that the protective earth circuit of your installation complies with safety standards in force.
- To be able to disconnect the product, ensure that the connection to the power supply is always easily accessible.

### Prior to plugging any equipment into a -48VDC power supply module (SN1100, SN2100, SN3100, SN-L-Series-2200, SN-L-Series-3200, SN6100, SN-XL-Series-5200 and SN-XL-Series-6200 models)

#### Special considerations for equipment connected to a DC mains supply:

- Please follow IEC, NEC, ANSI/NFPA 70 and CEC, Part I, C22.1 for all relevant field wiring instructions and cautions. The equipment must be installed by a qualified electrician
- Before using the equipment, the chassis must be permanently and reliably connected to the protective earth circuit, using a yellow-green cable with these minimum ratings:
  - 1.5 mm<sup>2</sup> (16 AWG) on SN1100, SN2100 and SN3100 models,
  - 3.31 mm<sup>2</sup> (12 AWG) on SN-L-Series-2200, SN-L-Series-3200 and SN6100 models,
  - 5.3 mm<sup>2</sup> (10 AWG) on SN-XL-Series-5200 and SN-XL-Series-6200 models.
- The equipment must be connected to the DC mains supply with an approved switch or breaker.
- The equipment must only be connected to the DC mains supply with cables that have these minimum ratings:
  - 1.5 mm<sup>2</sup> (16 AWG) on SN1100, SN2100 and SN3100 models,
  - 3.31 mm<sup>2</sup> (12 AWG) on SN-L-Series-2200, SN-L-Series-3200 and SN6100 models,
  - 5.3 mm<sup>2</sup> (10 AWG) on SN-XL-Series-5200 and SN-XL-Series-6200 models.

### Warranty and safety rules

Never take apart a Stormshield Network Security appliance on your own. Only Stormshield, which markets the Stormshield Network Security range, and its approved maintenance agents



are authorized to do so. A seal label protects all Stormshield Network Security firewalls from being opened.

**Your warranty will be rendered null and void as soon as you dismantle a Stormshield Network Security firewall on your own.**

**! IMPORTANT**

**Never dismantle your Stormshield Network Security appliance, as doing so may cause hardware accidents and/or bodily harm.**

**! IMPORTANT**

Do not insert objects into the appliance's vents – this may hinder the rotation of an internal fan or damage it, causing the appliance to overheat. This may also cause a short-circuit that may lead to the breakdown of the appliance.

**! IMPORTANT**

Copper Ethernet cables connected to your Stormshield Network Security firewall must not be connected to other appliances located in other buildings.

In line with legal safety requirements, anyone performing any operation on a Stormshield Network Security range product must know and follow the safety indications below:

**To the attention of maintenance teams:**

**! WARNING**

**DANGER OF EXPLOSION IF BATTERY IS INCORRECTLY REPLACED. REPLACE ONLY WITH SAME OR EQUIVALENT TYPE RECOMMENDED BY THE MANUFACTURER. DISCARD USED BATTERIES ACCORDING TO THE MANUFACTURER'S INSTRUCTIONS.**

Only qualified personnel from an approved maintenance center can perform operations on this component.

If a hardware issue occurs on your firewall or if one of the accessories does not match its description, contact your certified partner.

## Installing an appliance outside a rack

Your product must be equipped with its non-slip rubber feet in order to reduce the possibility of your appliance slipping off the surface on which it has been installed.

These flexible non-slip rubber feet are to be attached to the underside of the chassis on SN160, SN160W, SN210, SN210W, SN310, SN510, SN-XS-Series-170, SN-S-Series-220, SN-S-Series-320, SN-M-Series-520, SN710, SN910, SN-M-Series-720, SN-M-Series-920, SN1100 and SNi10 models. Refer to the section [Installation precautions](#) for further information.

## Assembly in a cabinet

For a racked installation, place heavier appliances in the lower section of the rack and lighter elements in the higher section. Refer to the section [Installation in a 19" cabinet and rack](#) for details on how to install an appliance in a racking bay.



## Precautions

- **Installation kit:** use only the installation kit supplied with the product for rack mounting.
- **Elevated Operating Ambient Temperature** - If installed in a closed or multi-unit rack assembly, the operating ambient temperature of the rack environment may be greater than room ambient. Therefore, consideration should be given to installing the equipment in an environment compatible with the maximum ambient temperature (T<sub>ma</sub>) specified by the manufacturer.
- **Reduced Air Flow** - Installation of the equipment in a rack should be such that the amount of air flow required for safe operation of the equipment is not compromised.
- **Mechanical Loading** - Mounting of the equipment in the rack should be such that hazardous conditions due to uneven mechanical loading are avoided.
- **Circuit Overloading** - Consideration should be given to the connection of the equipment to the supply circuit and the effect that overloading of the circuits might have on overcurrent protection and supply wiring. Appropriate consideration of equipment nameplate ratings should be used when addressing this concern.
- **Reliable Earthing** - Reliable earthing of rack-mounted equipment should be maintained. Particular attention should be given to supply connections other than direct connections to the branch circuit (e.g. use of power strips).
- **Leakage current** - considerations should be given to the summation of leakage currents when installing the equipment in a closed or multi-unit rack assembly.

## SNi10, SNi20, SNi40, and SNxr1200 models

### Before plugging in any devices

- Ensure that your Stormshield product and its accessories are not damaged.
- Ensure that the electrical characteristics of your product indicated on the product label are compatible with those of your power supply network
- The chassis of your product must be connected to a protective earth circuit, using rated minimum 1 mm<sup>2</sup> wire (16AWG) on SN-XS-Series-170, SNi10, SNi20, SNi40 and SNxr1200 models. Ensure that the connection is permanent and reliable, and that the protective earth circuit of your installation complies with safety standards in force.
- Before installing or removing your product, ensure that it has been turned off, and that all power supply connections have been removed.
- Equipment connected to a DC mains supply: please follow IEC, NEC, ANSI/NFPA 70 and CEC, Part I, C22.1 for all relevant field wiring instructions and cautions. The equipment must be installed by a qualified electrician. Only the CEI standard applies to the SNxr1200.
- The equipment shall be connected to the DC mains supply with an approved switch or breaker and easily accessible.
- Only wires rated minimum 16AWG or 1 mm<sup>2</sup> must be used to connect the equipment to the DC mains supply on SN-XS-Series-170, SNi10, SNi20, SNi40 and SNxr1200 models.

## Warranty and safety rules

Never take apart a Stormshield Network Security appliance on your own. Only Stormshield, which markets the Stormshield Network Security range, and its approved maintenance agents



are authorized to do so. A seal label protects all Stormshield Network Security firewalls from being opened.

**Your warranty will be rendered null and void as soon as you dismantle a Stormshield Network Security firewall on your own.**

**! IMPORTANT**

**Never dismantle your Stormshield Network Security appliance, as doing so may cause hardware accidents and/or bodily harm.**

**! IMPORTANT**

**Copper Ethernet cables connected to your Stormshield Network Security firewall must not be connected to other appliances located in other buildings.**

In line with legal safety requirements, anyone performing any operation on a Stormshield Network Security range product must know and follow the safety indications below:

**To the attention of maintenance teams:**

**! WARNING**

**DANGER OF EXPLOSION IF BATTERY IS INCORRECTLY REPLACED. REPLACE ONLY WITH SAME OR EQUIVALENT TYPE RECOMMENDED BY THE MANUFACTURER. DISCARD USED BATTERIES ACCORDING TO THE MANUFACTURER'S INSTRUCTIONS.**

Only qualified personnel from an approved maintenance center can perform operations on this component.

If a hardware issue occurs on your firewall or if one of the accessories does not match its description, contact your certified partner.

## Precautions for assembly in a cabinet

- **Installation kit:** use only the installation kit supplied with the product.
- **Elevated Operating Ambient** - If installed in a closed or multi-unit cabinet assembly, the operating ambient temperature of the cabinet environment may be greater than room ambient. Therefore, consideration should be given to installing the equipment in an environment compatible with the maximum ambient temperature (T<sub>ma</sub>) specified by the manufacturer.
- **Reduced Air Flow** - Installation of the equipment in a cabinet should be such that the amount of air flow required for safe operation of the equipment is not compromised.
- **Mechanical Loading** - Mounting of the equipment in the cabinet should be such that a hazardous condition is not achieved due to uneven mechanical loading.
- **Circuit Overloading** - Consideration should be given to the connection of the equipment to the supply circuit and the effect that overloading of the circuits might have on overcurrent protection and supply wiring. Appropriate consideration of equipment nameplate ratings should be used when addressing this concern.
- **Reliable Earthing** - Reliable earthing of cabinet-mounted equipment should be maintained. Particular attention should be given to supply connections other than direct connections to the branch circuit (e.g. use of terminal blocks)





## Installation precautions

A firewall is a central device in your network, so it requires special attention. Install it under optimal conditions.

### **i** NOTE

Instructions on how to connect products are also given in the [SNS Quick Installation Guide](#).

### Conditions of use (all models except SNI20, SNI40 and SNxr1200)

The Stormshield Network Security firewall is designed to run continuously, in an office or in a server room. If you wish to install your appliance in an office, choose a flat and uncluttered surface. Add the non-slip rubber feet to SN160, SN160W, SN210, SN210W, SN310, SN-XS-Series-170, SN-S-Series-220, SN-S-Series-320, SN510, SN-M-Series-520, SN710, SN910, SN-M-Series-720, SN-M-Series-920, SN1100 and SNI10 models: stick a non-slip rubber foot to the underside of the appliance, close to each corner about 2 cm from the edges. This will ensure the stability of the firewall and protect it from scratches.

### **!** IMPORTANT

When firewalls are in storage, they have to be powered up for a 24-hour period at least once every two years, to allow the internal electrolytic capacitors to reform. Failure to do so may compromise their reliability.

### **!** WARNING

The firewall must be installed in compliance with state-of-the-art conditions of secure installation, i.e., in a protected office or other premises with limited access. To guarantee the integrity of the product and to avoid compromising the security of your installation, all unauthorized access to the firewall must be prevented.

### **i** NOTE

Ensure that the cables do not obstruct passageways to prevent them from being pulled out or the product from falling.

Do not install and/or use your Stormshield firewall close to an area where inflammable objects are stored or used. Your Stormshield firewall is intended for indoor use (office environment or other IT environment), away from areas that may receive rainfall, floods or excessive humidity. It must be installed away from sources of shocks, vibrations, and dust, in an environment where the temperature conforms to the product's specifications.

The ideal ambient temperature is around 25°C. The tables below set out the operational temperature, storage temperature and humidity level for all models of SNS range.



SN160, SN160W, SN210, SN210W, SN310, SN-S-Series-220, SN-S-Series-320, SN510, SN-M-Series-520, SN710, SN910, SN-M-Series-720, SN-M-Series-920, SN1100, SN2100, SN3100, SN-L-Series-2200, SN-L-Series-3200, SN-XL-Series-5200 and SN-XL-Series-6200 models

Operating temperature	Relative humidity operating (%)	Storage temperature	Relative humidity storage (%)
+0° to +40°C (+32° to +104°F)	0% to 95% at +40°C (+104°F) non-condensing	-30° to +65°C (-22° to +149°F)	5% to 95% at +60°C (+140°F) non-condensing

#### SN-XS-Series-170 and SNi10 models

Operating temperature	Relative humidity operating (%)	Storage temperature	Relative humidity storage (%)
-20° to +60°C (-4° to +140°F)	0% to 95% at +60°C (+140°F) non-condensing	-40° to +85°C (-4° to +185°F)	0% to 95% non-condensing

#### SN6100 model

Operating temperature	Relative humidity operating (%)	Storage temperature	Relative humidity storage (%)
+0° to +40°C (+32° to +104°F)	0% to 90% at +40°C (+104°F) non-condensing	-20° to +70°C (-4° to +158°F)	5% to 95% non-condensing

#### **! IMPORTANT**

Avoid in particular direct exposure to sunlight. Always keep adequate distance around the appliance's vents in order to guarantee a free flow of air, thereby preventing the possibility of overheating.

#### **! IMPORTANT**

Do not place objects on your Stormshield Network appliance.

#### **! IMPORTANT**

Stormshield Network Security appliances have been tested, and comply with the limits defined for Class A digital devices, in line with section 15 of the FCC regulation. The purpose of these limits is to provide reasonable protection from harmful interference that may arise when an appliance is used in a commercial environment. Stormshield Network Security firewalls generate, use and potentially emit radioelectric waves that may cause harmful interference to radio communications if not installed and used according to the instructions in the manual. Using your appliance in a residential area may cause harmful interference. If this is the case, the user will need to resolve these issues at his own expense.

Stormshield Network Security firewalls comply with the requirements set out in the European standard EN55032, Class A. In a residential environment, a Class A product may cause radioelectric interference, for which the user may need to take appropriate measures.

## Conditions of use (SNi10, SNi20, SNi40 and SNxr1200 models)

SNi10, SNi20, SNi40 and SNxr1200 firewalls have been built to run continuously, in a server room for SNi10, SNi20 and SNi40 appliances, or embedded for the SNxr1200 model.

**! IMPORTANT**

When firewalls are in storage, they have to be powered up for a 24-hour period at least once every two years, to allow the internal electrolytic capacitors to reform. Failure to do so may compromise their reliability.

**! WARNING**

The firewall must be installed in compliance with state-of-the-art conditions of secure installation, i.e., in protected premises with limited access. To guarantee the integrity of the product and to avoid compromising the security of your installation, all unauthorized access to the firewall must be prevented.

**i NOTE**

Ensure that the cables do not obstruct passageways to prevent them from being pulled out or the product from falling.

Do not install and/or use your Stormshield firewall close to an area where inflammable objects are stored or used.

Your SNI10, SNI20 or SNI40 firewall is intended for industrial use (see product specifications), away from areas that may be vulnerable to rainfall, floods or excessive humidity. It must be installed away from sources of shocks, vibrations, and dust, in an environment where the temperature conforms to the product's specifications.

Your SNxr1200 firewall is a built-in system that must be installed under conditions that meet the environmental qualifications provided by Stormshield (upon request).

The ideal ambient temperature is around 25°C. The tables below set out the operational temperature, storage temperature and humidity level for SNI10, SNI20, SNI40 and SNxr1200 models.

SNI10, SNI20, SNI40, and SNxr1200 models

Model	Operating temperature	Relative humidity operating (%)	Storage temperature	Relative humidity storage (%)
SNI10	-20° to +60°C (-4° to +140°F)	0% to 95% non-condensing	-40° to +85°C (-40° to +185°F)	0% to 95% non-condensing
SNI20 and SNxr1200	-40° to +70°C (-40° to +158°F)			
SNI40	-40° to +75°C (-40° to +167°F)			5% to 95% non-condensing



The tables below set out the operational temperature, storage temperature and humidity level for the power adapter, which is sold separately.

Power adapter for SNI20 (optional) and SNI10 (industrial) models

Operating temperature	Relative humidity operating (%)	Storage temperature	Relative humidity storage (%)
-30° to +60°C [-22° to +140°F]	20% to 90% non-condensing	-40° to +85°C [-40° to 185°F]	10% to 95% non-condensing

Power adapter for SNI40 models (optional)

Operating temperature	Relative humidity operating (%)	Storage temperature	Relative humidity storage (%)
0° to +40°C [+32° to +104°F]	10% to 90% non-condensing	-20° to +70°C [-4° to +158°F]	10% to 90% non-condensing

Power adapter for SNxr1200 models (optional)\*

Operating temperature	Relative humidity operating (%)	Storage temperature	Relative humidity storage (%)
-30° to +70°C [-22° to +158°F]	20% to 90% non-condensing	-40° to +85°C [-40° to +185°F]	10% to 95% non-condensing

*\*approved only for pre-production*

**! IMPORTANT**

Avoid in particular direct exposure to sunlight. Always keep an adequate distance around the appliance (at least 50 mm for the SNxr1200 model) in order to guarantee a free flow of air, thereby preventing the possibility of overheating.

**! IMPORTANT**

Do not place objects on your Stormshield Network Security appliance.

**! IMPORTANT**

Stormshield Network Security appliances have been tested, and comply with the limits defined for Class A digital devices, in line with section 15 of the FCC regulation. The purpose of these limits is to provide reasonable protection from harmful interference that may arise when an appliance is used in a commercial environment. Stormshield Network Security firewalls generate, use and potentially emit radioelectric waves that may cause harmful interference to radio communications if not installed and used according to the instructions in the manual. Using your appliance in a residential area may cause harmful interference. If this is the case, the user will need to resolve these issues at his own expense.

Stormshield Network Security firewalls comply with the requirements set out in the European standard EN55032, Class A. In a residential environment, a Class A product may cause radioelectric interference, for which the user may need to take appropriate measures.

## Connecting to the mains

The supported voltage ranges from 100V to 240V.

**i NOTE**

You are strongly advised to connect all appliances to a UPS device. As SN-M-Series-520, SN-M-Series-720, SN-M-Series-920, SN3100, SN-L-Series-2200, SN-L-Series-3200, SN6100, SN-XL-Series-5200 and SN-XL-Series-6200 models are equipped with redundant power supplies (option offered on SN-S-Series-220, SN-S-Series-320, SN1100 and SN2100 models), plugging them into two separate mains circuits is recommended.

**i NOTE**

In the event of an accidental power cut, the product will automatically start up once it is powered up again.

**i NOTE**

For SN1100, SN2100, SN3100, SN-L-Series-2200, SN-L-Series-3200, SN6100, SN-XL-Series-5200 and SN-XL-Series-6200 models, -48VDC power supply modules may be provided separately upon request.

**For SN160, SN160W, SN210, SN210W, SN310, SN-XS-Series-170, SN-S-Series-220, SN-S-Series-320 and SNi10 models**, insert or screw the connector of the power adapter into the power socket on the rear panel of the firewall. Next, connect the adapter to an appropriate mains socket using the power cord provided.

**For SN510, SN710, SN910 and SN1100 models**, insert the plug of the power cord (provided with the product) into the power socket on the rear panel of the appliance. Next, plug the other end of the power cord into an appropriate mains socket.

**For SN-M-Series-520, SN-M-Series-720, SN-M-Series-920, SN3100, SN-L-Series-2200, SN-L-Series-3200, SN6100, SN-XL-Series-5200 and SN-XL-Series-6200 models**, insert the plugs of both power cords provided into both power sockets located on the rear panel of the appliance. Next, plug in the other ends of the power cords into appropriate mains sockets.

## Connecting a DC power supply unit (SN-XS-Series-170, SNi10, SNi20, SNi40 and SNxr1200)

On SN-XS-Series-170, SNi10 and SNi20 models, the supported voltage ranges from 12 VDC to 48 VDC. On SNi40 and SNxr1200 models, the supported voltage ranges from 12 VDC to 36 VDC.

**! REMINDER**

Equipment has to be installed by a qualified electrician.

**i NOTE**

You are strongly advised to connect all appliances to a UPS device. SNi20 and SNi40 models are equipped with a redundant power supply unit, so we recommend that you connect your appliance to two independent sources of power.

**i NOTE**

If the power supply is disrupted, the appliance will automatically start up once it is powered up again.

**i NOTE**

A power adapter may be ordered separately.

## Connecting to the network

All models except the SNxr1200 are fitted with **RJ45** Gigabit Ethernet ports by default. On the SNxr1200 model, **RJ45** Gigabit Ethernet is offered as an option via breakout cables.

SN910, SN-M-Series-520, SNi20 and SNi40 models offer by default two SFP sockets, which make it possible to insert **SFP** transceivers, provided as an option.

The SN-M-Series-720, SN-M-series-920, SN1100 and SN6100 models also have by default two SFP+ sockets, making it possible to insert **SFP+** transceivers provided as an option.

SN710, SN910, SN-M-Series-520, SN-M-Series-720, SN-M-Series-920, SN1100, SN2100, SN3100, SN-L-Series-2200 and SN-L-Series-3200, SN6100, SN-XL-Series-5200 and SN-XL-Series-6200 models also offer one or several slots for various types of extension modules, depending on the module reference ordered, that allow Ethernet ports to be added:

- **RJ45** copper,
- Or module for **SFP** transceivers,
- Or module for **SFP+** transceivers,
- Or module for **SFP28** transceivers,
- Or module for **QSFP+** transceivers.

There are:

- One available slot on SN-M-Series-520, SN710, SN910, SN-M-Series-720 and SN-M-Series-920 models,
- Two available slots on SN1100 models,
- Three available slots on SN2100, SN3100, SN-L-Series-2200 and SN-L-Series-3200 models,
- Eight available slots on SN6100, SN-XL-Series-5200 and SN-XL-Series-6200 models.

**! IMPORTANT**

Use only **Stormshield Network-approved SFP (1Gbe), SFP+ (1Gbe/10Gbe), SFP28 (10Gbe/25Gbe) or QSFP+ (40Gbe) transceivers** available in the catalogue.

For information on the type of network cable to choose according to the network port and the selected connectors, see the sections [Extension modules \(SN710 and upwards\)](#) and [Fiber Ethernet connectors](#).



## Installation in a 19" rack and cabinet

All Stormshield Network Security appliances can be installed in 19-inch cabinets (except SNi20, SNi40 and Snxr1200 models). A rack-mounting system, in the form of a rackable shelf that can hold two firewalls, can be supplied upon request on SN160, SN160W, SN210, SN210W, SN310, SN-XS-Series-170, SN-S-Series-220, SN-S-Series-320 and SNi10 models.

SN510, SN-M-Series-520, SN710, SN910, SN-M-Series-720, SN-M-Series-920, SN2100 and SN3100 models come with a set of brackets. The SN1100 model is sold with a set of brackets and rails. SN2100, SN3100, SN-L-Series-2200, SN-L-Series-3200, SN6100, SN-XL-Series-5200 and SN-XL-Series-6200 models come with a set of slide rails.

### ! REMINDER

Ensure that the cabinet complies with temperature and humidity conditions indicated in the section [Conditions of use](#).

### i NOTE

SN160, SN160W, SN-XS-Series-170 and SNi10 models can also be installed vertically (screws and fasteners not provided).

### Installing SN160, SN160W, SN210, SN210, SN310, SN-XS-Series-170, SN-S-Series-220, SN-S-Series-320 and SNi10 models on a 19" cabinet shelf

In this non-standard installation, allow a height of more than 1U due to the thickness of the shelf, the presence of rubber feet below the appliance as well as antennae on Wi-Fi products. The procedure is as follows:

- 1 Using screws and caged nuts (not provided with the appliance), fasten the shelf to the vertical rails located at the front of the cabinet.
- 2 Once the shelf has been installed, you can place one or two appliances on it (no additional fastening is needed).

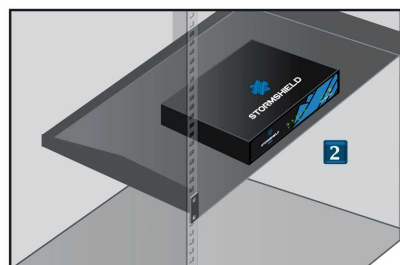
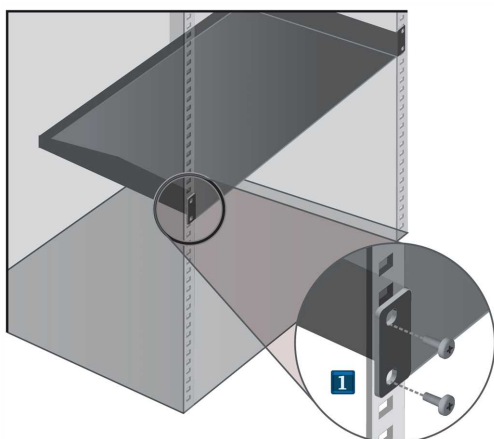

### ! WARNING

If you are installing two firewalls on the same rack mount shelf, you will need to leave enough space between the firewalls to avoid obstructing the flow of air from the sides.





## Installing SN210, SN210W, SN310, SN-XS-Series-170, SN-S-Series-220, SN-S-Series-320 and SNi10 models on a 19" cabinet 1U shelf

The minimum vertical space needed for installing the shelf is 1U. In this configuration, the shelf makes it possible to **install one or two products**. There are indentations to ensure that products and power adapters are held securely in place.

### ! WARNING

Before any installation, ensure that you have removed the four non-slip rubber feet under each product.

### i NOTE

Fasteners for two power adapters are provided with the shelf.

- 1 Place your firewall in front of its slot at the front of the shelf, then set it upright until it is firmly in place.
- 2 Install and fasten the power adapter on the shelf. Connect it to the firewall.
- 3 Using screws and caged nuts (not provided with the appliance), fasten the shelf to the vertical rails located at the front of the cabinet.

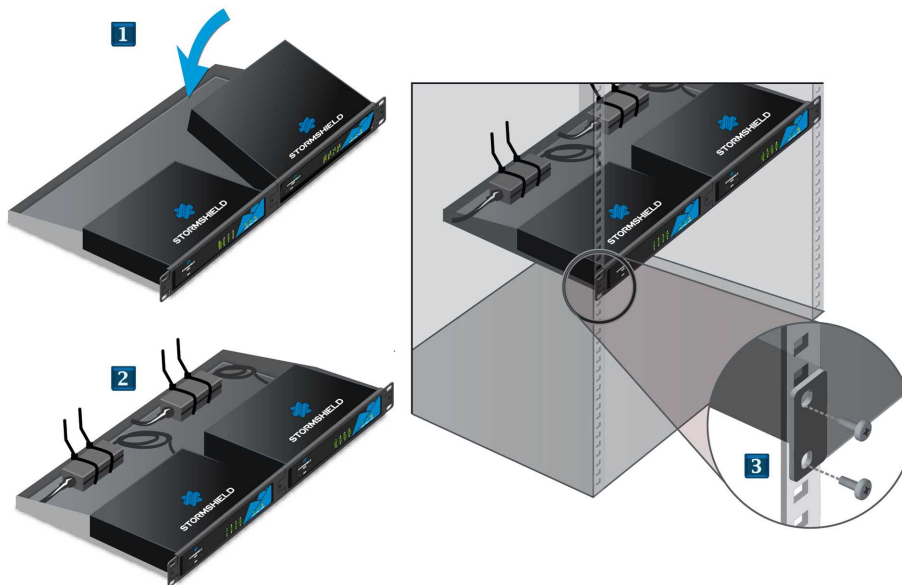

## Kit for USB and network interfaces on the front panel option (not available on SN-XS-Series-170 and SNi10 models)

In this configuration, the shelf makes it possible to **install one product**. There are indentations to ensure that product and power adapter are held securely in place.

### i NOTE

This kit must be ordered separately.

**i NOTE**

This kit allows you to connect the console, via a USB port, and network interfaces on the front panel of the shelf [cables provided].

- 1** Place your firewall in front of its slot at the front left of the shelf, then set it upright until it is firmly in place.
- 2** Unscrew the right side of the front panel (two screws).
- 3** Position the kit, then fasten it to the front panel with both screws.
- 4** Install and fasten the power adapter on the shelf. Connect the power adapter to the firewall, as well as the USB and network ports from the kit.
- 5** Using screws and caged nuts (not provided with the appliance), fasten the shelf to the vertical rails located at the front of the cabinet.

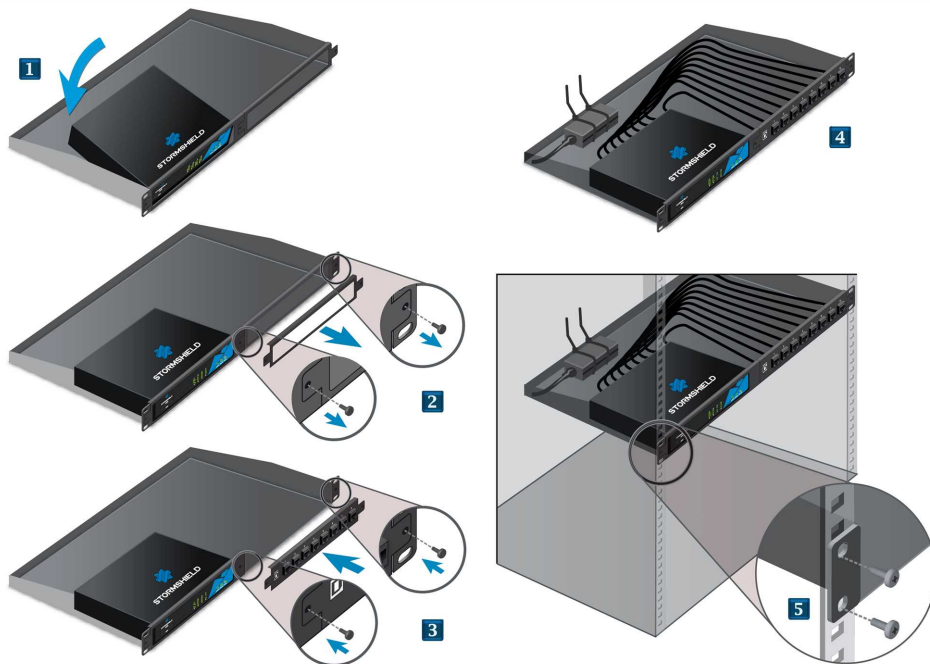



## Fastening SN160, SN160W, SN-XS-Series-170 and SNI10 models to a wall

SN160, SN160W, SN-XS-Series-170 and SNI10 models can also be installed vertically using screws and fasteners (not provided). The screw heads must be narrower than 8mm in diameter and the diameter of the shank must not exceed 4mm.

The procedure is as follows:

- 1** Place against the wall the 2 screws aligned horizontally, leaving a space of 12cm (center to center) between them and letting them protrude slightly to take into account the thickness of the non-slip rubber feet.
- 2** Once the screws have been drilled into the wall, you can insert the screw heads into the indentations meant for this purpose, then gently bring the appliance downwards in order to insert the screws.

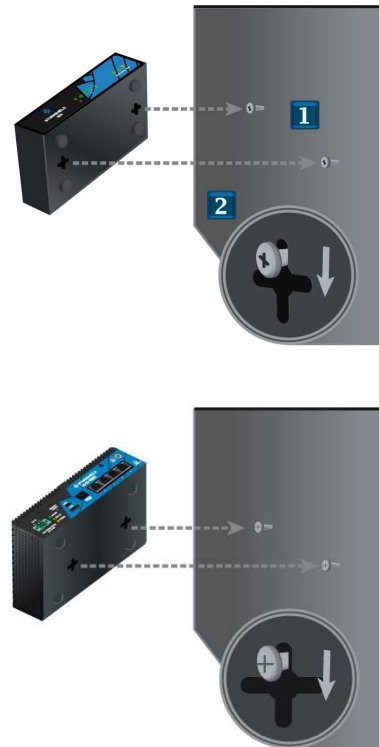

## Installing SN510, SN-M-Series-520, SN710, SN910, SN-M-Series-720 and SN-M-Series-920 models in a 19" cabinet

The minimum vertical space needed for installing an SNS firewall is 1U.

Once the brackets have been installed, you can fasten the firewall to the vertical rails located at the front of your cabinet using screws and the caged nuts (not provided with the appliance).

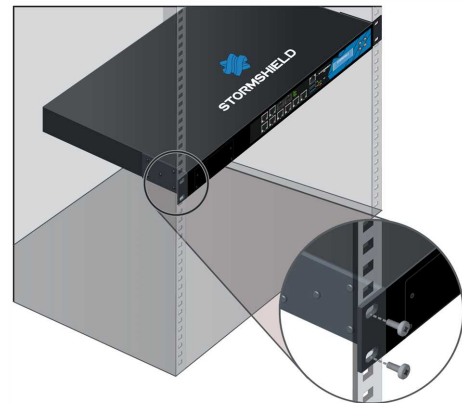

## Installing SN1100, SN2100, SN3100, SN-L-Series-2200, SN-L-Series-3200, SN6100, SN-XL-Series-5200 and SN-XL-Series-6200 model in a 19" cabinet

The minimum vertical space needed to install an SN1100, SN2100, SN3100, SN-L-Series-2200 or SN-L-Series-3200 model is 1U, and 2U for an SN6100, SN-XL-Series-5200 or SN-XL-Series-6200. The processes of mounting lateral rails and installing appliances in racks are described in [SN1100 rack mounting](#), [SN2100-SN3100 rack mounting](#), [SN-L-Series rack mounting](#), [SN6100](#)



[rack mounting](#) and [SN-XL-Series rack mounting](#). These documents are delivered with SN1100, SN2100, SN3100, SN-L-Series-2200, SN-L-Series-3200, SN6100, SN-XL-Series-5200 and SN-XL-Series-6200 models.

The rails that come with the product make it possible to install firewalls in a 19" rack. The depth between the vertical rails located in the front and back are:

- [SN1100](#): between 655 and 745mm,
- [SN2100/SN3100](#): between 735 and 850mm,
- [SN6100](#): between 620 and 808mm,
- [SN-L-Series-2200/SN-L-Series-3200](#): between 635 and 920mm,
- [SN-XL-Series-5200/SN-XL-Series-6200](#): between 715 and 810mm.

## Installing SN-XS-Series-170, SNi10, SNi20 and SNi40 models on DIN rails

To install the appliance in a cabinet, SN-XS-Series-170, SNi10, SNi20 and SNi40 models have a fastener on a 35mm-wide DIN rail (EN50022 standard).

### ! REMINDER

Ensure that the cabinet complies with temperature and humidity conditions indicated in the section [Conditions of use](#). Equipment has to be installed by a qualified electrician.

### i NOTE

SNi20 and SNi40 models must be installed vertically.

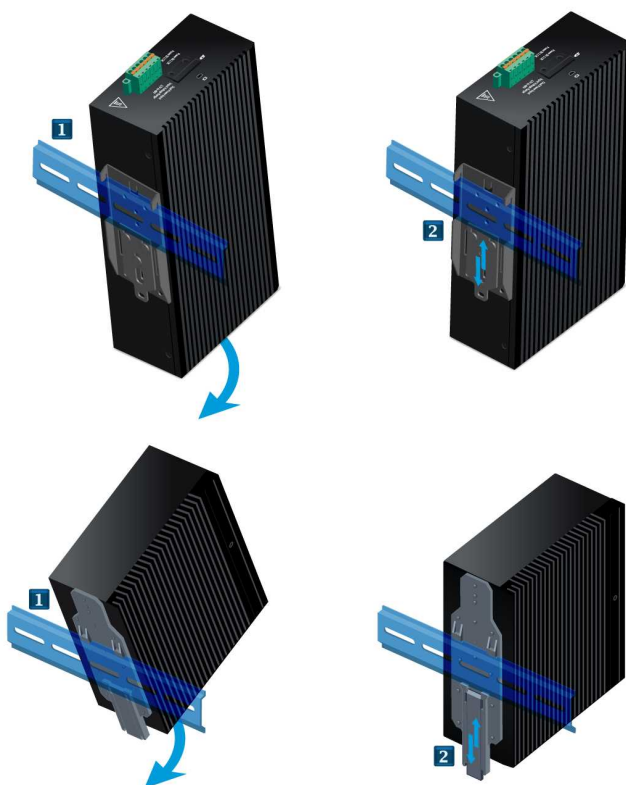

The procedure is as follows:

- 1** Hold the appliance facing the DIN rail, then insert the upper part of the rail into the notch in the fastener. Set the appliance upright.
- 2** Push the appliance against the DIN rail until you hear a click. Ensure that the position of the appliance has been locked.



## Presentation of the SNS range

Stormshield Network Security firewalls in the SNS range rely on the most advanced technologies to provide high performance and optimum protection.

### **i** NOTE

For more information on Ethernet interfaces, refer to the section [Connecting to the network](#) under *Installation precautions*.

### SN160 and SN160W models

SN160 and SN160W firewalls are fanless. The products come with an external power adapter.

#### Front panel: LEDs

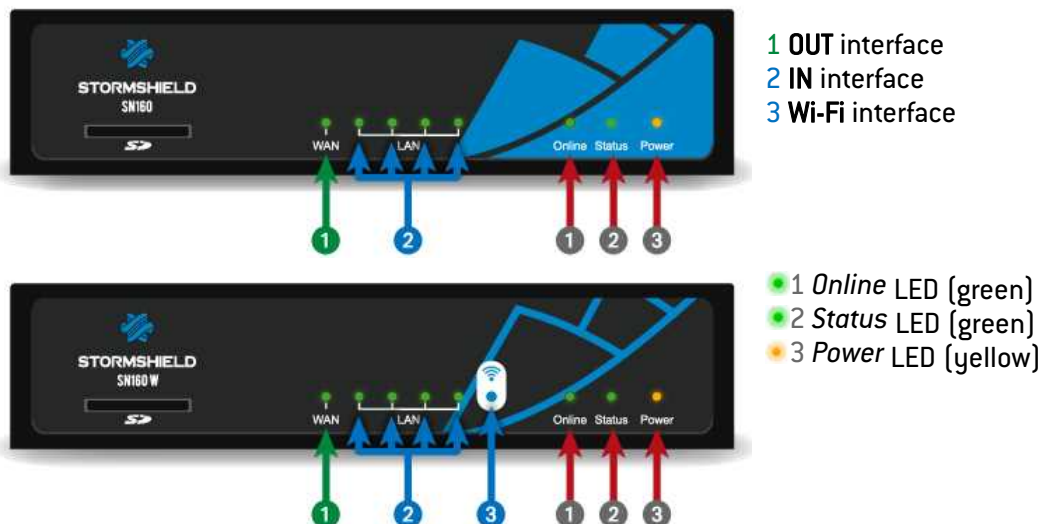

#### Connectors

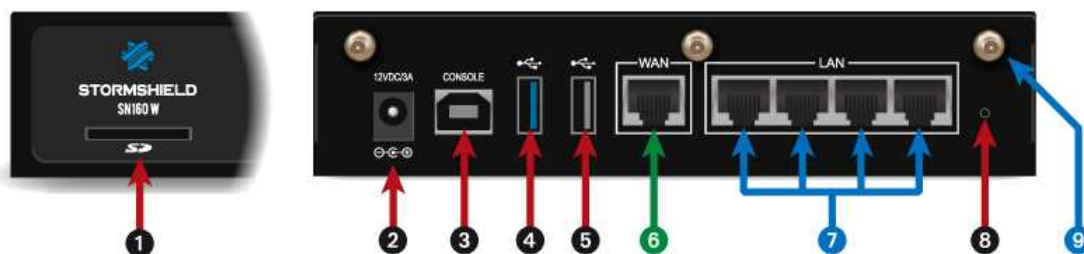

The connectors on SN160 and SN160W models are located on the front and rear panels.

- 1 This is the slot for the **SD card\***.
- 2 Plugging in the mains adapter automatically starts this product.
- 3 The **USB port** makes it possible to access the product in console mode\*\*; the user can connect to the firewall directly from a computer. The default baud rate on these models is 115200 baud (8N1).
- 4 The **USB 3.0 port** can be used for secure configurations or upgrades. You can also plug a USB key or an approved USB modem into it.



- 5 The **USB 2.0 port** can be used for secure configurations or upgrades. You can also plug a USB key or an approved USB modem into it.  
SN160 and SN160W models hold five 1Gbe ports:
- 6 The first zone is the **EXTERNAL (OUT)** interface, in external mode by default. It makes up the zone that is needed for connecting to the internet.
- 7 The second zone is identified by default in **INTERNAL (IN)** mode. It is made up of 4 switched ports.
- 8 This is the button for **resetting the appliance** to its factory settings (*defaultconfig*).
- 9 **Sockets** for Wi-Fi antennae.

\* The recommended type of SD card is at least **Class 10 (C10) UHS Class 1 (U1) or App Performance 2 (A2)**. The memory card must be in a full-size physical SD format, in **SDHC or SDXC standard**. Only adapters provided with the card must be used. The maximum memory size supported is 2 TB. Stormshield recommends the use of **high-endurance/industrial** cards or preferably, those that have a built-in **MLC** flash chip developed by major brands (e.g., SanDisk, Western Digital, Innodisk, Transcend, etc.) and with at least 32 GB.

\* This connection in console mode requires the installation of a third party driver. Depending on your operating system, you can download a driver from:

[https://www.prolific.com.tw/US/ShowProduct.aspx?p\\_id=225&pcid=41](https://www.prolific.com.tw/US/ShowProduct.aspx?p_id=225&pcid=41)

## SN210 and SN210W models

SN210 and SN210W firewalls are fanless. The products come with an external power adapter.

### Front panel: LEDs

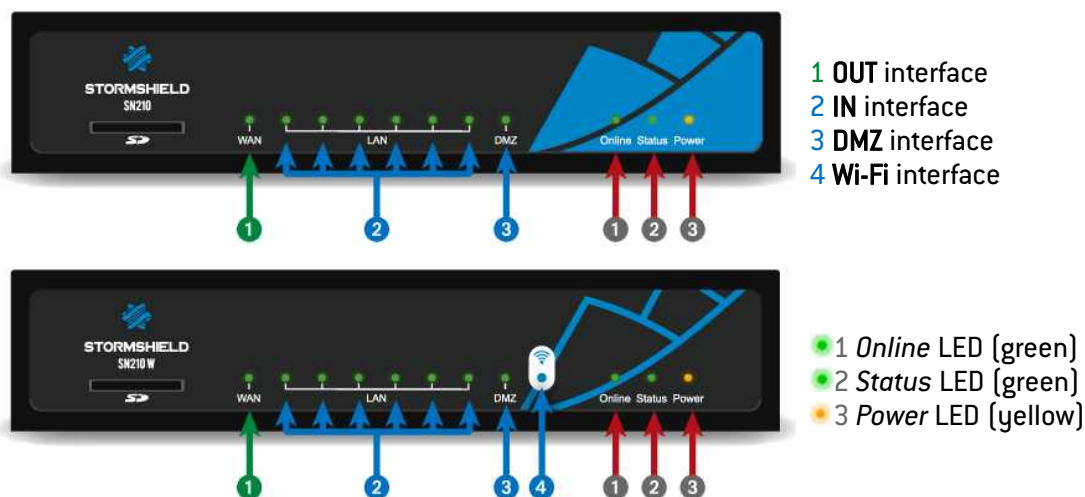

### Connectors

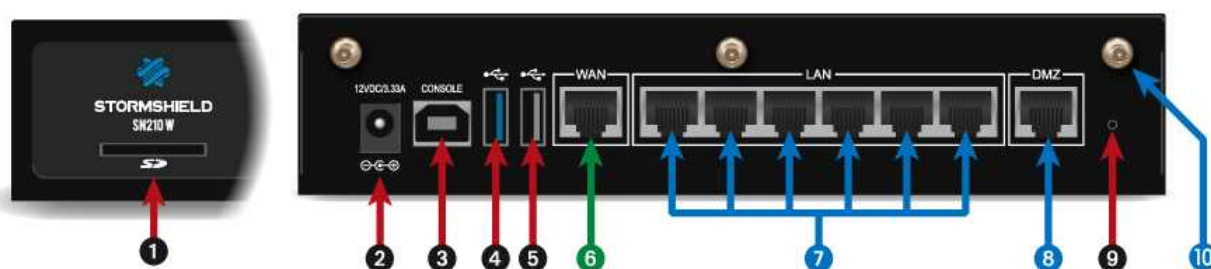





The connectors on SN210 and SN210W models are located on the front and rear panels.

- 1 This is the slot for the **SD card\***.
- 2 Plugging in the mains adapter automatically starts this product.
- 3 The **USB port** makes it possible to access the product in console mode\*\*; the user can connect to the firewall directly from a computer. The default baud rate on these models is 115200 baud (8N1).
- 4 The **USB 3.0 port** can be used for secure configurations or upgrades. You can also plug a USB key or an approved USB modem into it.
- 5 The **USB 2.0 port** can be used for secure configurations or upgrades. You can also plug a USB key or an approved USB modem into it.

SN210 and SN210W models hold eight 1GbE ports:

- 6 The first zone is the **EXTERNAL (OUT)** interface, in external mode by default. It makes up the zone that is needed for connecting to the internet.
- 7 The second zone is identified by default in **INTERNAL (IN)** mode. It is made up of 6 switched ports.
- 8 The third zone is identified by default in **INTERNAL (DMZ)** mode.
- 9 This is the button for **resetting the appliance** to its factory settings (*defaultconfig*).
- 10 **Sockets** for Wi-Fi antennae.

*\* The recommended type of SD card is at least **Class 10 (C10) UHS Class 1 (U1) or App Performance 2 (A2)**. The memory card must be in a full-size physical SD format, in **SDHC or SDXC standard**. Only adapters provided with the card must be used. The maximum memory size supported is 2 TB. Stormshield recommends the use of **high-endurance/industrial** cards or preferably, those that have a built-in **MLC** flash chip developed by major brands (e.g., SanDisk, Western Digital, Innodisk, Transcend, etc.) and with at least 32 GB.*

*\* This connection in console mode requires the installation of a third party driver. Depending on your operating system, you can download a driver from:*

[https://www.prolific.com.tw/US/ShowProduct.aspx?p\\_id=225&pcid=41](https://www.prolific.com.tw/US/ShowProduct.aspx?p_id=225&pcid=41)

## SN310 model

The SN310 firewall is fanless. The product comes with an external power adapter.

### Front panel: LEDs

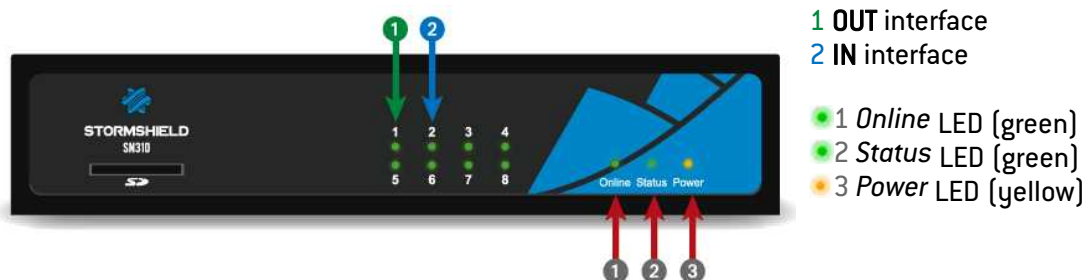





## Connectors

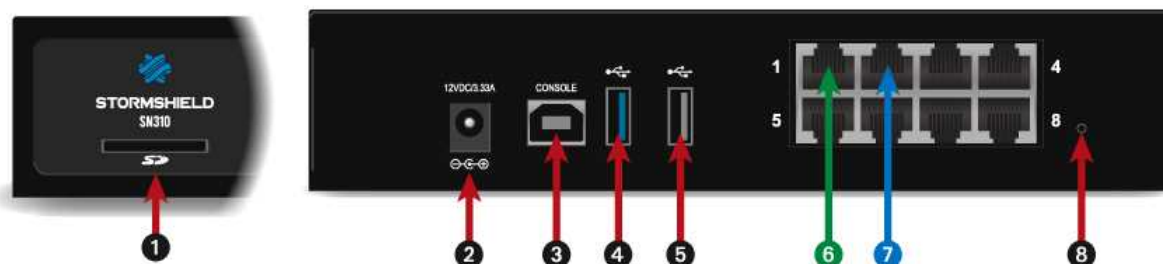

The connectors on the SN310 model are located on the front and rear panels.

- 1 This is the slot for the **SD card\***.
- 2 Plugging in the mains adapter automatically starts this product.
- 3 **The USB port** makes it possible to access the product in console mode\*; the user can connect to the firewall directly from a computer. The default baud rate on these models is 115200 baud (8N1).
- 4 **The USB 3.0 port** can be used for secure configurations or upgrades. You can also plug a USB key or an approved USB modem into it.
- 5 **The USB 2.0 port** can be used for secure configurations or upgrades. You can also plug a USB key or an approved USB modem into it.

The SN310 model offers 8 1Gbe Ethernet ports:

- 6 The first zone is the **EXTERNAL (OUT)** interface, in external mode by default. It makes up the zone that is needed for connecting to the internet.
- 7 The second zone is the **INTERNAL (IN)** interface.
- 8 This is the button for **resetting the appliance** to its factory settings (*defaultconfig*).

*\* The recommended type of SD card is at least **Class 10 (C10) UHS Class 1 (U1) or App Performance 2 (A2)**. The memory card must be in a full-size physical SD format, in **SDHC or SDXC standard**. Only adapters provided with the card must be used. The maximum memory size supported is **2 TB**. Stormshield recommends the use of **high-endurance/industrial** cards or preferably, those that have a built-in **MLC** flash chip developed by major brands (e.g., SanDisk, Western Digital, Innodisk, Transcend, etc.) and with at least 32 GB.*

*\* This connection in console mode requires the installation of a third party driver. Depending on your operating system, you can download a driver from:*

[https://www.prolific.com.tw/US/ShowProduct.aspx?p\\_id=225&pcid=41](https://www.prolific.com.tw/US/ShowProduct.aspx?p_id=225&pcid=41)

## SN-XS-Series-170 and SNi10 models

Depending on the license, the SN-XS-Series platform (physical appliance) may either be an SN-XS-Series-170 or SNi10 model.

Temporary licenses correspond to the SN-XS-Series-170 model by default. A license must be installed in order to change to an SNi10 model. For further information on updating licenses, refer to the module [Updating the license](#).

The SN-XS-Series firewall is fanless. The product comes with an external power adapter. SN-XS-Series firewalls can also use another power supply - a 2-pole threaded connector is provided for this purpose. The SN-XS-Series model holds 4 2.5Gbe Ethernet interfaces.



## Front panel: connectors and LEDs

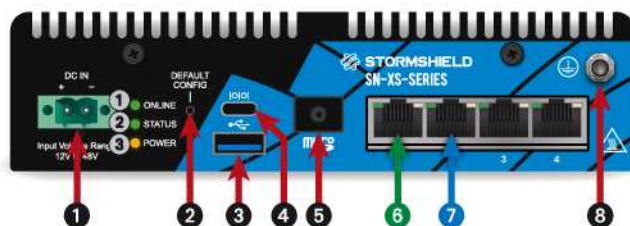

- 1 Online LED (green)
- 2 Status LED (green)
- 3 Power LED (yellow)

- 1 A 2-pole threaded connector makes it possible to connect to a 24VDC power supply.
- 2 This is the button for **resetting the appliance** to its factory settings (*defaultconfig*).
- 3 **The USB 3.0 port** can be used for secure configurations or upgrades. You can also plug a USB key or an approved USB modem into it.
- 4 The **USB-C port** makes it possible to access the product in console mode\*; the user can connect to the firewall directly from a computer. The default baud rate on this model is 115200 baud (8N1).
- 5 This is the slot for the **microSD card\*\***.
- 6 The first zone is the **EXTERNAL (OUT)** interface, in external mode by default. It makes up the zone that is needed for connecting to the internet.
- 7 The second zone is the **INTERNAL (IN)** interface.
- 8 Connection of the **protective earth circuit**.

\* This connection in console mode requires the installation of a third party driver. Depending on your operating system, you can download a driver from:

[https://www.prolific.com.tw/US/ShowProduct.aspx?p\\_id=225&pcid=41](https://www.prolific.com.tw/US/ShowProduct.aspx?p_id=225&pcid=41)

\*\* The recommended type of micro SD card is at least **Class 10 (C10) UHS Class 1 (U1) or App Performance 2 (A2)**. The memory card must be in **SDHC or SDXC standard**. Only adapters provided with the card must be used. The maximum memory size supported is 2 TB.

Stormshield recommends the use of **high-endurance/industrial** cards or preferably, those that have a built-in **MLC** flash chip developed by major brands (e.g., SanDisk, Western Digital, Innodisk, Transcend, etc.) and with at least 32 GB.

## SN-S-Series-220 and SN-S-Series-320 models

Depending on the license, the SN-S-Series platform (physical appliance) may either be an SN-S-Series-220 or SN-S-Series-320 model.

Temporary licenses correspond to the SN-S-Series-220 model by default. A license must be installed in order to upgrade to an SN-S-Series-320 model. For further information on upgrading licenses, refer to the section [Updating the license](#).

The SN-S-Series firewall is fanless. The product comes with an external power adapter.



## Front panel: LEDs

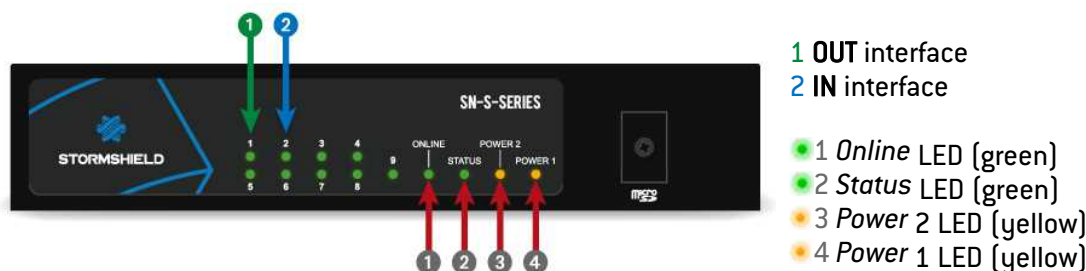

## Connectors

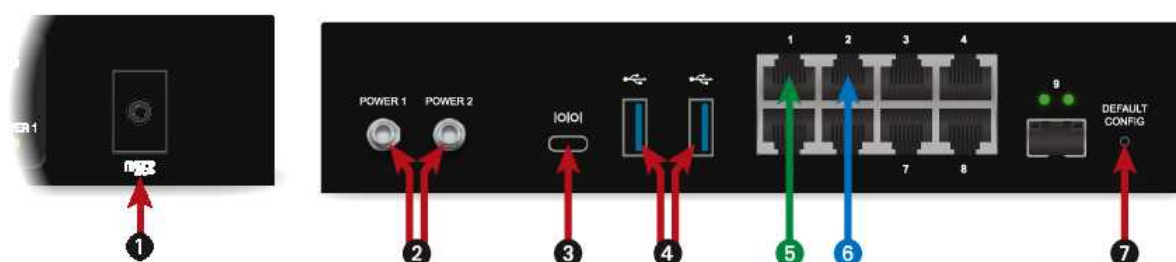

The connectors on the SN-S-Series model are located on the front and rear panels.

- 1 This is the slot for the **SD card\***.
- 2 **Two mains sockets** to be screwed in for redundant power supplies. Plugging in a mains adapter automatically starts this product.
- 3 **The USB-C port** makes it possible to access the product in console mode\*\*; the user can connect to the firewall directly from a computer. The default baud rate on this model is 115200 baud (8N1).
- 4 **Two USB 3.0 ports** that can be used for secure configurations or upgrades. You may also plug in a USB key, USB keyboard or approved USB modem.

The SN-S-Series model holds 8 Gigabit Ethernet interfaces.

- 5 The first zone is the **EXTERNAL (OUT)** interface, in external mode by default. It makes up the zone that is needed for connecting to the internet.
- 6 The second zone is the **INTERNAL (IN)** interface.
- 7 This is the button for **resetting the appliance** to its factory settings (*defaultconfig*).

*\* The recommended type of micro SD card is at least **Class 10 (C10) UHS Class 1 (U1) or App Performance 2 (A2)**. The memory card must be in **SDHC or SDXC standard**. Only adapters provided with the card must be used. The maximum memory size supported is 2 TB.*

*Stormshield recommends the use of **high-endurance/industrial** cards or preferably, those that have a built-in **MLC** flash chip developed by major brands (e.g., SanDisk, Western Digital, Innodisk, Transcend, etc.) and with at least 32 GB.*

*\* This connection in console mode requires the installation of a third party driver. Depending on your operating system, you can download a driver from:*

*[https://www.prolific.com.tw/US/ShowProduct.aspx?p\\_id=225&pcid=41](https://www.prolific.com.tw/US/ShowProduct.aspx?p_id=225&pcid=41)*



## SN510 and SN710 models

### Front panel: connectors and LEDs

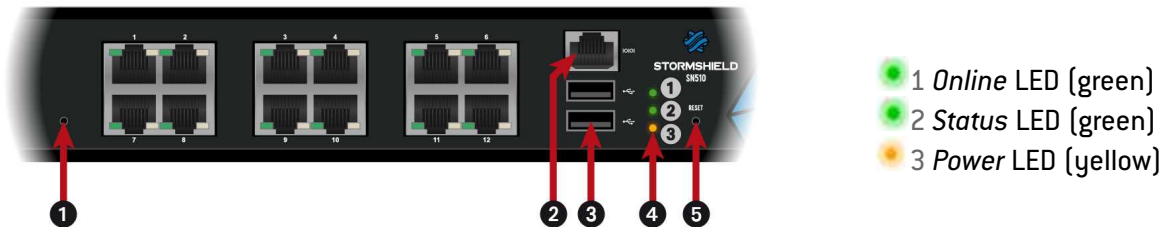

- 1 This is the button for **resetting the appliance** to its factory settings (*defaultconfig*).
- 2 **The serial port** enables access to the product in console mode; the user can connect to the firewall directly from a computer. The default baud rate on these models is 115200 baud (8N1).
- 3 **Two USB 2.0 ports** that can be used for secure configurations or upgrades. You can also plug a USB key or an approved USB modem into it.
- 4 The *Power*, *Status* and *Online* (from bottom to top) LEDs.
- 5 **The Reset button:** electrically resets the firewall.

### SN510 model



This product has an internal power supply.  
The SN510 model offers 12 1Gbe ports:

- 1 **OUT** interface
- 2 **IN** interface

### SN710 model

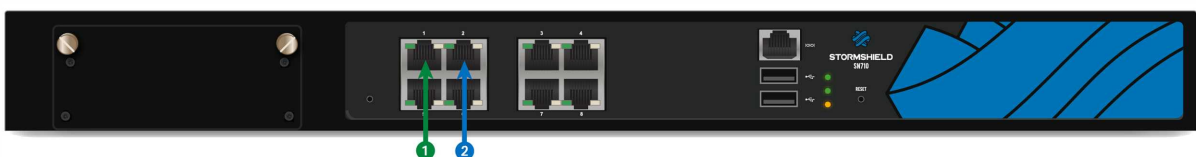

This product has an internal power supply.  
The SN710 model offers 8 1Gbe ports: It allows the addition of one extension module with RJ45 (1Gbps) or fiber (1Gbps or 10Gbps) connectors.

- 1 **OUT** interface
- 2 **IN** interface

Specifications of Stormshield Network-approved extension modules and transceivers are set out in sections [Extension modules \(SN710 and upwards\)](#) and [Fiber Ethernet connectors](#).

### Rear panel: connectors

The socket for the power cord is located on the rear panel of the product. A switch makes it possible to turn the product on or off.



## SN-M-Series-520 models

It has two internal power supply units to provide a redundant power supply.

### Front panel: connectors and LEDs

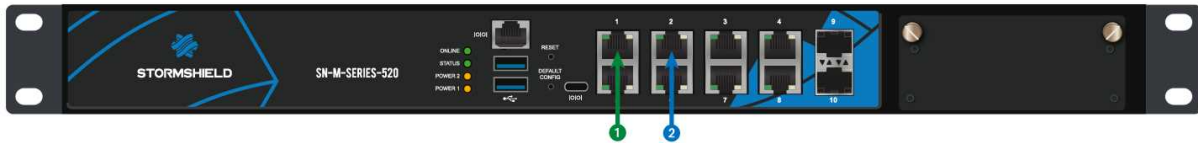

1 OUT interface

2 IN interface

The SN-M-Series platform holds 8 2.5Gbe Ethernet interfaces by default (10Mbe, 100Mbe, 1Gbe and 2.5Gbe) and 2 SFP sockets for adding 1Gbe transceivers. On this model, 1 extension module can be added with RJ45 (1Gbps, 2.5Gbps or 10Gbps) or fiber (1Gbps, 10Gbps or 25Gbps) connectors.

Specifications of Stormshield Network-approved extension modules and transceivers are set out in sections [Extension modules \(SN710 and upwards\)](#) and [Fiber Ethernet connectors](#).

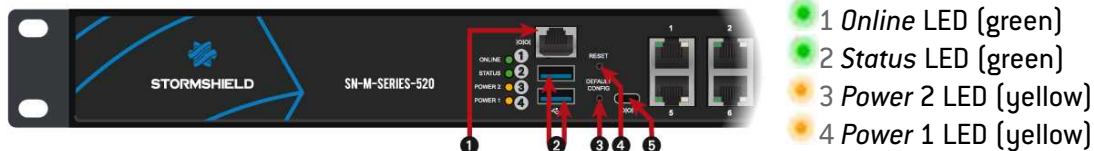

- 1 The **serial port** enables access to the product in console mode; the user can connect to the firewall directly from a computer. The default baud rate on this model is 115200 baud (8N1).
- 2 **Two USB 3.0 ports** that can be used for secure configurations or upgrades. You may also plug in a USB key, USB keyboard or approved USB modem.
- 3 This is the button for **resetting the appliance** to its factory settings (*defaultconfig*).
- 4 The **Reset button**: electrically resets the firewall.
- 5 The **USB-C port** makes it possible to access the product in console mode\*; the user can connect to the firewall directly from a computer. The default baud rate on this model is 115200 baud (8N1).

\* This connection in console mode requires the installation of a third party driver. Depending on your operating system, you can download a driver from:

[https://www.prolific.com.tw/US/ShowProduct.aspx?p\\_id=225&pcid=41](https://www.prolific.com.tw/US/ShowProduct.aspx?p_id=225&pcid=41)

### Rear panel: connectors



- 1 Connection of the **protective earth circuit**.
- 2 **Two Power buttons** to switch the firewall on or off.
- 3 **Two mains sockets** for redundant power supplies.

## SN910 model

This product has an internal power supply.





## Front panel: connectors and LEDs

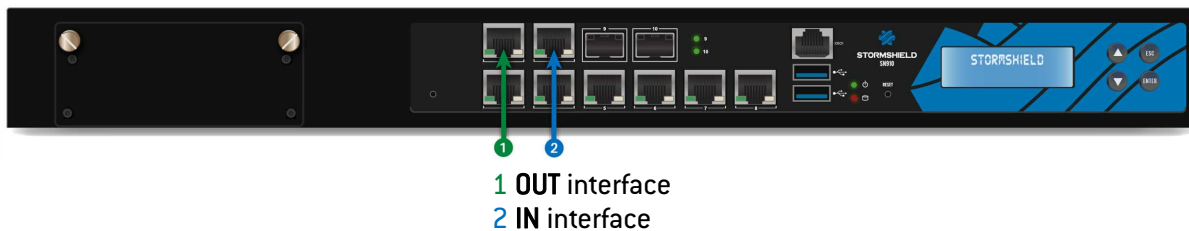

The SN910 model holds 8 1Gbe Ethernet interfaces and 2 SFP sockets for adding 1Gbe Ethernet transceivers. It allows the addition of one extension module with RJ45 (1Gbps) or fiber (1Gbps or 10Gbps) connectors.

Specifications of Stormshield Network-approved extension modules and transceivers are set out in sections [Extension modules \(SN710 and upwards\)](#) and [Fiber Ethernet connectors](#).

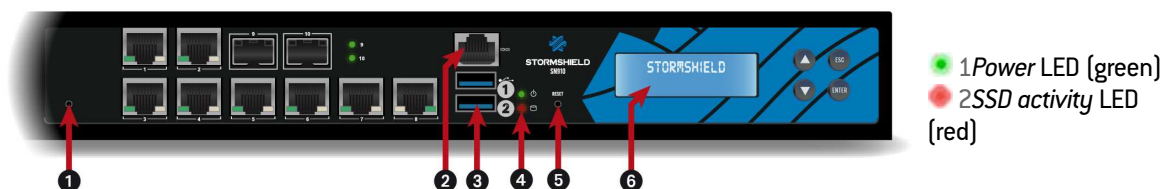

- 1 This is the button for **resetting the appliance** to its factory settings (*defaultconfig*).
- 2 **The serial port** enables access to the product in console mode; the user can connect to the firewall directly from a computer. The default baud rate on these models is 9600 baud (8N1).
- 3 **Two USB 3.0 ports** that can be used for secure configurations or upgrades. You may also plug in a USB key, USB keyboard or approved USB modem.
- 4 The *Power* and *SSD activity* LEDs (from top to bottom).
- 5 **The Reset button**: electrically resets the Firewall.
- 6 **LCD screen**: indicates the version of the firmware installed, the active partition, the serial number of the product as well as the HA status if it has been enabled.

## Rear panel: connectors



- 1 The mains socket.
- 2 The product's on/off switch.
- 3 **The USB 2.0 port** can be used for secure configurations or upgrades. You may also plug in a USB key, USB keyboard or approved USB modem.
- 4 **The VGA port** makes it possible to connect a monitor.

## SN-M-Series-720 and SN-M-Series-920 models

Depending on the license, the SN-M-Series platform (physical appliance) may either be an SN-M-Series-720 or SN-M-Series-920 model.

Temporary licenses correspond to the SN-M-Series-720 model by default. A license must be installed in order to upgrade to an SN-M-Series-920 model. For further information on updating licenses, refer to the module [Updating the license](#).



It has two internal power supply units to provide a redundant power supply.

## Front panel: connectors and LEDs

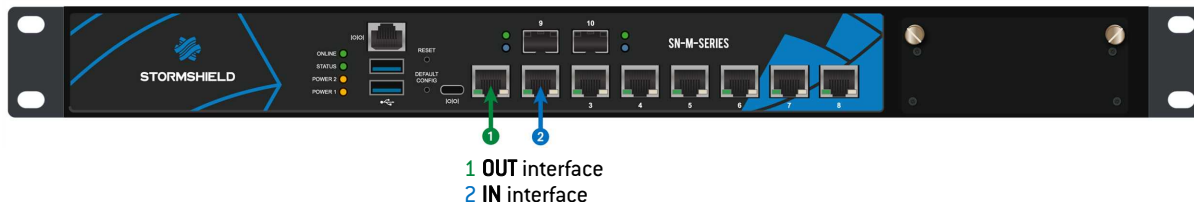

The SN-M-Series platform holds 8 2.5Gbe interfaces by default (backward compatible between 100Mbe/1Gbe) and 2 SFP+ sockets for adding 1Gbe/10Gbe transceivers. On this model, 1 extension module can be added with RJ45 (1Gbps or 10Gbps) or fiber (1Gbps, 10Gbps or 25Gbps) connectors.

Specifications of Stormshield Network-approved extension modules and transceivers are set out in sections [Extension modules \(SN710 and upwards\)](#) and [Fiber Ethernet connectors](#).

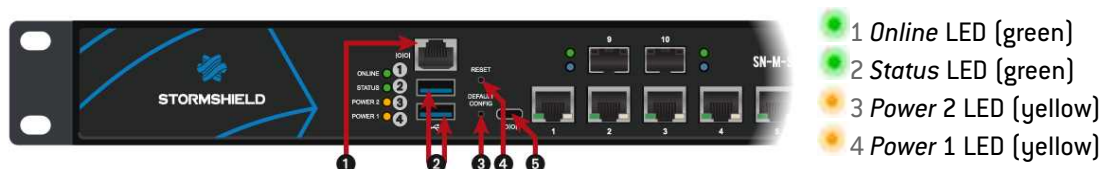

- 1 The **serial port** enables access to the product in console mode; the user can connect to the firewall directly from a computer. The default baud rate on this model is 115200 baud (8N1).
- 2 **Two USB 3.0 ports** that can be used for secure configurations or upgrades. You may also plug in a USB key, USB keyboard or approved USB modem.
- 3 This is the button for **resetting the appliance** to its factory settings (*defaultconfig*).
- 4 The **Reset button**: electrically resets the firewall.
- 5 The **USB-C port** makes it possible to access the product in console mode\*; the user can connect to the firewall directly from a computer. The default baud rate on this model is 115200 baud (8N1).

\* This connection in console mode requires the installation of a third party driver. Depending on your operating system, you can download a driver from:

[https://www.prolific.com.tw/US/ShowProduct.aspx?p\\_id=225&pcid=41](https://www.prolific.com.tw/US/ShowProduct.aspx?p_id=225&pcid=41)

## Rear panel: connectors



- 1 Connection of the **protective earth circuit**.
- 2 **Two Power buttons** to switch the firewall on or off.
- 3 **Two mains sockets** for redundant power supplies.

## SN1100 model

This product has a removable power supply.

A second power supply module can be ordered separately for redundant power supply.





## Front panel: connectors and LEDs



- 1 OUT interface
- 2 IN interface

The SN1100 model holds 8 1Gbe ports by default and 2 SFP+ sockets for adding 1Gbe/10Gbe transceivers. On this model, 2 extension modules can be added with RJ45 (1Gbps, 2.5Gbps or 10Gbps) or fiber (1Gbps, 10Gbps or 25Gbps) connectors.

Specifications of Stormshield Network-approved extension modules and transceivers are set out in sections [Extension modules \(SN710 and upwards\)](#) and [Fiber Ethernet connectors](#).

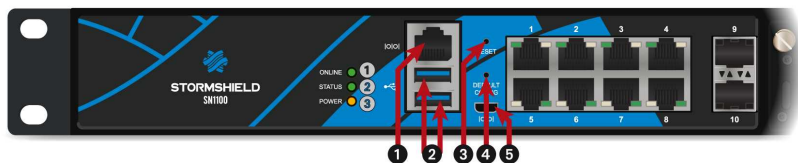

- 1 Online LED (green)
- 2 Status LED (green)
- 3 Power LED (yellow)

- 1 **The serial port** enables access to the product in console mode; the user can connect to the firewall directly from a computer. The default baud rate on this model is 115200 baud [8N1].
- 2 **Two USB 3.0 ports** that can be used for secure configurations or upgrades. You may also plug in a USB key, USB keyboard or approved USB modem.
- 3 **The Reset button:** electrically resets the firewall.
- 4 This is the button for **resetting the appliance** to its factory settings (*defaultconfig*).
- 5 **The USB port** allows accessing the appliance in console mode\*; it is possible to log on to the Firewall directly using a computer. The default baud rate on this model is 115200 baud [8N1].

\* This connection in console mode requires the installation of a third party driver. Depending on your operating system, you can download a driver from: <http://www.ftdichip.com/Drivers/VCP.htm>

## Rear panel: connectors



- 1 **The HDMI port** makes it possible to connect a monitor.
- 2 **The USB 3.0 port** can be used for secure configurations or upgrades. You may also plug in a USB key, USB keyboard or approved USB modem.
- 3 The **power button** makes it possible to switch the firewall on or off.
- 4 The **mains socket**. Modules are hot-swappable on products with a redundant power supply.
- 5 The **Alarm off button**. The alarm rings when a power supply module is missing or when there is a power failure on either module. Press this button to deactivate the alarm.
- 6 Connection of the **protective earth circuit**.



## SN2100 and SN3100 models

### Front panel: connectors and LEDs

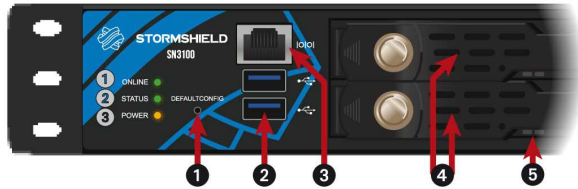

- 1 Online LED (green)
- 2 Status LED (green)
- 3 Power LED (yellow)

- 1 This is the button for **resetting the appliance** to its factory settings (*defaultconfig*).
- 2 **Two USB 3.0 ports** that can be used for secure configurations or upgrades. You may also plug in a USB key, USB keyboard or approved USB modem.
- 3 **The serial port** enables access to the product in console mode; the user can connect to the firewall directly from a computer. The default baud rate on these models is 115 200 baud (8N1).
- 4 **SSD racks** for log storage (1 SSD by default on SN2100 models, RAID available as an option, 2 in RAID 1 on SN3100 models). Disks are hot-swappable on products in a RAID setup.
- 5 The **LEDs on SSD racks** confirm whether the SSD has been accessed (blue LED on the right) and installed (green LED on the left).

### SN2100 model

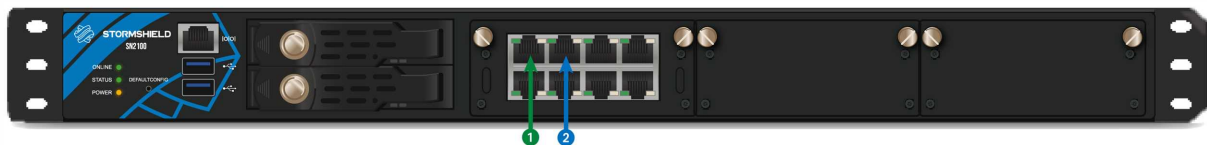

This product has an internal removable power supply and is equipped with an SSD.

A second power supply module can be ordered separately for redundant power supply. You can also order a second SSD for a RAID installation.

The SN2100 model offers 2 1Gbe Ethernet interfaces and allows the addition of 3 extension modules with RJ45 (1Gbps, 2.5Gbps or 10Gbps) or fiber (1Gbps, 10Gbps, 25Gbps or 40Gbps) connectors.

#### **i** NOTE

For this model, network extension modules are sold separately and must be ordered.

Specifications of Stormshield Network-approved extension modules and transceivers are set out in sections [Extension modules \(SN710 and upwards\)](#) and [Fiber Ethernet connectors](#).

### SN3100 model

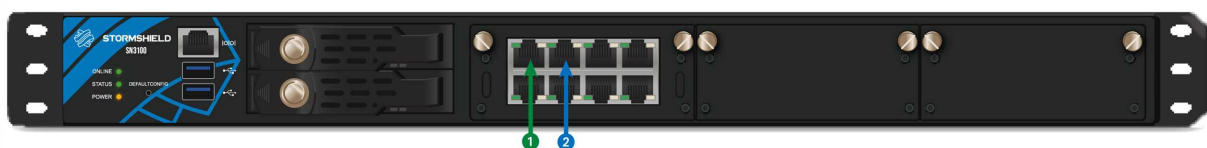

This product has redundant internal power supplies. Two removable SSDs are installed in a RAID configuration.



The SN3100 model offers 2 1Gbe Ethernet interfaces and allows the addition of 3 extension modules with RJ45 (1Gbps, 2.5Gbps or 10Gbps) or fiber (1Gbps, 10Gbps, 25Gbps or 40Gbps) connectors.

**NOTE**

For this model, network extension modules are sold separately and must be ordered.

Specifications of Stormshield Network-approved extension modules and transceivers are set out in sections [Extension modules \(SN710 and upwards\)](#) and [Fiber Ethernet connectors](#).

## Rear panel: connectors

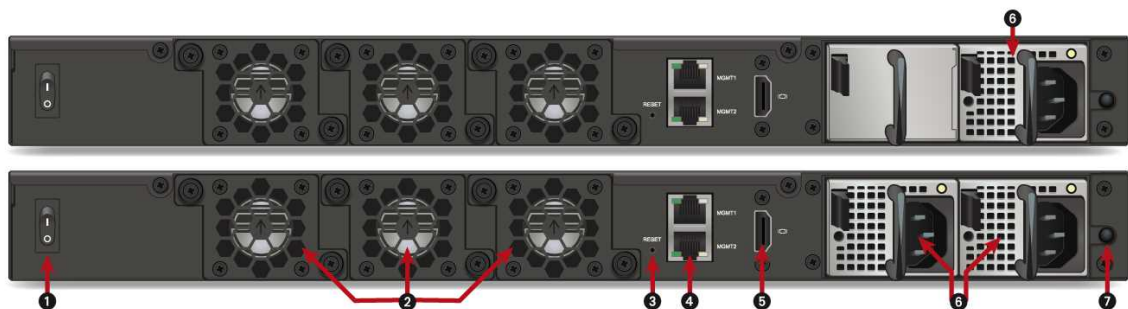

- 1 The **power button** makes it possible to switch the firewall on or off.
- 2 **Three independent hot-swappable fans** in the event of a breakdown.
- 3 **The Reset button**: electrically resets the firewall.
- 4 Two ports dedicated to the management of the appliance (**MGMT1** and **MGMT2**).
- 5 **The HDMI port** makes it possible to connect a monitor.
- 6 A **mains socket** (SN2100) or **two mains sockets** (SN3100) for redundant power supplies. Modules are hot-swappable on products with a redundant power supply.
- 7 The **Alarm off button**. The alarm rings when a power supply module is missing or when there is a power failure on either module. Press this button to deactivate the alarm.

## SN-L-Series-2200 and SN-L-Series-3200 models

Depending on the license, the SN-L-Series platform (physical appliance) may either be an SN-L-Series-2200 or SN-L-Series-3200 model.

Temporary licenses correspond to the SN-L-Series-2200 model by default. A license must be installed in order to upgrade to an SN-L-Series-3200 model. For further information on upgrading licenses, refer to the section [Updating the license](#).

It has two internal power supply units to provide a redundant power supply.

## Front panel: connectors and LEDs

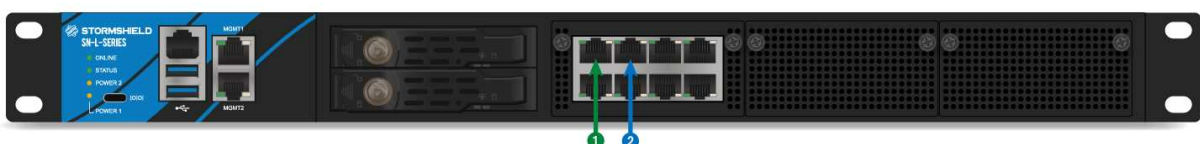

- 1 OUT interface
- 2 IN interface



The SN-L-Series platform holds 2 2.5Gbe Ethernet interfaces by default (backward compatible with 100Mbe/1Gbe interfaces). On this model, 3 extension modules can be added with RJ45 (2.5Gbps or 10Gbps) or fiber (1Gbps, 10Gbps or 40Gbps) connectors.

**i NOTE**

For this model, network extension modules are sold separately and must be ordered.

Specifications of Stormshield Network-approved extension modules and transceivers are set out in sections [Extension modules \(SN710 and upwards\)](#) and [Fiber Ethernet connectors](#).

**i NOTE**

Bandwidth on the following extension modules has been limited to 30Gbps if these modules are placed in slot 1:

- 4 x 10Gbps SFP+,
- 4 x 10Gbps RJ45,
- 2 x 40Gbps QSFP+.

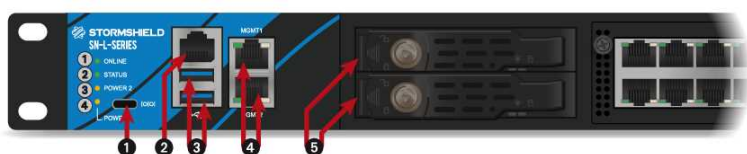

- 1 Online LED (green)
- 2 Status LED (green)
- 3 Power 2 LED (yellow)
- 4 Power 1 LED (yellow)

- 1 The **USB-C port** makes it possible to access the product in console mode\*; the user can connect to the firewall directly from a computer. The default baud rate on this model is 115200 baud (8N1).
- 2 The **serial port** enables access to the product in console mode; the user can connect to the firewall directly from a computer. The default baud rate on this model is 115200 baud (8N1).
- 3 **Two USB 3.0 ports** that can be used for secure configurations or upgrades. You may also plug in a USB key, USB keyboard or approved USB modem.
- 4 Two ports dedicated to the management of the appliance (**MGMT1** and **MGMT2**).
- 5 **SSD racks** for log storage (2 SSD in RAID1 1 and hot-swappable). The LEDs on racks confirm that installation (green LED at the top) and access (yellow LED at the bottom) have been successful.

\* This connection in console mode requires the installation of a third party driver. Depending on your operating system, you can download a driver from:

[https://www.prolific.com.tw/US/ShowProduct.aspx?p\\_id=225&pcid=41](https://www.prolific.com.tw/US/ShowProduct.aspx?p_id=225&pcid=41)

## Rear panel: connectors



- 1 Connection of the **protective earth circuit**.
- 2 The **power button** makes it possible to switch the firewall on or off.
- 3 The **USB 3.0 port** can be used for secure configurations or upgrades. You can also plug a USB key or an approved USB modem into it.
- 4 The **HDMI port** makes it possible to connect a monitor.
- 5 **Two mains sockets** for redundant power supplies. These modules are hot-swappable.



## SN6100 model

### Front panel: connectors and LEDs

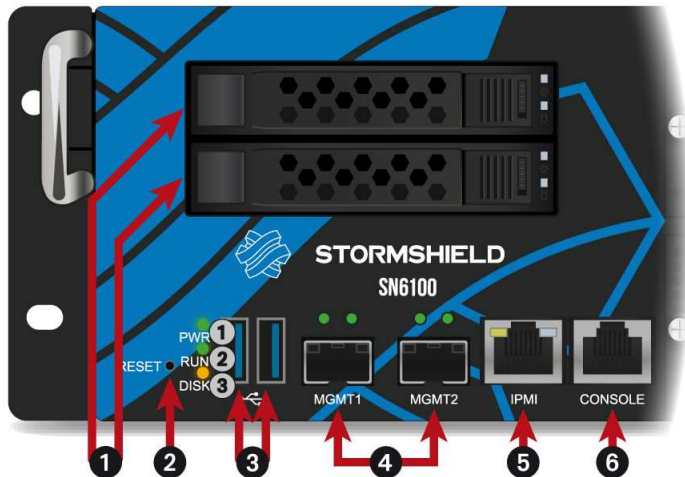

- 1 Power LED (green)
- 2 Run LED (green)
- 3 SSD activity LED (yellow)

- 1 **SSD racks** for log storage (2 SSD in RAID1 1 and hot-swappable). The LEDs on racks confirm that installation (green LED at the top) and access (yellow LED at the bottom) have been successful.
- 2 **The Reset button:** electrically resets the firewall.
- 3 **Two USB 3.0 ports** that can be used for secure configurations or upgrades. You may also plug in a USB key, USB keyboard or approved USB modem.
- 4 **MGMT1 and MGMT2:** two SFP+ sockets, allowing the insertion of SFP+ transceivers, provided as an option. Both of these ports are dedicated to the management of the appliance or the configuration of high availability.
- 5 **The IPMI network port** dedicated to the administration of the appliance via IPMI. Refer to the appendix [Configuration and administration via IPMI](#).
- 6 **The serial port** enables access to the product in console mode; the user can connect to the firewall directly from a computer. The default baud rate on this model is 115 200 baud (8N1).

## SN-XL-Series-5200 or SN-XL-Series-6200 models

Depending on the license, the SN-XL-Series platform (physical appliance) may either be an SN-XL-Series-5200 or SN-XL-Series-6200 model.

Temporary licenses correspond to the SN-XL-Series-5200 model by default. A license must be installed in order to upgrade to an SN-XL-Series-6200 model. For further information on updating licenses, refer to the module [Updating the license](#).

It has two internal power supply units to provide a redundant power supply.

### Front panel: connectors and LEDs







- 1 OUT interface
- 2 IN interface

The SN-XL-Series platform holds 2 2.5Gbe Ethernet interfaces by default (backward compatible with 100Mbe/1Gbe interfaces). On this model, 8 extension modules can be added with RJ45 (2.5Gbps or 10Gbps) or fiber (1Gbps, 10Gbps or 40Gbps) connectors.

### **i** NOTE

For this model, network extension modules are sold separately and must be ordered.

Specifications of Stormshield Network-approved extension modules and transceivers are set out in sections [Extension modules \(SN710 and upwards\)](#) and [Fiber Ethernet connectors](#).



- 1 Online LED (green)
- 2 Status LED (green)
- 3 Power 2 LED (yellow)
- 4 Power 1 LED (yellow)

- 1 **SSD racks** for log storage (2 SSD in RAID1 1 and hot-swappable). The LEDs on racks confirm that installation (green LED at the top) and access (yellow LED at the bottom) have been successful.
- 2 **The USB-C port** makes it possible to access the product in console mode\*; the user can connect to the firewall directly from a computer. The default baud rate on this model is 115200 baud (8N1).
- 3 **The serial port** enables access to the product in console mode; the user can connect to the firewall directly from a computer. The default baud rate on this model is 115200 baud (8N1).
- 4 **Two USB 3.0 ports** that can be used for secure configurations or upgrades. You may also plug in a USB key, USB keyboard or approved USB modem.
- 5 Two ports dedicated to the management of the appliance (**MGMT1** and **MGMT2**).
- 6 The **IPMI network port** dedicated to the administration of the appliance via IPMI. Refer to the appendix [Configuration and administration via IPMI](#).

\* This connection in console mode requires the installation of a third party driver. Depending on your operating system, you can download a driver from:

[https://www.prolific.com.tw/US/ShowProduct.aspx?p\\_id=225&pcid=41](https://www.prolific.com.tw/US/ShowProduct.aspx?p_id=225&pcid=41)

## Rear panel: connectors

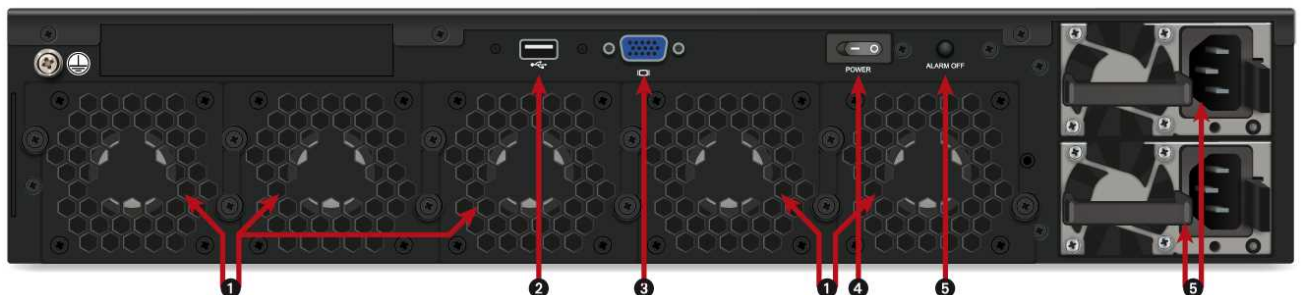

- 1 Connection of the **protective earth circuit**.



- 2 **Five independent hot-swappable fans** in the event of a breakdown.
- 3 **The USB 2.0 port** can be used for secure configurations or upgrades. You may also plug in a USB key, USB keyboard or approved USB modem.
- 4 **The VGA port** makes it possible to connect a monitor.
- 5 The **power button** makes it possible to switch the firewall on or off.
- 6 The **Alarm off button**. The alarm rings when a power supply module is missing or when there is a power failure on either module. Press this button to deactivate the alarm.
- 7 **Two mains sockets** for redundant power supplies. These modules are hot-swappable.

## SNi20 model

In order to ensure service continuity in an industrial setting, the SNi20 firewall is equipped with a hardware bypass function, which when enabled, allows network traffic to pass through in the event of a power outage or appliance breakdown.

This feature, available from version 4.1 onwards, is disabled by default. If you want to allow bypass to be enabled, high availability must not be configured on the appliance.

The SNi20 multi-function firewall is fanless.

This appliance is equipped with a 48VDC redundant power supply; the 6-pole screw terminal connector provided allows connecting to two independent sources of power.

## Connectors and LEDs

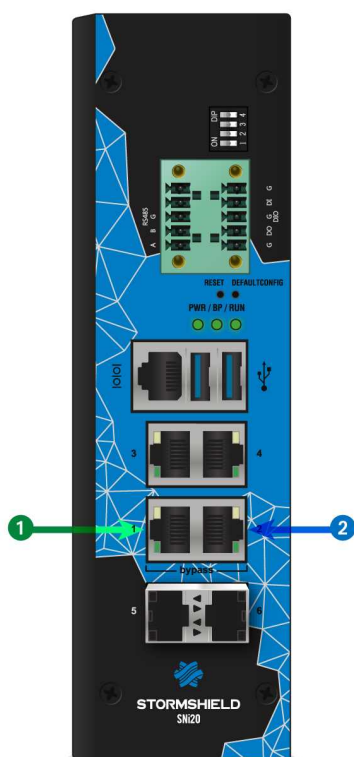

1 **OUT** interface

2 **IN** interface

The SNi20 model holds 4 1Gbe Ethernet interfaces and 2 SFP\* sockets for adding 1Gbe Ethernet transceivers.

Specifications of Stormshield Network-approved transceivers are set out in the sections [Optional Ethernet Transceivers](#) and [Fiber Ethernet connectors](#).

*\* may vary by license.*



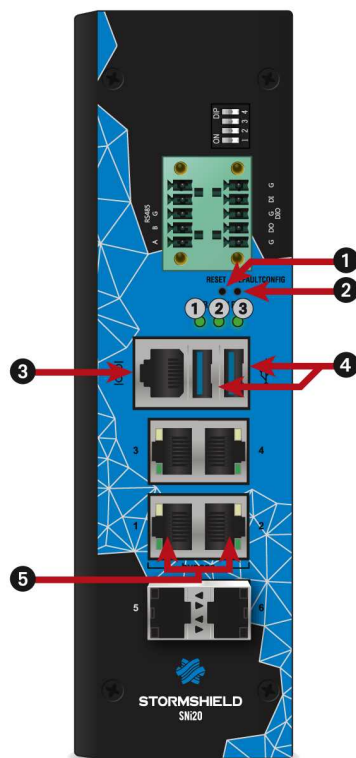

- 1 Power LED (green)
- 2 Bypass LED (off/green/red)
- 3 Run LED (green)
- 4 Power in 1 OK LED (green)
- 5 Power in 2 OK LED (green)

- 1 The **Reset button** (underside): resets the firewall's electrical supply.
- 2 This is the button for **resetting the appliance** to its factory settings (*defaultconfig*).
- 3 The **serial port** enables access to the product in console mode; the user can connect to the firewall directly from a computer. The default baud rate on this model is 115 200 baud (8N1).
- 4 The **USB 3.0 ports** can be used for secure configurations or upgrades. You can also plug a USB key or an approved USB modem into it.
- 5 Two network ports dedicated to **Ethernet Bypass** (may vary by license).

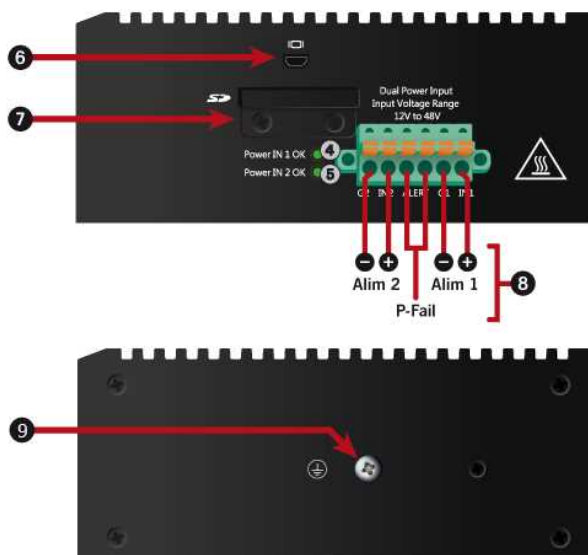

- 6 The **micro HDMI port** makes it possible to connect a monitor.
- 7 This is the slot for the **SD card\***.
- 8 This 6-pole screw terminal connector enables connection to a 48VDC redundant power supply and a **P-Fail relay**.
- 9 Connection of the **protective earth circuit**.

\* The recommended type of SD card is at least **Class 10 (C10) UHS Class 1 (U1) or App Performance 2 (A2)**. The memory card must be in a full-size physical SD format, in **SDHC or SDXC standard**. Only adapters provided with the card must be used. The maximum memory size supported is 2 TB. Stormshield recommends the use of **high-endurance/industrial** cards or preferably, those that have a built-in **MLC** flash chip developed by major brands (e.g., SanDisk, Western Digital, Innodisk, Transcend, etc.) and with at least 32 GB.

### ! IMPORTANT

On SNi20 appliances, use a Phillips PH1 screwdriver to remove the screws from the SD card reader cache. Insert the SD card, then put back the SD card reader cache to guarantee that the SNi20 is airtight.



### Bypass LED

Color	Status	Status
	Off	<i>Bypass</i> feature disabled (default status, <b>Security mode</b> ).
Green	On	<i>Bypass</i> feature configure in <b>Safety mode</b> . The <i>Bypass</i> mechanism will be enabled whenever the appliance breaks down or there is a power outage.
Red	On	<i>Bypass</i> mechanism enabled.

### Redundant power supply and P-Fail (Power Failure) relay

#### ! REMINDER

Before plugging any equipment into a DC power supply module, read the [security rules](#) carefully and follow them.

Both electrical power supplies can be connected to the SNI20 to provide a redundant power source. Connect the power supplies according to the diagram shown in [Connectors and LEDs](#)

A P-Fail relay makes it possible to detect an abnormal status on a power supply. You can connect this relay to a sound or light alarm, such as a buzzer or a LED, equipped with an independent power supply. To do so, connect the external power supply of the alarm to the third and fourth pins. If both power supplies run at the same time, the alarm will be short-circuited. If either power supply is defective, the alarm will go off. The highest intensity that this relay supports is 1A.

### SNI40 model

In order to ensure service continuity in an industrial setting, the SNI40 firewall is equipped with a hardware bypass function, which when enabled, allows network traffic to pass through in the event of a power outage or appliance breakdown.

This feature, available from version 3.0 onwards, is disabled by default. If you want to allow bypass to be enabled, high availability must not be configured on the appliance.

The SNI40 multi-function firewall is fanless.

This appliance is equipped with a 24 VDC redundant power supply; the 6-pole screw terminal connector provided allows connecting to 2 independent sources of power.



## Connectors and LEDs



- 1 OUT interface
- 2 IN interface

The SNI40 model holds 5 1Gbe Ethernet interfaces and 2 SFP sockets for adding 1Gbe Ethernet transceivers.

Specifications of Stormshield Network-approved transceivers are set out in the sections [Optional Ethernet Transceivers](#) and [Fiber Ethernet connectors](#).



- 1 SSD activity LED (yellow)
- 2 Run LED (green)
- 3 Power LED (green)

- 1 Two network ports dedicated to **Ethernet Bypass**.
- 2 The **USB 2.0 port** can be used for secure configurations or upgrades. You can also plug a USB key or an approved USB modem into it.
- 3 The **USB 3.0 port** can be used for secure configurations or upgrades. You can also plug a USB key or an approved USB modem into it.
- 4 The **serial port** enables access to the product in console mode; the user can connect to the firewall directly from a computer. The default baud rate on this model is 115 200 baud (8N1).
- 5 The **Reset button** (underside): resets the firewall's electrical supply.
- 6 Connection of the **protective earth circuit**.
- 7 This 6-pole screw terminal connector enables connection to a 24VDC redundant power supply and a **P-Fail** relay.

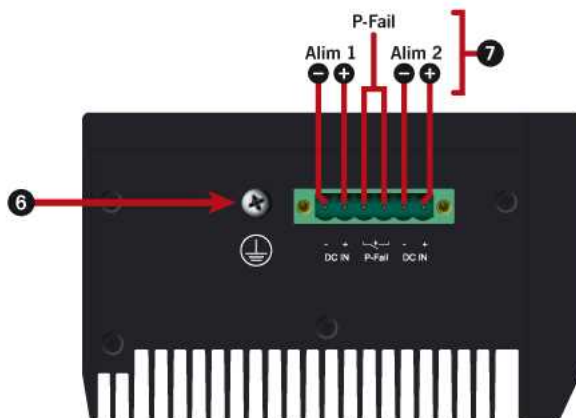

## Redundant power supply and P-Fail (Power Failure) relay

### ! REMINDER

Before plugging any equipment into a DC power supply module, read the [security rules](#) carefully and follow them.

Both electrical power supplies can be connected to the SNS40 to provide a redundant power source. Connect the power supplies according to the diagram shown in [Connectors and LEDs](#)

A P-Fail relay makes it possible to detect an abnormal status on a power supply. You can connect this relay to a sound or light alarm, such as a buzzer or a LED, equipped with an independent power supply. To do so, connect the external power supply of the alarm to the third and fourth pins. If both power supplies run at the same time, the alarm will be short-circuited. If either power supply is defective, the alarm will go off. The recommended intensity for this relay is 30 VDC, 2A or 60W.



## SNxr1200 model

### Connectors and LEDs



- 1 Power LED (green)
- 1 Connection of the protective earth circuit.

### Plugging in connectors

To access your firewall from a client workstation, you will need to connect on the **IN** or “Internal” port, or on another port (except the **OUT** port) located on connectors **J3** or **J4**.

For further information, refer to the section on **Network connectors**, under **IN/OUT definition**.

For testing purposes, an IT connection kit (breakout cables) is available as an option. This kit is not intended for use in a production environment.

To connect the cables, engage the coded pins according to the diagram opposite (coded pins specific to each connector), then screw firmly to ensure that the product is watertight.

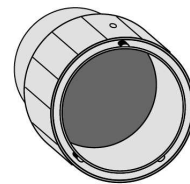

### J1 connectors

J1 connectors, which cater to the product’s power supply, are described below.

The power adapter (provided as an option) is plugged into the breakout cable (“IT connection kit” provided as an option) corresponding to this connector.

Pin	Signal
J1.1	VIN_28+
J1.2	VIN_28-
J1.3	n/a

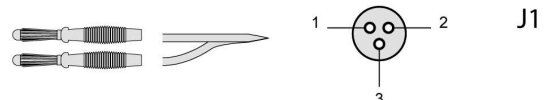



## J2 connectors

J2 connectors correspond to the following connectors:

- 2 push buttons: ON/OFF switch and Reset button (resets the firewall's electrical supply),
- 1 DVI output port,
- 2 USB 2.0 ports,
- 1 RJ45 1Gbps Ethernet port,
- 1 RS232 serial port,
- 1 RS422 serial port,

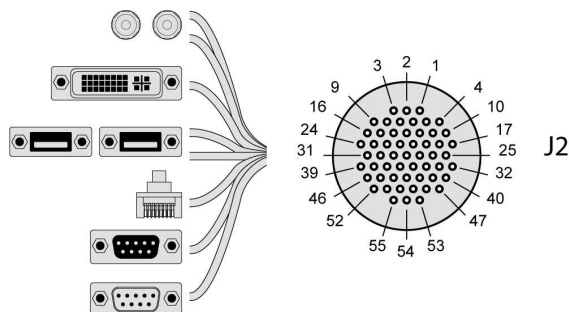

## "IT connection kit" connectors

2 push buttons:  
ON/OFF switch  
and Reset button  
(electrically resets  
the firewall)

Details	Pin	Signal
ON	J2.10	POWER_BUTTON+
OFF	J2.11	POWER_BUTTON-
RESET	J2.17	RESET_BUTTON+
	J2.18	RESET_BUTTON-

1 DVI output port

Pin	Signal
J2.2	DVI_DATA2+
J2.3	DVI_DATA2-
J2.4	DVI_DDCCLK
J2.5	DVI_DDCDATA
J2.6	DVI_HPD
J2.2	DVI_DATA2+

2 USB 2.0 ports

Details	Pin	Signal
USB no. 1	J2.47	USB0_5VDC
	J2.48	USB0-
	J2.49	USB0+
	J2.50	USB0_GND
USB no. 2	J2.51	USB1_GND
	J2.53	USB1_5VDC
	J2.54	USB1-
	J2.55	USB1+

1 Ethernet port  
RJ45 1Gbps

Details	Pin	Signal
OUT 1	J2.32	ETH1_MDIO+
	J2.33	ETH1_MDIO-
	J2.34	ETH1_MDI1+
	J2.35	ETH1_MDI1-
	J2.36	ETH1_MDI2+
	J2.37	ETH1_MDI2-
	J2.38	ETH1_MDI3+
	J2.39	ETH1_MDI3-

1 RS232 serial port

Pin	Signal
J2.45	RS232_SERO_TX
J2.46	RS232_SERO_RX

1 RS422 serial port

Pin	Signal
J2.40	RS422_SERO_RXN
J2.41	RS422_SERO_RXP
J2.42	RS422_SERO_TXN
J2.43	RS422_SERO_TXP

## Overview of J2 connectors

Pin	Signal	Pin	Signal	Pin	Signal
J2.1	GND	J2.21	n/a	J2.41	RS422_SERO_RXP
J2.2	DVI_DATA2+	J2.22	GND	J2.42	RS422_SERO_TXN
J2.3	DVI_DATA2-	J2.23	DVI_CLK+	J2.43	RS422_SERO_TXP
J2.4	DVI_DDCCLK	J2.24	DVI_CLK-	J2.44	GND
J2.5	DVI_DDCDATA	J2.25	n/a	J2.45	RS232_SERO_TX
J2.6	DVI_HPD	J2.26	n/a	J2.46	RS232_SERO_RX
J2.7	GND	J2.27	n/a	J2.47	USB0_5VDC
J2.8	DVI_DATA1+	J2.28	n/a	J2.48	USB0-
J2.9	DVI_DATA1-	J2.29	n/a	J2.49	USB0+
J2.10	POWER_BUTTON+	J2.30	n/a	J2.50	USB0_GND
J2.11	POWER_BUTTON-	J2.31	n/a	J2.51	USB1_GND
J2.12	GND	J2.32	ETH1_MDIO+	J2.52	GND
J2.13	DVI_5VDC	J2.33	ETH1_MDIO-	J2.53	USB1_5VDC
J2.14	GND	J2.34	ETH1_MDI1+	J2.54	USB1-
J2.15	DVI_DATA0+	J2.35	ETH1_MDI1-	J2.55	USB1+
J2.16	DVI_DATA0-	J2.36	ETH1_MDI2+		
J2.17	RESET_BUTTON+	J2.37	ETH1_MDI2-		
J2.18	RESET_BUTTON-	J2.38	ETH1_MDI3+		
J2.19	+5VDC_STANDBY (*1)	J2.39	ETH1_MDI3-		
J2.20	GND	J2.40	RS422_SERO_RXN		

(\*1) +5VDC\_STANDBY limited to 0.2A

(\*2) VBUS0, VBUS1: 0.5A for each voltage (0.8A max)





## J3 connectors

J3 connectors correspond to the following connectors:

- 2 USB 2.0 ports,
- 2 RJ45 1Gbps Ethernet ports,
- 1 RS232 serial port,
- 1 RS422 serial port,

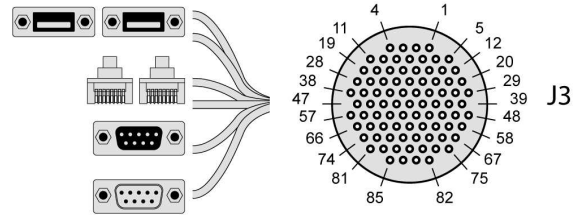

## "IT connection kit" connectors

### 2 USB 2.0 ports

Details	Pin	Signal
USB no. 1	J3.75	USB2_GND
	J3.76	USB2-
	J3.77	USB2+
	J3.78	USB2_5VDC
USB no. 2	J3.82	USB3_5VDC
	J3.83	USB3+
	J3.84	USB3-
	J3.85	USB3_GND

### 1 RS232 serial port

Pin	Signal
J3.70	RS232_1_RX
J3.71	RS232_1_TX

### 2 Ethernet ports RJ45 1Gbps

Details	Pin	Signal
DMZ2	J3.1	ETH4_MDIO+
	J3.2	ETH4_MDIO-
	J3.3	ETH4_MDI1+
	J3.4	ETH4_MDI1-
	J3.11	ETH4_MDI2+
	J3.10	ETH4_MDI2-
	J3.9	ETH4_MDI3+
	J3.8	ETH4_MDI3-
DMZ3	J3.31	ETH5_MDIO+
	J3.32	ETH5_MDIO-
	J3.33	ETH5_MDI1+
	J3.34	ETH5_MDI1-
	J3.35	ETH5_MDI2+
	J3.36	ETH5_MDI2-
	J3.37	ETH5_MDI3+
	J3.38	ETH5_MDI3-

### 1 RS422 serial port

Pin	Signal
J3.73	RS422_1_RX+
J3.74	RS422_1_RX-
J3.80	RS422_1_TX-
J3.81	RS422_1_TX+

## Overview of J3 connectors

Pin	Signal	Pin	Signal	Pin	Signal	Pin	Signal	Pin	Signal
J3.1	ETH4_MDIO+	J3.21	n/a	J3.41	n/a	J3.61	LINE_OUTn/a_L	J3.81	RS422_1_TX+
J3.2	ETH4_MDIO-	J3.22	n/a	J3.42	n/a	J3.62	LINE_OUTn/a_GND	J3.82	USB3_5VDC
J3.3	ETH4_MDI1+	J3.23	n/a	J3.43	n/a	J3.63	LINE_OUTn/a_R	J3.83	USB3+
J3.4	ETH4_MDI1-	J3.24	n/a	J3.44	n/a	J3.64	n/a	J3.84	USB3-
J3.5	n/a	J3.25	n/a	J3.45	n/a	J3.65	n/a	J3.85	USB3_GND
J3.6	n/a	J3.26	n/a	J3.46	n/a	J3.66	n/a		
J3.7	n/a	J3.27	n/a	J3.47	n/a	J3.67	n/a		
J3.8	ETH4_MDI3-	J3.28	n/a	J3.48	n/a	J3.68	LINE_IN_L		
J3.9	ETH4_MDI3+	J3.29	n/a	J3.49	n/a	J3.69	LINE_IN_R		
J3.10	ETH4_MDI2-	J3.30	n/a	J3.50	n/a	J3.70	RS232_1_RX		
J3.11	ETH4_MDI2+	J3.31	ETH5_MDIO+	J3.51	n/a	J3.71	RS232_1_TX		
J3.12	n/a	J3.32	ETH5_MDIO-	J3.52	n/a	J3.72	GND		
J3.13	n/a	J3.33	ETH5_MDI1+	J3.53	n/a	J3.73	RS422_1_RX+		
J3.14	n/a	J3.34	ETH5_MDI1-	J3.54	n/a	J3.74	RS422_1_RX-		
J3.15	n/a	J3.35	ETH5_MDI2+	J3.55	n/a	J3.75	USB2_GND		
J3.16	n/a	J3.36	ETH5_MDI2-	J3.56	n/a	J3.76	USB2-		
J3.17	n/a	J3.37	ETH5_MDI3+	J3.57	n/a	J3.77	USB2+		
J3.18	n/a	J3.38	ETH5_MDI3-	J3.58	n/a	J3.78	USB2_5VDC		
J3.19	n/a	J3.39	n/a	J3.59	GND	J3.79	GND		
J3.20	n/a	J3.40	n/a	J3.60	LINE_IN_Cn/a_OM	J3.80	RS422_1_TX-		





## J4 connectors

J4 connectors correspond to the following connectors:

- 2 RJ45 1Gbps Ethernet ports,
- 1 GPIO COM port.

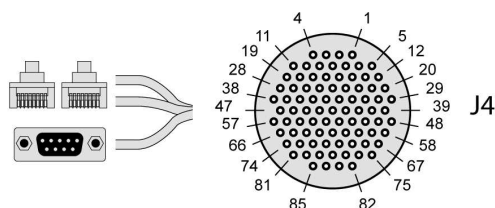

## "IT connection kit" connectors

2 Ethernet ports  
RJ45 1Gbps

Details	Pin	Signal
IN 2	J4.1	ETH2 MDIO+
	J4.2	ETH2 MDIO-
	J4.3	ETH2 MDI1+
	J4.4	ETH2 MDI1-
	J4.11	ETH2 MDI2+
	J4.10	ETH2 MDI2-
	J4.9	ETH2 MDI3+
	J4.8	ETH2 MDI3-
DMZ1	J4.55	ETH3 MDIO+
	J4.56	ETH3 MDIO-
	J4.57	ETH3 MDI1+
	J4.66	ETH3 MDI1-
	J4.65	ETH3 MDI2+
	J4.64	ETH3 MDI2-
	J4.63	ETH3 MDI3+
	J4.62	ETH3 MDI3-

1 GPIO COM port

Pin	Signal
J4.20	GP03
J4.29	GP02
J4.48	GPI2
J4.58	GPI3

## Overview of J4 connectors

Pin	Signal	Pin	Signal	Pin	Signal	Pin	Signal	Pin	Signal
J4.1	ETH2 MDIO+	J4.21	n/a	J4.41	n/a	J4.61	n/a	J4.81	n/a
J4.2	ETH2 MDIO-	J4.22	n/a	J4.42	n/a	J4.62	ETH3 MDI3-	J4.82	n/a
J4.3	ETH2 MDI1+	J4.23	n/a	J4.43	n/a	J4.63	ETH3 MDI3+	J4.83	n/a
J4.4	ETH2 MDI1-	J4.24	n/a	J4.44	n/a	J4.64	ETH3 MDI2-	J4.84	n/a
J4.5	n/a	J4.25	n/a	J4.45	n/a	J4.65	ETH3 MDI2+	J4.85	n/a
J4.6	n/a	J4.26	n/a	J4.46	n/a	J4.66	ETH3 MDI1-		
J4.7	n/a	J4.27	n/a	J4.47	n/a	J4.67	n/a		
J4.8	ETH2 MDI3-	J4.28	n/a	J4.48	GPI2	J4.68	n/a		
J4.9	ETH2 MDI3+	J4.29	GP02	J4.49	n/a	J4.69	n/a		
J4.10	ETH2 MDI2-	J4.30	n/a	J4.50	n/a	J4.70	n/a		
J4.11	ETH2 MDI2+	J4.31	n/a	J4.51	n/a	J4.71	n/a		
J4.12	n/a	J4.32	n/a	J4.52	n/a	J4.72	n/a		
J4.13	n/a	J4.33	n/a	J4.53	n/a	J4.73	n/a		
J4.14	n/a	J4.34	n/a	J4.54	n/a	J4.74	n/a		
J4.15	n/a	J4.35	n/a	J4.55	ETH3 MDIO+	J4.75	n/a		
J4.16	n/a	J4.36	n/a	J4.56	ETH3 MDIO-	J4.76	n/a		
J4.17	n/a	J4.37	n/a	J4.57	ETH3 MDI1+	J4.77	n/a		
J4.18	n/a	J4.38	n/a	J4.58	GPI3	J4.78	n/a		
J4.19	n/a	J4.39	GND	J4.59	n/a	J4.79	n/a		
J4.20	GP03	J4.40	n/a	J4.60	n/a	J4.80	n/a		



## Overview of RJ45 Ethernet connectors

To summarize, RJ45 Ethernet ports are arranged as follows:

Port	Signal	Pin	Port	Signal	Pin
<b>OUT 1</b>	ETH1_MDIO+	J2.32	<b>IN 2</b>	ETH2_MDIO+	J4.1
	ETH1_MDIO-	J2.33		ETH2_MDIO-	J4.2
	ETH1_MDI1+	J2.34		ETH2_MDI1+	J4.3
	ETH1_MDI1-	J2.35		ETH2_MDI1-	J4.4
	ETH1_MDI2+	J2.36		ETH2_MDI2+	J4.11
	ETH1_MDI2-	J2.37		ETH2_MDI2-	J4.10
	ETH1_MDI3+	J2.38		ETH2_MDI3+	J4.9
	ETH1_MDI3-	J2.39		ETH2_MDI3-	J4.8

Port	Signal	Pin	Port	Signal	Pin	Port	Signal	Pin
<b>DMZ1</b>	ETH3_MDIO+	J4.55	<b>DMZ2</b>	ETH4_MDIO+	J3.1	<b>DMZ3</b>	ETH5_MDIO+	J3.31
	ETH3_MDIO-	J4.56		ETH4_MDIO-	J3.2		ETH5_MDIO-	J3.32
	ETH3_MDI1+	J4.57		ETH4_MDI1+	J3.3		ETH5_MDI1+	J3.33
	ETH3_MDI1-	J4.66		ETH4_MDI1-	J3.4		ETH5_MDI1-	J3.34
	ETH3_MDI2+	J4.65		ETH4_MDI2+	J3.11		ETH5_MDI2+	J3.35
	ETH3_MDI2-	J4.64		ETH4_MDI2-	J3.10		ETH5_MDI2-	J3.36
	ETH3_MDI3+	J4.63		ETH4_MDI3+	J3.9		ETH5_MDI3+	J3.37
	ETH3_MDI3-	J4.62		ETH4_MDI3-	J3.8		ETH5_MDI3-	J3.38



# Network connectors

## RJ45 Ethernet connectors

These interfaces have to be connected to other network appliances with an RJ45 Ethernet cable. Details on how to connect SNxr1200 model firewalls are given in the section [RJ45 Ethernet cabling on the SNxr1200 model](#) below.

### **i** NOTE

A crossover cable is delivered with the Stormshield Network firewall. This is a Category 5e cable, for running in 10Mbe, 100Mbe, 1Gbe or 2.5Gbe. Check the compatibility of your devices.

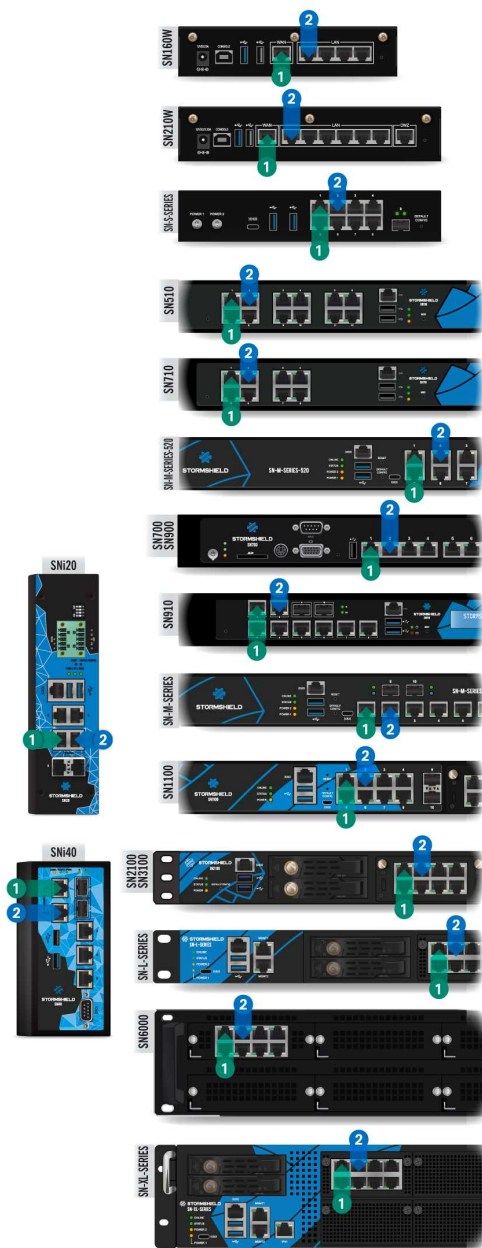

## Connectors

The Ethernet (1Gbe, 2.5Gbe or 10Gbe) ports of the Stormshield Network SN range are configured in auto-sense mode, meaning that they adapt to the configuration of the Ethernet port on the appliance to which they are connected. These ports are therefore compatible with straight or crossover RJ45 Ethernet cables.

On SN710, SN910, SN-M-Series-520, SN-M-Series-720, SN-M-Series-920, SN1100, SN2100, SN3100 and SN6100 models, Ethernet RJ45 ports can be added by inserting extension modules.

### **!** WARNING

Keep data cables some distance away from any source of electromagnetic interference such as mains cables, radio transmitters, fluorescent tubes, etc.

## IN/OUT definition

The **OUT 1** or "External" network port is reserved for the modem or Internet router.

**Access to this interface is blocked by default, you will therefore not be able to access the configuration interface from this port.**

To access your firewall from a client workstation, you will need to connect on the **IN 2** or "Internal" port, or on another port (except port 1).



For further information regarding the startup procedure of your firewall, refer to the section [Initial connection to the product](#).

## Ethernet cabling on the SNxr1200 model

### ! WARNING

To access your firewall from a client workstation, you will need to connect on the **IN 2** or “Internal” port, or on another port (except port **1**). Refer to the previous section [IN/OUT definition](#).

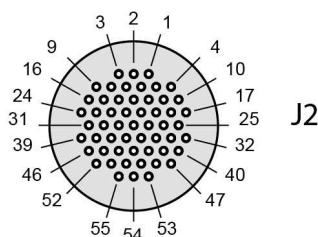

Port	Signal	Pin	Port	Signal	Pin
OUT 1	ETH1_MDIO+	J2.32	IN 2	ETH2_MDIO+	J4.1
	ETH1_MDIO-	J2.33		ETH2_MDIO-	J4.2
	ETH1_MDI1+	J2.34		ETH2_MDI1+	J4.3
	ETH1_MDI1-	J2.35		ETH2_MDI1-	J4.4
	ETH1_MDI2+	J2.36		ETH2_MDI2+	J4.11
	ETH1_MDI2-	J2.37		ETH2_MDI2-	J4.10
	ETH1_MDI3+	J2.38		ETH2_MDI3+	J4.9
	ETH1_MDI3-	J2.39		ETH2_MDI3-	J4.8

## LEDs of interfaces (all models except SNxr1200)

LEDs associated with Ethernet interfaces provide indications on the status of the connection. following information on the connection:

### SN160, SN160W, SN210, SN210W and SN310 models

Name	Color	Status	Status
Front panel LED ACT/LINK	Green	On	Link established between the Ethernet port and the connected appliance.
		Off	Ethernet port switched off or link not established with the connected appliance.
		Blinking	The Ethernet port is sending or receiving data. The blinking speed varies according to the volume of traffic.

### SN160W and SN210W models

Name	Color	Status	Status
Front panel Wi-Fi LED ACT/LINK	Blue	On	Wi-Fi interface on.
		Off	Wi-Fi interface off.
		Blinking	The Wi-Fi interface is sending or receiving data. The blinking speed varies according to the volume of traffic.



SN-XS-Series-170, SN-S-Series-220, SN-S-Series-320, SN510, SN-M-Series-520, SN710, SN910, SN1100, SN-M-Series-720, SN-M-Series-920, SN2100, SN3100 and SNi10 models

**1Gbe Ethernet ports (except on SN-XS-Series-170, SN-S-Series-220, SN-S-Series-320 and SNi10 models)**

Name	Color	Status	Status
Left LED ACT/LINK	Green	On	Link established between the Ethernet port and the connected appliance.
		Off	Ethernet port switched off or link not established with the connected appliance.
		Blinking	The Ethernet port is sending or receiving data. The blinking speed varies according to the volume of traffic.
Right LED SPEED	Yellow	On	Media speed negotiated at 1Gbps.
	Green	On	Media speed negotiated at 100Mbps.
		Off	Media speed negotiated at 10Mbps.

**2.5Gbe Ethernet ports (except on SN510 models)**

**! IMPORTANT**

For the 2.5Gbps extension module to be compatible with the SN1100 model, the BIOS must be updated to version R1.01 or higher.

Name	Color	Status	Status
Left LED ACT/LINK	Green	On	Link established between the Ethernet port and the connected appliance.
		Off	Ethernet port switched off or link not established with the connected appliance.
		Blinking	The Ethernet port is sending or receiving data. The blinking speed varies according to the volume of traffic.
Right LED SPEED	Orange	On	Media speed negotiated at 2.5Gbps.
	Green	On	Media speed negotiated at 1Gbps.
		Off	Media speed negotiated at 100Mbps.
		Off	Media speed negotiated at 10Mbps.

**10Gbe Ethernet ports (except on SN510, SN-XS-Series-170, SN-S-Series-220, SN-S-Series-320 and SNi10 models)**

Name	Color	Status	Status
Left LED ACT/LINK	Green	On	Link established between the Ethernet port and the connected appliance.
		Off	Ethernet port switched off or link not established with the connected appliance.
		Blinking	The Ethernet port is sending or receiving data. The blinking speed varies according to the volume of traffic.
Right LED SPEED	Green	On	Media speed negotiated at 10Gbps.
	Yellow	On	Media speed negotiated at 1Gbps.
		Off	Media speed negotiated at 100Mbps.



## SN-L-Series-2200, SN-L-Series-3200, SN-XL-Series-5200 and SN-XL-Series-6200 models

**1Gbe Ethernet ports**

Name	Color	Status	Status
Left LED ACT/LINK	Green	On	Link established between the Ethernet port and the connected appliance.
		Off	Ethernet port switched off or link not established with the connected appliance.
		Blinking	The Ethernet port is sending or receiving data. The blinking speed varies according to the volume of traffic.
Right LED SPEED	Yellow	On	Media speed negotiated at 1Gbps.
	Green	On	Media speed negotiated at 100Mbps.
		Off	Media speed negotiated at 10Mbps.

**2.5Gbe Ethernet ports**

Name	Color	Status	Status
Left LED ACT/LINK	Green	On	Link established between the Ethernet port and the connected appliance.
		Off	Ethernet port switched off or link not established with the connected appliance.
		Blinking	The Ethernet port is sending or receiving data. The blinking speed varies according to the volume of traffic.
Right LED SPEED	Orange	On	Media speed negotiated at 2.5Gbps.
	Green	On	Media speed negotiated at 1Gbps.
		Off	Media speed negotiated at 100Mbps.
		Off	Media speed negotiated at 10Mbps.

**10Gbe Ethernet ports**

Name	Color	Status	Status
Left LED ACT/LINK	Green	On	Link established between the Ethernet port and the connected appliance.
		Off	Ethernet port switched off or link not established with the connected appliance.
		Blinking	The Ethernet port is sending or receiving data. The blinking speed varies according to the volume of traffic.
Right LED SPEED	Green	On	Media speed negotiated at 10Gbps.
	Yellow	On	Media speed negotiated at 1Gbps, 2.5Gbps or 5Gbps.
		Off	Media speed negotiated at 100Mbps.

## SN6100 model

**1Gbe Ethernet ports (including IPMI)**

Name	Color	Status	Status
------	-------	--------	--------



Left LED ACT/LINK	Yellow	On	Link established between the Ethernet port and the connected appliance.
		Off	Ethernet port switched off or link not established with the connected appliance.
		Blinking	The Ethernet port is sending or receiving data. The blinking speed varies according to the volume of traffic.
Right LED SPEED	Yellow	On	Media speed negotiated at 1Gbps.
	Green	On	Media speed negotiated at 100Mbps.
		Off	Media speed negotiated at 10Mbps.

**10Gbe Ethernet ports**

Name	Color	Status	Status
Left LED ACT/LINK	Green	On	Link established between the Ethernet port and the connected appliance.
		Off	Ethernet port switched off or link not established with the connected appliance.
		Blinking	The Ethernet port is sending or receiving data. The blinking speed varies according to the volume of traffic.
Right LED SPEED	Green	On	Media speed negotiated at 10Gbps.
	Yellow	On	Media speed negotiated at 1Gbps.
		Off	Media speed negotiated at 100Mbps.

**SNi20 model**

Name	Color	Status	Status
Lower LED ACT/LINK	Green	On	Link established between the Ethernet port and the connected appliance.
		Off	Ethernet port switched off or link not established with the connected appliance.
		Blinking	The Ethernet port is sending or receiving data. The blinking speed varies according to the volume of traffic.
Upper LED SPEED	Yellow	On	Media speed negotiated at 1Gbps.
	Green	On	Media speed negotiated at 100Mbps.
		Off	Media speed negotiated at 10Mbps.

**SNi40 model**

Name	Color	Status	Status
Upper LED ACT/LINK	Yellow	On	Link established between the Ethernet port and the connected appliance.
		Off	Ethernet port switched off or link not established with the connected appliance.
		Blinking	The Ethernet port is sending or receiving data. The blinking speed varies according to the volume of traffic.
Lower LED SPEED	Yellow	On	Media speed negotiated at 1Gbps.
	Green	On	Media speed negotiated at 100Mbps.
		Off	Media speed negotiated at 10Mbps.





## Fiber Ethernet connectors (all models except SN160, SN210, SN310 and SNxr1200)

These Ethernet ports are available by default on the following models:

- SN-M-Series-520 and SN910: ports 9 and 10 (via two sockets for SFP transceivers),
- SNi20: ports 5 and 6 (via two sockets for SFP transceivers)\*,
- SNi40: ports 6 and 7 (via two sockets for SFP transceivers),
- SN-M-Series-720, SN-M-Series-920 and SN1100: ports 9 and 10 (via two sockets for SFP+ transceivers),
- SN6100: ports MGMT1 and MGMT2 (via two sockets for SFP+ transceivers).

\*may vary by license.

On SN-M-Series-520, SN710, SN910, SN-M-Series-720, SN-M-Series-920, SN1100, SN2100, SN3100, SN-L-Series-2200, SN-L-Series-3200, SN6100, SN-XL-Series-5200 and SN-XL-Series-6200 models, Ethernet fiber connectors can be added by inserting extension modules.

In both cases it is necessary to install a transceiver. **SFP** transceivers are used for **1Gbe** connections, **SFP+** for **1Gbe/10Gbe** connections, **SFP28** for **25Gbe** connections, or **QSFP+** for **40Gbe** connections (on SN2100, SN3100, SN-L-Series-2200, SN-L-Series-3200, SN6100, SN-XL-Series-5200 and SN-XL-Series-6200 models).



### IMPORTANT

Use only Stormshield Network-approved transceivers found in the catalogue.

## LEDs

The LEDs indicate the following information:

### 1Gbe connectors with SFP transceivers

#### Default ports on SN-S-Series-220, SN- S-Series-320, SN-M-Series-520, SN910 and SNi40 models

A green LED will light up when the link is established and blink depending on the volume of traffic.

For SN-M-Series-520 models, the position of LEDs is shown in the diagram on the right.

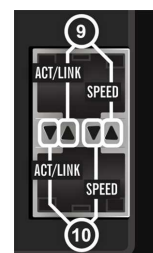

SN-M-Series-520: LEDs on ports 9 and 10

#### Extension modules for SN710, SN910, SN-M-Series-520, SN-M-Series-720, SN-M-Series-920, SN1100, SN2100, SN3100 SN-L-Series-2200, SN-L-Series-3200, SN-XL-Series-5200 and SN-XL-Series-6200 models

A green LED will light up when the link is established and blink depending on the volume of traffic.



### Default ports on SNi20\* models

Both lower LEDs correspond to port 5 and both upper LEDs correspond to port 6.

The position of LEDs is shown in the diagram on the right.

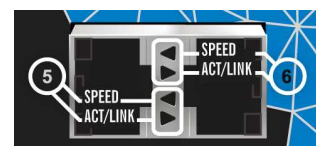

SNi20: LEDs on ports 5 and 6

Name	Color	Status	Status
Upper LED SPEED	Yellow	On	Media speed negotiated at 1Gbps.
Lower LED ACT/LINK	Green	On	Link established between the Ethernet port and the connected appliance.
		Off	Ethernet port switched off or link not established with the connected appliance.
		Blinking	The Ethernet port is sending or receiving data. The blinking speed varies according to the volume of traffic.

*\* may vary by license.*

### Extension modules for SN6100 models

Name	Color	Status	Status
Left LED ACT/LINK	Yellow	On	Link established between the Ethernet port and the connected appliance.
		Off	Ethernet port switched off or link not established with the connected appliance.
		Blinking	The Ethernet port is sending or receiving data. The blinking speed varies according to the volume of traffic.
Right LED SPEED	Yellow	On	Media speed negotiated at 1Gbps.

## 10Gbps connectors with SFP+ transceivers

### Extension modules for SN710, SN910, SN-M-Series-720 and SN-M-Series-920 models

Name	Color/State	Status
Left LED ACT/LINK	Green/Blinking	Link established between the Ethernet port and the connected appliance. The blinking speed varies according to the volume of traffic.
Right LED SPEED	Blue	Media speed negotiated at 10Gbps.
	Yellow	Media speed negotiated at 1Gbps.

**Default ports and extension modules on SN-M-Series-520, SN-M-Series-720, SN-M-Series-920, SN1100, SN2100, SN3100, SN-L-Series-2200, SN-L-Series-3200, SN-XL-Series-5200 and SN-XL-Series-6200 models**

For SN1100 models, the position of LEDs is shown in the diagram below.

Name	Color/State	Status
Left LED ACT/LINK (Upper LED on SN-M-Series-720 and SN-M-Series-920)	Green/Blinking	Link established between the Ethernet port and the connected appliance. The blinking speed varies according to the volume of traffic.
Right LED SPEED (Upper LED on SN-M-Series-720 and SN-M-Series-920)	Blue	Media speed negotiated at 10Gbps.
	Off	Media speed negotiated at 1Gbps.

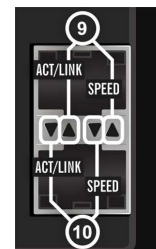

SN1100: LEDs on ports 9 and 10

**Default ports and extension modules for SN6100 models**

Name	Color	Status	Status
Left LED ACT/LINK	Green	On	Link established between the Ethernet port and the connected appliance.
		Off	Ethernet port switched off or link not established with the connected appliance.
		Blinking	The Ethernet port is sending or receiving data. The blinking speed varies according to the volume of traffic.
Right LED SPEED	Green	On	Media speed negotiated at 10Gbps.
		Off	Media speed negotiated at 1Gbps.

**25Gbe connectors with SFP28 transceivers****Extension modules for SN-M-Series-520, SN-M-Series-720, SN-M-Series-920, SN1100, SN2100 and SN3100 models**

Name	Color/State	Status
Left LED ACT/LINK	Green/Blinking	Link established between the Ethernet port and the connected appliance. The blinking speed varies according to the volume of traffic.
Right LED SPEED	Green	Media speed negotiated at 25Gbps.
	Yellow	Media speed negotiated at 10Gbps.

**40Gbe connectors with QSFP+ transceivers**

**Extension modules for SN2100, SN3100, SN-L-Series-2200, SN-L-Series-3200, SN-XL-Series-5200 and SN-XL-Series-6200 models**

Name	Color	Status	Status
Left LED ACT/LINK	Green/Blinking	On	Link established between the Ethernet port and the connected appliance.
		Blinking	The blinking speed varies according to the volume of traffic.
Right LED SPEED	Green	On	Media speed negotiated at 40Gbps.

**Extension modules for SN6100 models**

Name	Color	Status	Status
Left LED ACT/LINK	Yellow	On	Link established between the Ethernet port and the connected appliance.
		Off	Ethernet port switched off or link not established with the connected appliance.
		Blinking	The Ethernet port is sending or receiving data. The blinking speed varies according to the volume of traffic.
Right LED SPEED	Yellow	On	Media speed negotiated at 40Gbps.

**Optional Ethernet transceivers****Ethernet fiber transceivers (SN710 and upwards, SNi20 and SNi40)**

For 1 Gbps transmission, two types of transceivers are available according to the length of the cable and the type of fiber used:

- SFP SX: short distance
- SFP LX: long distance.

For 10 Gbps transmission, two types of transceivers are available according to the length of the cable and the type of fiber used:

- SFP+ SR: short distance
- SFP+ LR: long distance.

For 25 Gbps transmission, two types of transceivers are available according to the length of the cable and the type of fiber used:

- SFP28 SR: short distance
- SFP28 LR: long distance.

For 40 Gbps transmission, two types of transceivers are available according to the length of the cable and the type of fiber used:

- QSFP+ SR4: short distance
- QSFP+ LR4: long distance

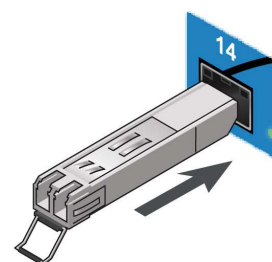

**NOTE**

Only LC fiber optic connectors are supported (or 1x12 MP0 for QSFP+ SR4 and SFP28 SR).

### Ethernet copper transceivers (SN710 and upwards, SNi20 and SNi40)

For 1 Gbps transmissions, such RJ45 over SFP transceivers (1000/100/10Base-T) require copper Ethernet RJ45 cables. These must be Category 5e cables, for running in 10 Mbps, 100 Mbps or 1 Gbps. Check the compatibility of your devices.

### Stormshield Network-approved Ethernet transceivers

		Cable/fiber type	Color of extraction lever/Usual color of connection plug	Wavelength	Typical maximum distance supported*	SN-S-Series-220 SN-S-Series-320 SNi20 SNi40	SN710 SN910 SN-M-Series-520 SN-M-Series-720 SN-M-Series-920 SN1100	SN2100 SN3100	SN-L-Series-2200 SN-L-Series-3200 SN6100 SN-XL-Series-5200 SN-XL-Series-6200
FIBER CONNECTOR									
1Gbe SFP	Base T	multimode	black/orange	850nm	550m	●	●	●	●
	SFP 1000Base-SX	multimode	black/orange	850nm	550m	●	●	●	●
	SFP 1000Base-LX Ethernet 1000Base-LX	single mode	blue/yellow	1310nm.	10km	●	●	●	●
10Gbe SFP+	Base T	multimode	beige/orange	850nm	300m at 10Gbps 550m at 1Gbps		●	●	●
	SFP+ 10GBASE-SR/ 1000Base-SX Ethernet 10GBASE-SR/ 1000Base-SX	multimode	beige/orange	850nm	300m at 10Gbps 550m at 1Gbps		●	●	●
	SFP+ 10GBASE-LR/ 1000Base-LX Ethernet 10GBASE-LR /2500Base-LX	single mode	blue/yellow	1310nm	10km		●	●	●
25Gbe SFP28	SFP28 25GBASE-SR/ 10GBASE-SR Ethernet 25GBASE-SR/ 10GBASE-SR	multimode with 1x12 MP0 female connector	beige/orange	850nm	100m		●	●	
	SFP28 25GBASE-LR Ethernet 25GBASE-LR	single mode	blue/yellow	1310nm	10km		●	●	
40Gbe QSFP+	QSFP+ 40GBASE-SR4 Ethernet 40GBASE-SR4	multimode with 1x12 MP0 female connector	beige/-	850nm	150m with multi-mode fiber			●	●
	QSFP+ 40GBASE-LR Ethernet 40GBASE-LR4	single mode	blue/yellow	1310nm	10km with single-mode fiber			●	●
COPPER CONNECTOR									
1Gbe SFP	RJ45 over SFP 1000/100/10Base-T	Category 5e RJ45 Ethernet cable	- /-		100m	●	●	●	●



## Extension modules (SN710 and upwards)

The process of removing an extension module on SN-M-Series-520, SN710, SN910, SN-M-Series-720, SN-M-Series-920, SN1100, SN2100, SN3100, SN-L-Series-2200, SN-L-Series-3200, SN6100, SN-XL-Series-5200 and SN-XL-Series-6200 models takes place in three main steps:

- **Step 1:** Shut down firewall,
- **Step 2:** Remove or insert the module,
- **Step 3:** Restart the firewall.

SFP/SFP+/SFP28/QSFP+ transceivers for fiber extension modules have to be ordered separately.

SFP/SFP+/SFP28/QSFP+ transceivers are hot-swappable (they can be inserted and removed while the appliance is powered on).

## Description of extension modules for SN710 models and upwards

SN-M-Series-520, SN710, SN910, SN-M-Series-720, SN-M-Series-920, SN1100, SN2100, SN3100, SN-L-Series-2200, SN-L-Series-3200, SN6100, SN-XL-Series-5200 and SN-XL-Series-6200 models accept the following extension modules:

- **8-port 1Gbe copper module**
  - RJ45 connectors
  - 1000/100/10Base-T
- **8-port 2.5Gbe copper module (SN-M-Series-520, SN710, SN910, SN-M-Series-720, SN-M-Series-920, SN1100, SN2100, SN3100, SN-L-Series-2200, SN-L-Series-3200, SN-XL-Series-5200 and SN-XL-Series-6200 models)**
  - RJ45 connectors
  - 2500/1000/100/10Base-T
- **4-port 10Gbe copper module (SN-M-Series-520, SN-M-Series-720, SN-M-Series-920, SN1100, SN2100, SN3100, SN-L-Series-2200, SN-L-Series-3200, SN6100, SN-XL-Series-5200 and SN-XL-Series-6200 models)**
  - RJ45 connectors
  - 10G/1000/100Base-T
- **4-port 10Gbe fiber module (not available for SN-M-Series-520, SN-M-Series-720, SN-M-Series-920, SN1100, SN2100, SN3100, SN-L-Series-2200, SN-L-Series-3200, SN6100, SN-XL-Series-5200 and SN-XL-Series-6200 models)**

4 SFP+ sockets, supporting the following transceivers:

  - SFP fiber transceiver, 1000Base-SX (1Gbps Ethernet, short distance),
  - SFP fiber transceiver, 1000Base-LX (1Gbps Ethernet, long distance),
  - RJ45 over SFP copper transceiver, 1000/100/10Base-T.
- **8-port 1Gbe fiber module**

8 SFP+ sockets, supporting the following transceivers:

  - SFP fiber transceiver, 1000Base-SX (1Gbps Ethernet, short distance),
  - SFP fiber transceiver, 1000Base-LX (1Gbps Ethernet, long distance),
  - RJ45 over SFP copper transceiver, 1000/100/10Base-T.





- **2-port 10Gbe fiber module (not available for SN-M-Series-520, SN-M-Series-720, SN-M-Series-920, SN1100, SN2100, SN3100, SN-L-Series-2200, SN-L-Series-3200, SN6100, SN-XL-Series-5200 and SN-XL-Series-6200 models)**  
2 SFP+ sockets, supporting the following transceivers:
  - SFP+ fiber transceiver, 10GBase-SR (10Gbps Ethernet, short distance)/1000BASE-SX (1Gbps Ethernet, short distance),
  - SFP+ fiber transceiver, 10GBase-LR (10Gbps Ethernet, long distance) / 1000BASE-LX (1Gbps Ethernet, long distance).
- **4-port 10Gbe fiber module**  
4 SFP+ sockets, supporting the following transceivers:
  - SFP+ fiber transceiver, 10GBase-SR (10Gbps Ethernet, short distance)/1000BASE-SX (1Gbps Ethernet, short distance),
  - SFP+ fiber transceiver, 10GBase-LR (10Gbps Ethernet, long distance) / 1000BASE-LX (1Gbps Ethernet, long distance).
- **2-port 25Gbe fiber module (SN-M-Series-520, SN-M-Series-720, SN-M-Series-920, SN1100, SN2100 and SN3100 models)**  
2 SFP28, sockets, supporting the following transceivers:
  - SFP28 fiber transceiver, 25GBase-SR (25Gbps Ethernet, short distance)/10GBase-SR (10Gbps Ethernet, short distance),
  - SFP28 fiber transceiver, 25GBase-LR (25Gbps Ethernet, long distance).
- **2-port 40Gbe fiber module (SN2100, SN3100, SN-L-Series-2200, SN-L-Series-3200, SN6100, SN-XL-Series-5200 and SN-XL-Series-6200 models)**  
2 QSFP+ sockets, supporting the following transceivers:
  - QSFP+ fiber transceiver, 40GBase-SR4 (40Gbps Ethernet, short distance),
  - QSFP+ fiber transceiver, 40GBase-LR4 (40Gbps Ethernet, long distance).

#### **i NOTE**

A bandwidth restriction of 40Gbps has been imposed on the **2-port 40Gbe fiber module**.

## Sequence of modules

When extension modules are added or removed, ports will be reordered according to the order shown below.

### SN-M-Series-520 model



### SN710 model





### SN910 model

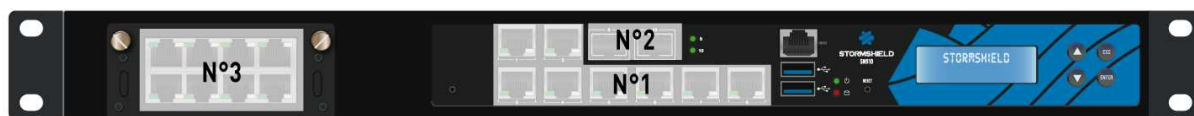

### SN-M-Series-720 and SN-M-Series-920 models

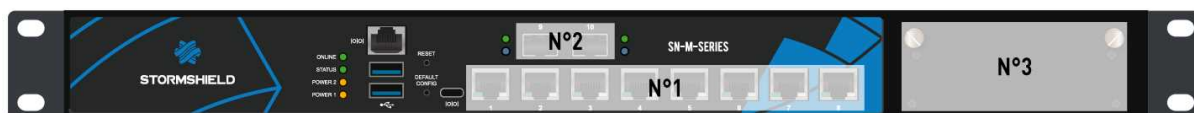

### SN1100 model



### SN2100 and SN3100 models



### SN-L-Series-2200 and SN-L-Series-3200 models



### SN6100 model



### SN-XL-Series-5200 and SN-XL-Series-6200 models

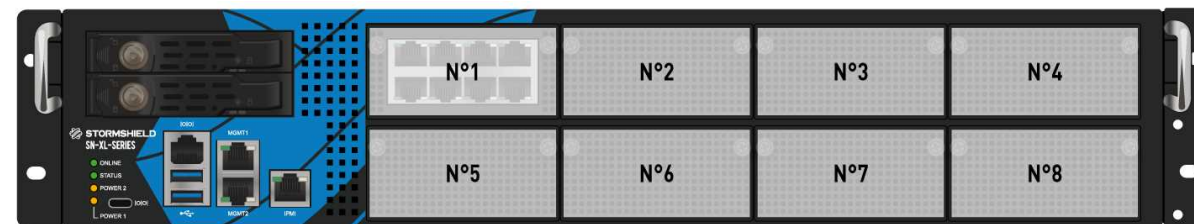



## Procedure for inserting or removing extension modules

No specific licenses are required for adding extension modules.

### ! IMPORTANT

Extension modules must only be removed or inserted on appliances that have fully shut down and which are necessarily unplugged from any electrical power supply.

On SN6100 models, spreading out network modules between both areas is recommended in order to enhance your product's performance. This makes it possible to balance the loads of both CPUs. The first set of modules and the 2 network ports located on the front of the appliance are managed as a priority by the first CPU and the second set by the second CPU.

### ! IMPORTANT

The theoretical bandwidth available for each network slot is:

- **SN710 models:** 30Gbps, full-duplex,
- **SN2100 and SN3100 models:** 30Gbps, full-duplex on slots 1 and 3,
- **SN-M-Series-520, SN910, SN-M-Series-720, SN-M-Series-920, SN1100 and SN6100 models:** 60Gbps, full-duplex
- **SN-L-Series-2200 and SN-L-Series-3200 models:** 60Gbps, full-duplex on slot 1.

### i REMINDER

In cases where modules are added subsequently in row 1, the interfaces of the modules in row 2 will be automatically re-ordered.

**Inserting an extension module on SN-M-Series-520, SN710, SN910, SN-M-Series-720, SN-M-Series-920, SN1100, SN2100, SN3100, SN-L-Series-2200, SN-L-Series-3200, SN6100, SN-XL-Series-5200 and SN-XL-Series-6200 models**

1. Shut down the firewall:
  - With the button on the front panel on SN1100, SN2100 and SN3100 models,
  - With the button on the rear panel on SN6100 models,
  - From the administration interface on SN710, SN-M-Series-520, SN910, SN-M-Series-720 and SN-M-Series-920 models.
2. Once the firewall has fully shut down, ensure that you unplug it from any electrical power supply.
3. Remove the filler panel by unscrewing the 2 knurled screws and extract it by pulling on both screws.
4. Present the module to be inserted, push it all the way in (push harder towards the end), then screw in the 2 knurled screws,
5. Reconnect the firewall to the power supply.
6. Start the firewall using the power button on the front panel.



### Removing an extension module on SN-M-Series-520, SN710, SN910, SN-M-Series-720, SN-M-Series-920, SN1100, SN2100, SN3100, SN-L-Series-2200, SN-L-Series-3200, SN6100, SN-XL-Series-5200 and SN-XL-Series-6200 models

1. Shut down the firewall:
  - With the button on the front panel on SN1100, SN2100 and SN3100 models,
  - With the button on the rear panel on SN6100 models,
  - From the administration interface on SN710, SN-M-Series-520, SN910, SN-M-Series-720 and SN-M-Series-920 models.
2. Once the firewall has fully shut down, ensure that you unplug it from any electrical power supply.
3. Unscrew the 2 knurled screws and extract the extension module by pulling on both screws.
4. Put back the filler panel by screwing in the 2 knurled screws.
5. Reconnect the firewall to the power supply.
6. Start the firewall using the power button on the front panel.



## Initial connection to the product

By default, the product is managed through its INTERNAL interface. On all models, this interface is identified by the number **2** (IN).

For the description of the interfaces, refer to the section [Presentation of the SNS range](#).

### Requirements

#### Lowest configuration to manage a Stormshield Network Security firewall

##### Lowest configuration

To find out the lowest OS version (firmware) required on your model, refer to the [Product life cycle guide](#).

##### Web administration interface

In order for the firewall administration interface to operate optimally, you are advised to use the latest versions of Microsoft Edge, Google Chrome and Mozilla Firefox (ESR version - Extended Support Release). For further information on these versions, please refer to the relevant vendors for the life cycles of their products.

#### Preparing the Internet access

Before installing the SNS firewall, ensure that the devices that connect to the Internet (if the firewall has to be connected to the Internet) have been appropriately installed and configured.

### Connections

Connect the network ports as follows:

- INTERNAL interface **2** (IN): Workstation,
- EXTERNAL interface **1** (OUT): Internet access device.

The client workstation can either be linked directly to the firewall's internal interface or connected to the local network, which is itself connected to the firewall's internal interface. For a direct connection of the workstation to the firewall, use the crossover Ethernet cable provided with the product. Details on how to connect SNxr1200 model firewalls are given in the section [Cabling on the SNxr1200 model](#) below.

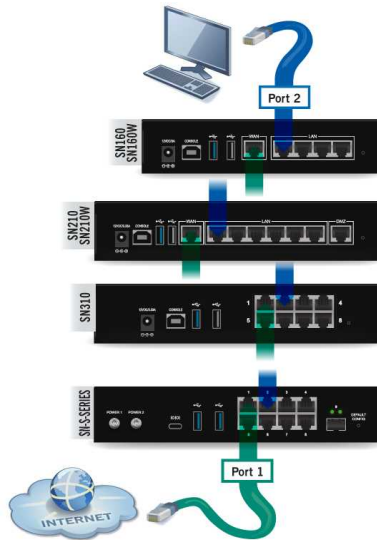

*SN160, SN160W, SN210, SN210W, SN310 and SN-S-Series models*

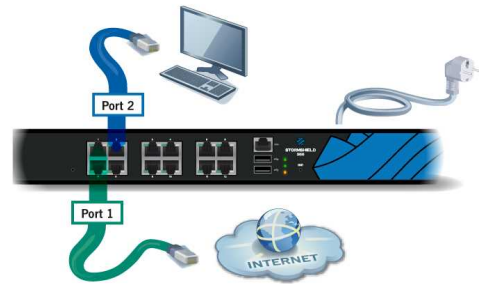

*SN510 and SN710 models*

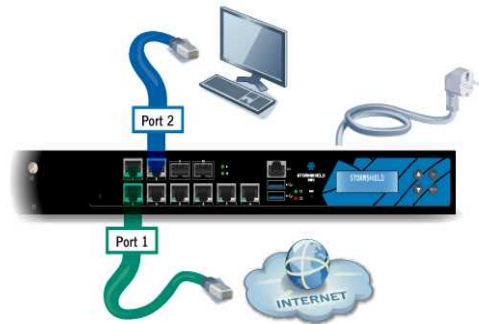

*SN910 model*

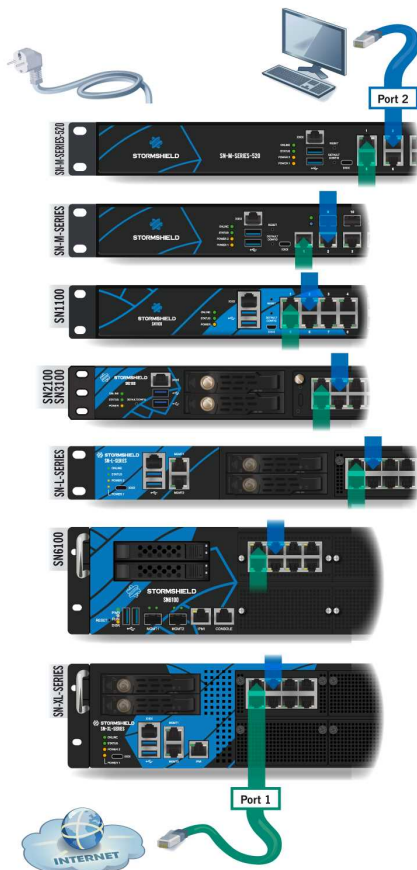

*SN-M-Series-520, SN-M-Series-720, SN-M-Series-920, SN1100, SN2100, SN3100, SN-L-Series-2200, SN-L-Series-3200, SN6100, SN-XL-Series-5200 and SN-XL-Series-6200 models*

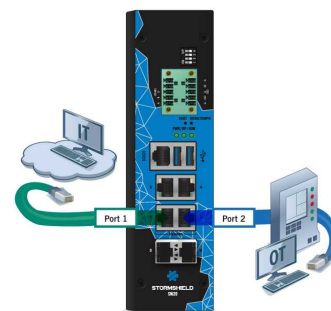

*SNI20 model*

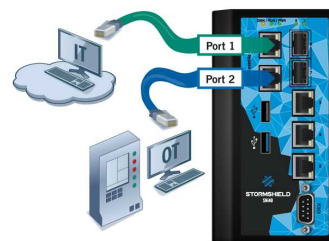

*SNI40 model*



**! IMPORTANT**

In factory settings, the network port **1** is reserved for the modem or Internet router. In this case, you cannot access the configuration interface from this port.

**Cabling on the SNxr1200 model****! WARNING**

To access your firewall from a client workstation, you will need to connect on the **IN 2** or “Internal” port, or on another port (except port **1**). Refer to the section on **Network connectors**, under **IN/OUT definition**.

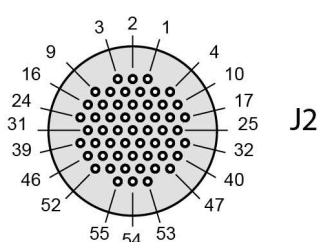

Port	Signal	Pin	Port	Signal	Pin
<b>OUT 1</b>	ETH1_MDIO+	J2.32	<b>IN 2</b>	ETH2_MDIO+	J4.1
	ETH1_MDIO-	J2.33		ETH2_MDIO-	J4.2
	ETH1_MD1+	J2.34		ETH2_MD1+	J4.3
	ETH1_MD1-	J2.35		ETH2_MD1-	J4.4
	ETH1_MD12+	J2.36		ETH2_MD12+	J4.11
	ETH1_MD12-	J2.37		ETH2_MD12-	J4.10
	ETH1_MD13+	J2.38		ETH2_MD13+	J4.9
	ETH1_MD13-	J2.39		ETH2_MD13-	J4.8

**Configuration**

When you first receive your firewall, it will run in transparent (bridge) mode and will have the IP address **10.0.0.254** with a subnetwork mask **255.0.0.0**. These parameters might not match your network configuration, but they are however necessary for the pre-configuration phase.

To connect to the firewall, you will need to use a workstation on which DHCP has been enabled, or its IP address has to be in the same address range as your firewall (10.0.0.0/8). DHCP is enabled by default on Windows platforms. If this is not the case, refer to the section **Network configuration of your client workstation**. If you do not know what these parameters mean, we strongly advise you to read up on TCP/IP as it would be very difficult for you to configure your Stormshield Network firewall without some of the basics.

**i NOTE**

For a manual configuration, we suggest that you use the IP address 10.0.0.1 and the subnet mask 255.0.0.0.

**Network configuration of your client workstation**

If DHCP has not been enabled on your client workstation, or for manual configurations, modify the **Network connection** parameters of your operating system.

In Windows, you generally need to select “Internet Protocol (TCP/IP)” from the list, then “Properties”, and select the option **Obtain an IP address automatically**.

To manually configure this network, enter the necessary address information. During the initial connection, the IP address of this workstation will need to belong to the same address range as the firewall, 10.0.0.0/8 by default.



## Startup

### ! WARNING

You **must not** unplug the product when it is **starting, shutting down or being upgraded**.

Except for SN910 appliances, these phases are indicated when the following LEDs are lit:

- **Power 3** and **Status 2** LEDs on SN160, SN160W, SN210, SN210W, SN310, SN-XS-Series-170, SN-S-Series-220, SN-S-Series-320, SN510, SN-M-Series-520, SN710, SN-M-Series-720, SN-M-Series-920, SN1100, SN2100, SN3100, SN-L-Series-2200, SN-L-Series-3200, SN-XL-Series-5200, SN-XL-Series-6200 and SNi10 models.
- **Power 3** LED for SN6100, SNi20, SNi40 and SNxr1200 models.

On SN160, SN160W, SN210, SN210W, SN310, SN-XS-Series-170, SN-S-Series-220, SN-S-Series-320, SN510, SN-M-Series-520, SN710, SN-M-Series-720, SN-M-Series-920, SN1100, SN2100, SN3100, SN-L-Series-2200, SN-L-Series-3200, SN-XL-Series-5200, SN-XL-Series-6200 and SNi10 models, upon startup, the LEDs light up in the following order:

#### **Power 3 + Status 2 → Online 1**

The *Power* and *Status* LEDs will light up first.

After a few minutes, the *Online* LED will light up, followed by a beep (on SN510, SN-M-Series-520, SN-M-Series-720, SN-M-Series-920, SN1100, SN2100 and SN3100 models) once your product is up and running.

For SNi20, SNi40 and SN6100 models, upon startup, the LEDs light up in the following order:

#### **Power 2 → Run 1**

The *Power* LED lights up first. After a few minutes, the *Online* LED will light up, followed by a beep on SN6100 models once your product is up and running.

### Starting up SN160, SN160W, SN210, SN210W, SN310, SN-XS-Series-170, SN-S-Series-220, SN-S-Series-320 and SNi10 models

Plug your firewall into its power supply; it will start automatically. Wait a few minutes for all 3 LEDs – *Online*, *Status* and *Power* (2 *Power* LEDs on SN-S-Series-220 and SN-S-Series-320 models) to light up.

### i NOTE

If necessary during startup, you can insert a USB key containing a configuration. Console mode will display the following message: *"Please insert your USB token to continue"*.

The lit *Online* LED will indicate the end of the product's startup phase.



### SN160 and SN160W models

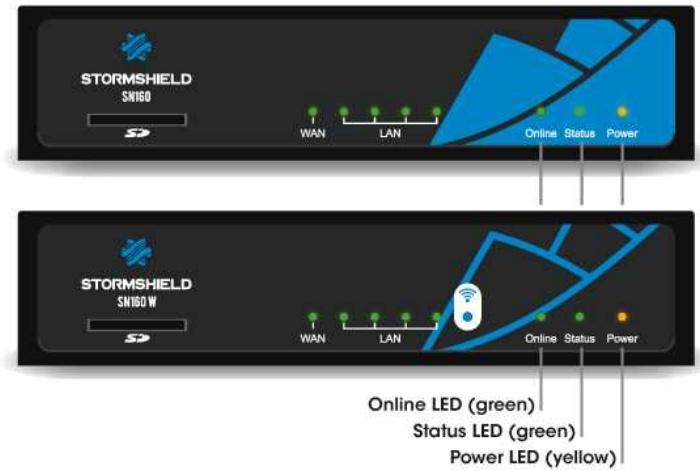

### SN210 and SN210W models

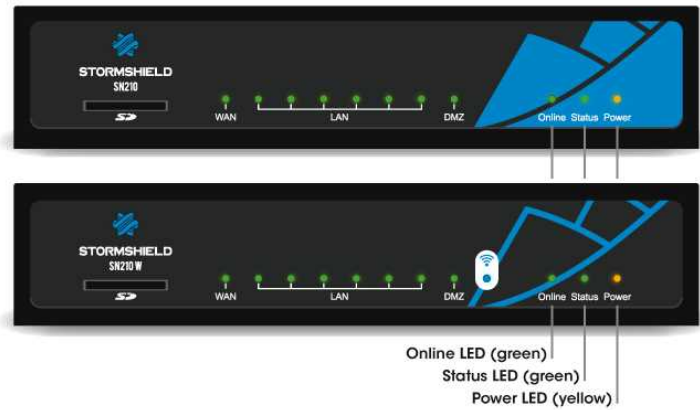

### SN310 model

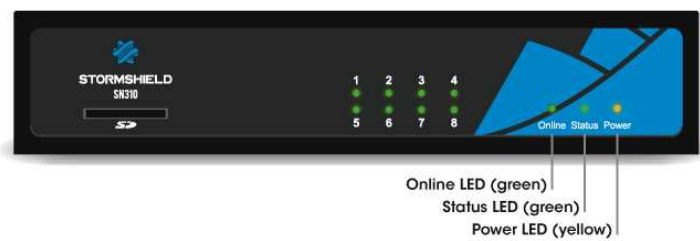

### SN-XS-Series-170 and SNi10 models

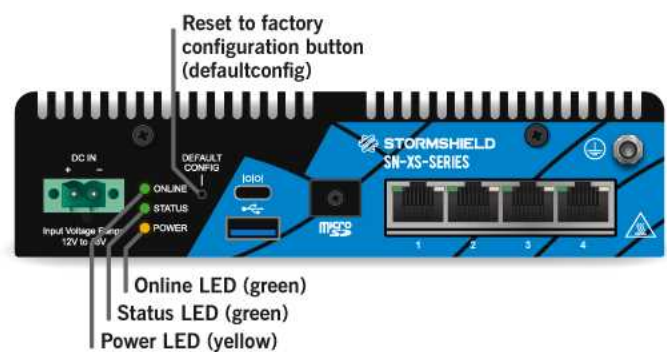



## SN-S-Series models

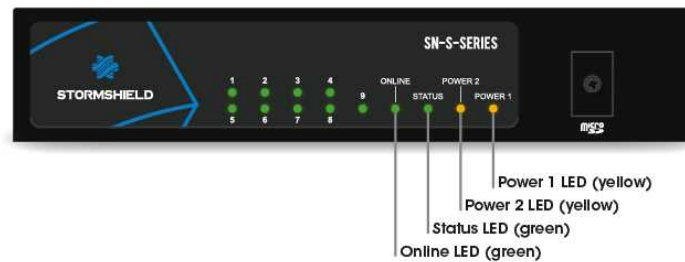

### Starting up SN510 and SN710 models

Plug your Stormshield Network Security firewall into the mains power supply. Ensure that the power supply switch is ON. Your firewall will then automatically start running. Wait a few minutes for all 3 LEDs – *Online*, *Status* and *Power* to light up.

#### **i** NOTE

When you hear 8 consecutive beeps, you will be able to insert a USB key containing a configuration if necessary. Console mode will display the following message: *"Please insert your USB token to continue"*.

Two consecutive beeps and the lighted up *Online* LED indicate the end of the product's startup sequence.

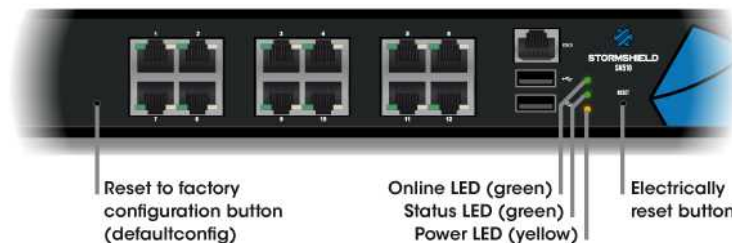

### Starting up SN910 models

Plug your Stormshield Network Security firewall into the mains power supply. Ensure that the power supply switch is ON. Your firewall will then start running automatically, the Power LED will light up. Then wait several minutes.

#### **i** NOTE

When you hear 8 consecutive beeps, you will be able to insert a USB key containing a configuration if necessary. Console mode will display the following message: *"Please insert your USB token to continue"*.

Two consecutive beeps indicate the end of the product's startup sequence.

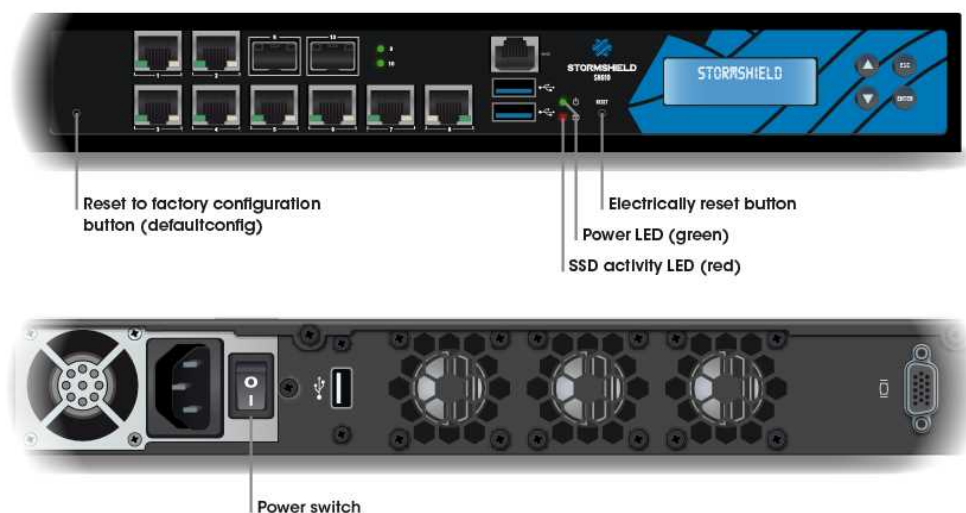

### Starting SN-M-Series-520, SN-M-Series-720 and SN-M-Series-920 models

Plug your Stormshield Network firewall into the mains power supply. Ensure that both power supply switches are ON. Your firewall will then start running automatically, the Power LED will light up. Wait a few minutes for all 4 LEDs – *Online*, *Status*, *Power 1* and *Power 2* to light up.

#### **i** NOTE

When you hear 8 consecutive beeps, you will be able to insert a USB key containing a configuration if necessary. Console mode will display the following message: *"Please insert your USB token to continue"*.

A beep indicates the end of the product's startup sequence.

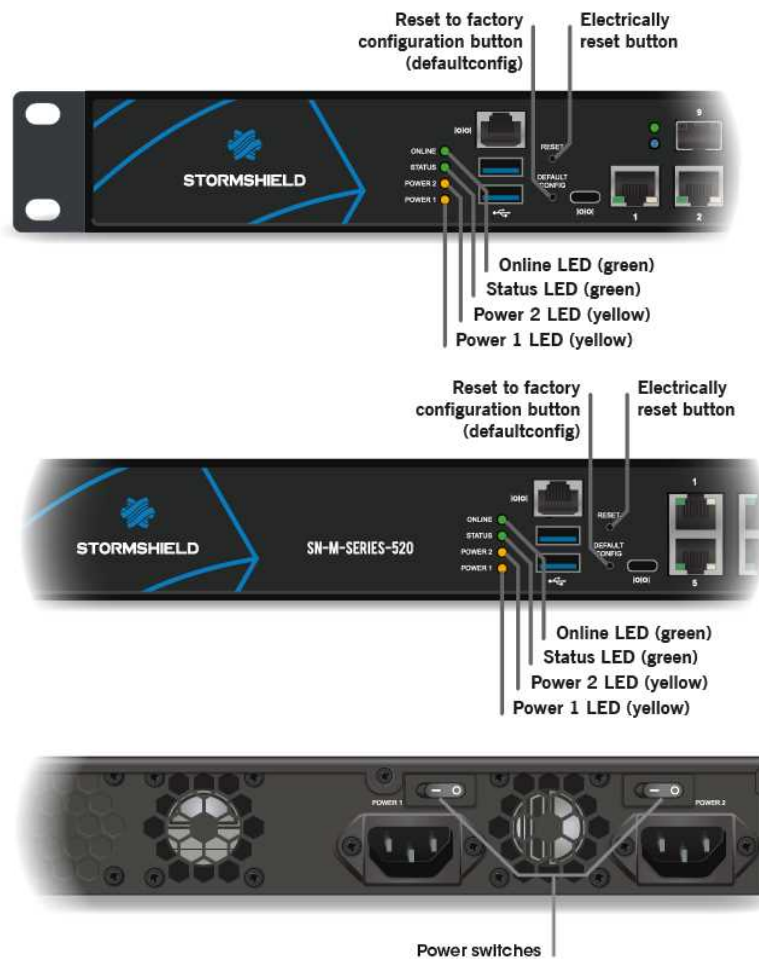

## Starting up SN1100, SN2100 and SN3100 models

As soon as the appliance is powered up, press once on the power button (rear panel). Wait a few minutes for all 3 LEDs – *Online*, *Status* and *Power* to light up.

### **i** NOTE

When you hear 8 consecutive beeps, you will be able to insert a USB key containing a configuration if necessary. Console mode will display the following message: "Please insert your USB token to continue".

Two consecutive beeps and the lighted up *Online* LED indicate the end of sequence..





### SN1100 model

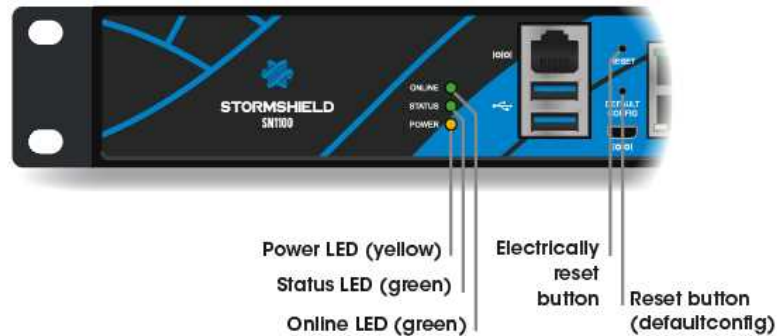

### SN2100 and SN3100 models

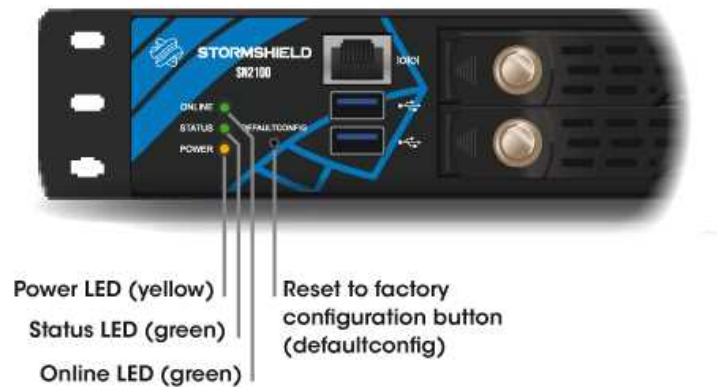

### Starting SN-L-Series-2200 and SN-L-Series-3200 models

Plug your Stormshield Network firewall into the mains power supply. As soon as the appliance is powered up, press once on the Power button (rear panel). Wait a few minutes for all 4 LEDs – *Online*, *Status*, *Power 1* and *Power 2* to light up.

#### **i** NOTE

When you hear 8 consecutive beeps, you will be able to insert a USB key containing a configuration if necessary. Console mode will display the following message: "Please insert your USB token to continue".

A beep indicates the end of the product's startup sequence.





## Starting up SN6100 models

As soon as the appliance is powered up, press once on the Power button (rear panel). Wait a few minutes for both LEDs – *Power* and *Run* to light up.

### **i** NOTE

When you hear 8 consecutive beeps, you will be able to insert a USB key containing a configuration if necessary. Console mode will display the following message: *"Please insert your USB token to continue"*.

Two consecutive beeps indicate the end of the product's startup sequence.

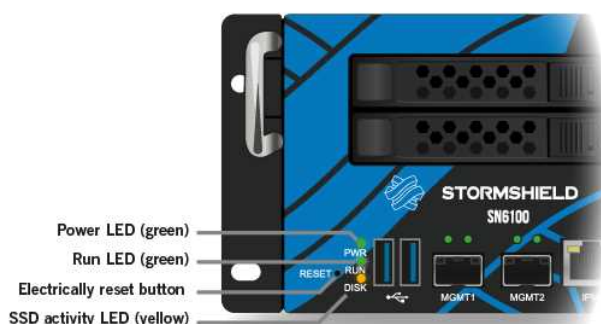

## Starting SN-XL-Series-5200 and SN-XL-Series-6200 models

Plug your Stormshield Network firewall into the mains power supply. As soon as the appliance is powered up, press once on the Power button (rear panel). Wait a few minutes for all 4 LEDs – *Online*, *Status*, *Power 1* and *Power 2* to light up.

### **i** NOTE

When you hear 8 consecutive beeps, you will be able to insert a USB key containing a configuration if necessary. Console mode will display the following message: *"Please insert your USB token to continue"*.

A beep indicates the end of the product's startup sequence.

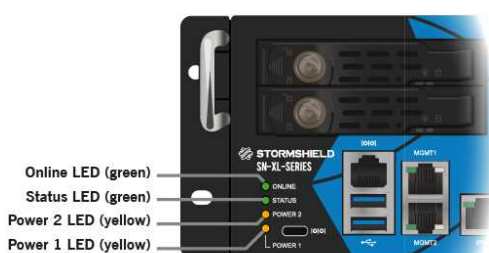



## Starting up SNI20 and SNI40 models

Once your firewall has been powered up, it will automatically start up. Wait a few minutes for both LEDs – *Power* and *Run* to light up.

### **i** NOTE

If necessary during startup, you can insert a USB key containing a configuration. Console mode will display the following message: *"Please insert your USB token to continue"*.

The lit *Run* LED will indicate the end of the product's startup phase.

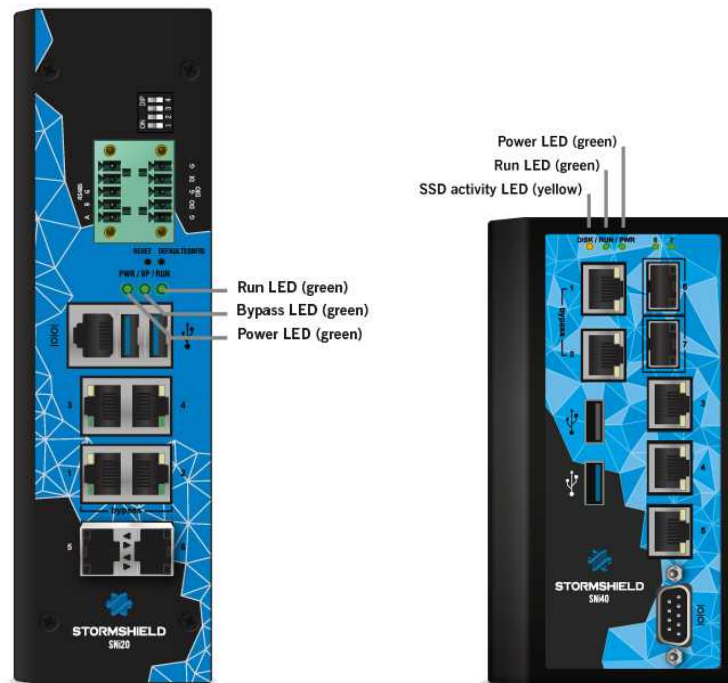

## Starting up SNxr1200 models

Once your firewall has been powered up, it will automatically start running and the *Power* LED will light up. Then wait several minutes.



## Initial connection to the appliance

A security procedure must be followed if the initial connection to the appliance takes place through an untrusted network. This operation is not necessary if the administration workstation is plugged in directly to the product.



Access to the administration portal is secured through the SSL/TLS protocol. This protection allows authenticating the portal via a certificate, thereby assuring the administrator that he is indeed logged in to the desired appliance. This certificate can either be the appliance's default certificate or the certificate entered during the configuration of the appliance (**Authentication > Captive portal**). Depending on the model, it is signed by default by the authority with the name:

- **NETASQ:** CN=serial number of the appliance, O=Secure Internet Connectivity, OU=NETASQ firewall Certification Authority.
- **Stormshield:** CN=Stormshield Products Root CA, O=Stormshield, OU=Cloud Services, C=FR, L=Issy-Les-Moulineaux.

To confirm a secure access, the browser must trust the certification authority that signed the certificate used, which must belong to the browser's list of trusted certification authorities. Therefore, to confirm the integrity of the appliance, before the initial connection, you need to add the authority to the list of the browser's trusted authorities. Depending on the model, the corresponding authority is available on these links:

<http://pki.stormshieldcs.eu/netasq/root.crt>

<http://pki.stormshieldcs.eu/products/root.crt>

If a certificate signed by another authority has been configured on the appliance, this authority will need to be added instead of the default authority.

As a result, the initial connection to the appliance will no longer raise an alert in the browser regarding the trusted authority. However, a message will continue to warn the user that the certificate is not valid. This is because the certificate defines the Firewall by its serial number instead of its IP address. To stop this warning from appearing, you will need to indicate to the DNS server that the serial number is associated with the IP address of the Firewall.

For further information, refer to the [SNS firewall Installation and first-time configuration guide](#).

## Administration graphical interface

On your client workstation, type the following address in your browser:

<https://10.0.0.254/admin>

Enter **admin** as the login and password.

### ! IMPORTANT

If you have connected your client workstation on port **1**, you will no longer be able to access the web administration interface. You will need to connect your computer to port **2** (or on another port), and reboot your firewall.

### i NOTE

The default password of the "admin" user (super administrator) must be changed the very first time the product is used. In the web administration interface, this password can be changed in **System > Administrator account > Administrator**.

This password must be set in line with the best practices described in the *User awareness* section in the [SNS user guide](#). This password must never be saved in the browser.

For further information on downloading and installing your license, refer the section [Updating the license](#).



## Shutting down

### SN160, SN160W, SN210, SN210W, SN310, SN-S-Series-220 and SN-S-Series-320

Log in to the configuration interface. Go to **System > Maintenance** and click on **Shut down the firewall**. Wait for several minutes until the *Online* and *Status* LEDs go out. For this model, the LEDs shut off in the following order:

**Online 1 → Status 2**

The *Power* LED will stay lit if the product is powered up.

### SN510, SN-XS-Series-170, SN-M-Series-520, SN710, SN-M-Series-720, SN-M-Series-920 and SNI10 models

Log in to the configuration interface. Go to **System > Maintenance** and click on **Shut down the firewall**. Wait a few minutes for all 3 LEDs – *Online*, *Status* and *Power* to go out. For these models, upon shutdown, the LEDs shut off in the following order:

**Online 1 + Status 2 → Power 3**

A beep will indicate that the appliance is in the process of shutting down.

### SN910

Log in to the configuration interface. Go to **System > Maintenance** and click on **Shut down the firewall**.

A beep will indicate that the appliance is in the process of shutting down. Wait for several minutes until the *Power* LED goes out.

### SN1100, SN2100, SN3100, SN-L-Series-2200, SN-L-Series-3200, SN-XL-Series-5200 and SN-XL-Series-6200 models

To shut down your firewall, press once on the power button located on the rear panel. Wait a few minutes for all 3 LEDs – *Online*, *Status* and *Power* to go out.

For these models, upon shutdown, the LEDs shut off in the following order:

**Online 1 + Status 2 → Power 3**

A beep will indicate that the appliance is in the process of shutting down (except on SN-L-Series-3200, SN-XL-Series-5200 and SN-XL-Series-6200 models).

### SN6100

To shut down your firewall, press once on the power button located on the rear panel. Wait a few minutes for the 2 LEDs (*Run* and *Power*) to go out. For this model, the LEDs shut off in the following order:

**Run 1 → Power 3**

A beep will indicate that the appliance is in the process of shutting down.



## SNi20

Log in to the configuration interface. Go to **System > Maintenance** and click on **Shut down the firewall**. Wait several minutes until the Run LED goes out and the Power LED turns to yellow. For this model, the LEDs shut off in the following order:

**Run 1 → Power 3**

The Power LED will stay yellow if the product is powered up.

## SNi40

Log in to the configuration interface. Go to **System > Maintenance** and click on **Shut down the firewall**. Wait a few minutes for the 2 LEDs (*Run* and *Power*) to go out. For this model, the LEDs shut off in the following order:

**Run 1 → Power 3**

## SNxr1200

Log in to the configuration interface. Go to **System > Maintenance** and click on **Shut down the firewall**. Wait for several minutes until the *Power* LED goes out.

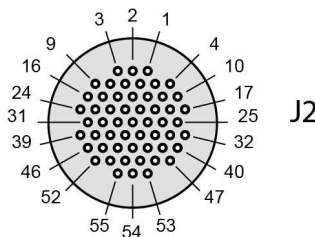

### ON/OFF switch

Details	Pin	Signal
ON	J2.10	POWER_BUTTON+
OFF	J2.11	POWER_BUTTON-

## General remarks

- The *Status LED 2* (Run for SN6100, SNi20 and SNi40 models) will blink in red (green for SN510 and SN710 models) in the event of a major failure on the product (hardware anomaly, faulty network interface, etc.). Contact your reseller in this case.
- During startup, shutdown or upgrading, only the LEDs *Status2* and *Power3* will light up.
- In High Availability mode, when the firewall is in passive mode, the *Online 1* or *Run* LED on SN6100, SNi20 and SNi40 models will blink (about 2 seconds off for every 1 second it is on).
- During the reset phase (*defaultconfig*), the *Online* and *Status* LEDs will blink (Run for SN6100, SNi20 and SNi40).
- To reboot an SN160, SN160W, SN210, SN210W, SN310 or SNi20 appliance that is still powered up (only the *Power* LED is on), you will need to unplug and plug the firewall back into the mains socket. It is also possible to reboot in console mode by pressing on any key as suggested.
- To reboot an SN-XS-Series-170 or SNi10 appliance that has been shut down (*Status* and *Power* LEDs off), proceed as follows: unplug it, wait for thirty seconds, then plug the firewall back into its power supply source.





- To reboot an SNI20 appliance that has been shut down (*Run* LED off and *Power* LED in yellow), proceed as follows: unplug it, wait for thirty seconds, then plug the firewall back into its power supply source.
- To reboot an SNI40 appliance that has been shut down (*Power* and *Run* LEDs off), proceed as follows: unplug it, wait for thirty seconds, then plug the firewall back into its power supply source.
- To reboot an SN510, SN710, SN910, SN-M-Series-720 or SN-M-Series-920 model (*Power* LED is off), proceed as follows: unplug it, wait for thirty seconds, then plug it back into the mains socket.
- You may also shut down your firewall by logging on in console mode and by typing the following command: `halt`



## Updating the license

Your appliance is delivered with a temporary license that must be updated. If you have acquired additional options or a security pack, you must update your product with the license that will allow you to use this option.

Maintenance packs are valid from the date on which the associated SNS products are registered on MyStormshield. If the product remains unregistered, this period will begin automatically three months from the billing date. Reminder: products must be registered to receive updates and be entitled to technical support.

### ! WARNING

Options that require you to restart the firewall are specified in the *License* section in the [SNS user guide](#).

Refer to the procedure below to find out how to update your product license.

## Retrieving licenses

1. Go to your personal area at <https://mystormshield.eu/>. During registration, you will obtain the password to access your personal area.
2. Enter your login and password then confirm or register in order to receive them. The client secure area homepage will appear.
3. Click on **Product management**. You will then see a list of all the Stormshield Network Security products registered in this area.
4. Select the product for which you wish to retrieve the license, by clicking on the product's serial number. Details of the license will be displayed.

### i NOTE

Before you download the license, you will need to know your product's version. If you do not know it, it is indicated on a label affixed to the product's cardboard packaging. If you no longer have the packaging, or if you have since updated your product, connect to your product via the web administration interface. The product's version will be indicated in the dashboard of the web application.

## Install license

If you have never installed a license on the product, the details of the license will be of the temporary license. To install the license that had been downloaded from the client secure area:

1. Log in to the administration interface.
2. Go to **License > General**.
3. Insert the downloaded license file in the relevant field.

You can also configure settings so that licenses can be automatically searched and installed. The full process is set out in the *License* section of the [SNS user guide](#).



# Documentation & assistance

## Documentation

The documentation for SNS multi-function firewalls is available online at <https://documentation.stormshield.eu>.

This website allows you to look up or download various technical documents such as user guides, technical notes, etc. The Installation and first-time configuration guide explains how to configure your firewall. This guide can be found at: <https://documentation.stormshield.eu/SNS/first-config>.

## MyStormshield personal area

Log in to the following address to access your MyStormshield personal area, or to create one: <https://www.mystormshield.eu>. Your personal area allows you to:

- Register your product,
- Activate and manage your user licenses and software options,
- Download the latest updates,
- Subscribe to technical and marketing mailing lists.

## Knowledge Base

The technical support department's Knowledge Base centralizes various technical entries relating to the use of Stormshield Network products. Its aim is to give a better understanding of how they work. You can access the Knowledge Base from your personal area or the following address: <https://kb.stormshield.eu>.

## Help desk

When you encounter hardware issues on your firewall, or if any of the components does not match its description, contact your certified partner.

For Stormshield Network products, there are different product return procedures called RMAs (return merchandise authorization). The various types of RMA are as follows:

1. RMA WITH STANDARD EXCHANGE:  
If the appliance has a valid **Standard** maintenance package
2. RMA WITH EXPRESS EXCHANGE:  
If the appliance has a valid **Express exchange** maintenance package
3. RMA WITH DOA EXCHANGE:  
If the product was registered **less than 30 days** before the RMA was activated.

The procedures and documents relating to these exchanges can be found on the MyStormshield online help website at <https://mystormshield.eu/documentation>.

In compliance with Common Criteria assumptions, clients must subscribe to the **Secure Exchange** option and follow the procedure for this type of exchange. This option ensures the confidentiality of the configuration elements imported into the Stormshield Network product before it is sent for repairs.



## Appendix A. Resetting firewalls

The default factory settings can be restored on a Stormshield Network Security firewall. This operation will bring the product back to its initial configuration. It does not modify the firmware version and only affects the active partition.

### ! WARNING

Resetting a firewall will completely erase the settings configured on the product. This operation is irreversible, so do not apply this procedure unless absolutely necessary. You are therefore advised to make a backup beforehand.

### ! WARNING

The product must not be unplugged while it is reinitializing.

After a few minutes, the initial settings will be recovered and the firewall will restart. This reset operation may take **up to 10 minutes**, so do wait until the end of the restart procedure before reconnecting to the firewall.

### i NOTE

The *Online* and *Status* (Run on SN6100, SNi20 and SNi40) LEDs will blink throughout the entire initialization phase. Two consecutive beeps (except on SN160, SN160W, SN210, SN210W, SN310, SNi20 and SNi40 models) and the lighted up *Online* (Run on SN6100, SNi20 and SNi40) LED indicate the end of the product's startup sequence.

### ! WARNING

This operation will also reinitialize the administrator's password. The login and password are **admin** by default.

### All models except SN-L-Series-2200, SN-L-Series-3200, SN6100, SN-XL-Series-5200, SN-XL-Series-6200, SNi40 and SNxr1200

Use a pointed object to reset your firewall. A small pushbutton is accessible through a hole in the following locations:

- On SN160, SN160W, SN210, SN210W and SN310 models, on the rear panel of the product, to the right of the Ethernet interfaces.
- On SN510 models, on the front panel of the product, to the left of the Ethernet interfaces.
- On SN710 and SN910 models, on the front panel of the product, between the extension module slot and the Ethernet interfaces.
- On SN-M-Series-720, SN-M-Series-920 and SN1100 models, on the front panel of the product, between the USB ports and the Ethernet interfaces,
- On SN2100 and SN3100 models, on the front panel of the product, between the LEDs and USB ports,
- On SN-XS-Series-170, SNi10 and SNi20 models, on the front panel of the product, to the right above the LEDs.



Reset to factory configuration  
button (defaultconfig)

**SN160 and SN160W models**



Reset to factory configuration  
button (defaultconfig)

**SN210 and SN210W models**



Reset to factory configuration  
button (defaultconfig)

**SN310 model**

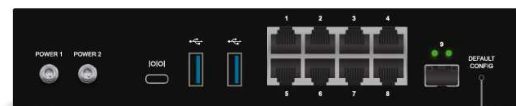

Reset button  
(defaultconfig)

**SN-S-Series-220 and SN-S-Series-320**

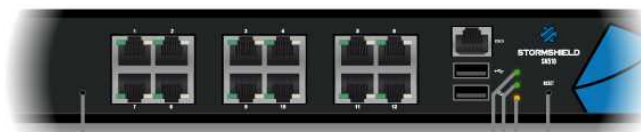

Reset to factory  
configuration button  
(defaultconfig)

Online LED (green)  
Status LED (green)  
Power LED (yellow)

Electrically  
reset button

**SN510 and SN710 models**

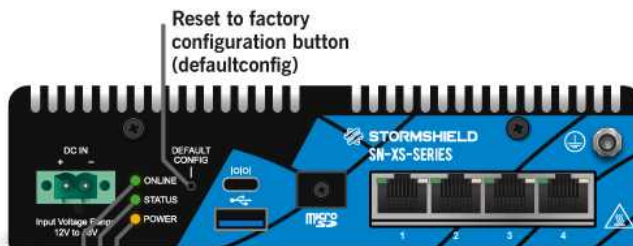

Reset to factory  
configuration button  
(defaultconfig)

Online LED (green)  
Status LED (green)  
Power LED (yellow)

**SN-XS-series-170 and Sni10 models**



Reset to factory  
configuration button  
(defaultconfig)

Electrically  
reset button

Online LED (green)  
Status LED (green)  
Power 2 LED (yellow)  
Power 1 LED (yellow)

**SN-M-Series-520 model**



Reset to factory configuration  
button (defaultconfig)

Electrically reset button  
Power LED (green)  
SSD activity LED (red)

**SN910 model**

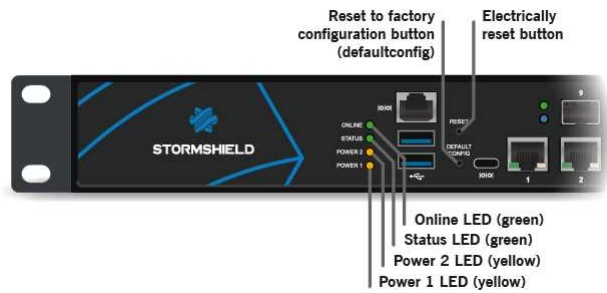
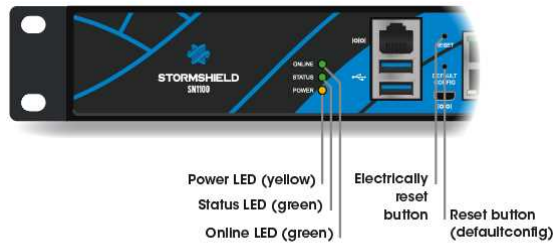
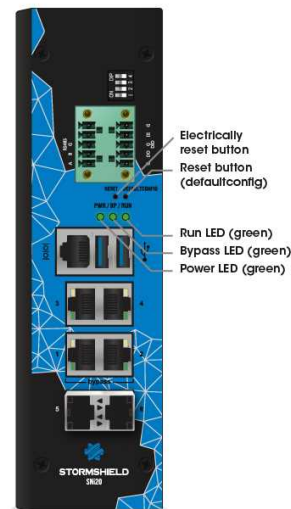
**SN-M-Series-720 and SN-M-Series-920 models****SN1100 model****SN2100 and SN3100 models****SNi20 model**

Hold down the button for about 5 seconds, until you see the *Online* and *Status* (*Run* on SNi20 models) LEDs blink and/or until you hear an audible signal. The reset procedure will automatically launch. After a few minutes, the initial settings will be recovered and the firewall will reboot.

## SN-L-Series-2200, SN-L-Series-3200, SN6100, SN-XL-Series-5200, SN-XL-Series-6200, SNi40 and SNxr1200 models

Factory settings can be restored on SN-L-Series-2200, SN-L-Series-3200, SN6100, SN-XL-Series-5200, SN-XL-Series-6200, SNi40 or SNxr1200 models, only in console mode. Type the following command: `defaultconfig -f -r -p`

The reset procedure will automatically launch. After a few minutes, the initial settings will be recovered and the firewall will reboot.





## Annexe B. Storing logs

For models equipped with a hard disk or SSD, the log storage service is enabled by default, except on SNi40 models. To enable it, refer to the section *Enable log storage* below.

### External log storage on SD/micro SD cards (SN160, SN160W, SN210, SN210W, SN310, SN-XS-Series-170, SN-S-Series-220, SN-S-Series-320, SNi10 and SNi20)

#### **i** NOTE

Logs can only be stored externally on SD or microSD cards. This service is not compatible with other media such as a USB key or an external hard disk.

On SN160(W), SN-XS-Series-170, SN210(W), SN-S-Series-220, SN310, SN-S-Series-320, SNi10 and SNi20 models, you can obtain the full feature by using an external storage medium such as:

- SD cards for SN160(W), SN210(W), SN310 and SNi20 models;
- MicroSD cards for SN-XS-Series-170, SN-S-Series-220, SN-S-Series-320 and SNi10 models.

The recommended type of SD/microSD card is at least **Class 10 (C10) UHS Class 1 (U1) or App Performance 2 (A2)**. The memory card must be in **SDHC or SDXC standard**. Only adapters provided with the card must be used. The maximum memory size supported is 2 TB.

Stormshield recommends the use of **high-endurance/industrial** cards or preferably, those that have a built-in **MLC** flash chip developed by major brands (e.g., SanDisk, Western Digital, Innodisk, Transcend, etc.) and with at least 32 GB.

Insert the SD card, as described in the diagram to the right, with the connector facing downwards.



#### **!** IMPORTANT

Specific screwdrivers must be used to remove the screws from the SD/microSD card reader cache:

- **SN-XS-Series-170, SNi10 and SNi20 models:** Phillips PH1,
- **SN-S-Series-220 and SN-S-Series-320 models:** Phillips PH0.

Insert the SD/microSD card, then put back the SD card reader cache to guarantee that the product is airtight.



SNI20 model



SN-S-Series-220 and SN-S-Series-320 models



SN-XS-Series-170 and SNI10 models

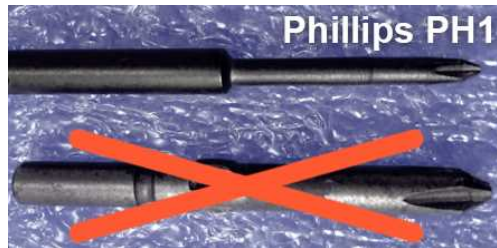

You must then enable and format the SD/microSD card - refer to the following section.

## Enabling log storage

Enable the service in **Configuration > Notifications > Logs - Syslog - IPFIX > Local storage**.

NOTIFICATIONS / LOGS - SYSLOG - IPFIX

LOCAL STORAGE   SYSLOG   IPFIX

☒ ON

Do not eject the SD card when the log storage service is enabled. Reminder: you must disable log storage and apply the configuration before ejecting the SD card.

Storage device

Device:

If you wish to save logs on an SD/microSD card, hard disk or SSD, click on the option to turn it ON, then select your medium from the list of storage media. A message will prompt you to format it.

After this operation, your SD/microSD card, hard disk or SSD will be ready to receive all logs.

## Loading the SD/microSD card

### ! IMPORTANT

Before ejecting the SD card from the drive, to change media, for example, you must first shut



down the service by unselecting the option that enables log storage, in the **Logs - Syslog** module.

To eject the SD/microSD card, press lightly and horizontally on it, then let go.

## Reading logs

These logs can be read in the **SN Activity Reports** web interface in the form of reports.

In **SN Activity Reports**, five reports are enabled by default. The number of reports enabled can be increased on models that are equipped with hard disks or an SSD or with the help of an SD/microSD card.

For more information, refer to the *Reports* section in the [SNS user manual](#).



## Appendix C. Managing SSDs

An SSD is installed by default on the SN2100 model. A second SSD can be added to it by subscribing to the RAID option (RAID1).

By default on SN3100, SN-L-Series-2200, SN-L-Series-3200, SN6100, SN-XL-Series-5200 and SN-XL-Series-6200 models, both SSDs are installed in RAID (RAID 1). Both of these SSDs are also hot-swappable.

### NOTE

On SN2100 models without the RAID option, the replacement of the SSD would cause logs and static reports saved on the log partition to be lost, as well as data memorized using the HTTP Cache option if it has been enabled.

## Detecting issues

The SMART (Self-Monitoring, Analysis and Reporting Technology system) status of SSDs can be monitored. SMART technology monitors and informs about the status of certain reliability indicators such as the temperature, number of sectors allocated, errors while locating sectors, etc. It therefore helps to anticipate failures.

On SN910, SN-M-Series-520, SN-M-Series-720, SN-M-Series-920, SN1100 and SN2100 models without the RAID option, and on SNi20 and SNi40 models, the SMART status of the SSD is available in the *Hardware* section of the **Hardware** widget.

On SN2100 models with the RAID option, and on SN3100, SN-L-Series-2200, SN-L-Series-3200, SN6100, SN-XL-Series-5200 and SN-XL-Series-6200 models, the *RAID* section in the **Hardware** widget informs you about the SMART status of the SSDs, as well as the RAID status.

You may also log on to the appliance in console mode or via an SSH connection and obtain the information with the following commands:

- SMART status of the SSDs: `smartinfo`,
- If SSDs are installed in RAID: `nraid -s`,

If an issue arises with the log partition, report it using the Properties widget either in console mode or via an SSH connection, using the command: `logdisk -c`, the partition can be rebuilt using the following command: `logdisk -f`.

### IMPORTANT

This command permanently erases data saved earlier on the log partition.

If the SMART status of an SSD shows errors, or if rebuilding your log partition fails, you can contact your certified partner to replace your SSD.

## Replacing an SSD

### SN2100, without RAID option

This procedure is to be carried out on an appliance that has been powered off. To remove the SSD, unlock the rack with the lever, then pull out the canister with the defective SSD. Insert the



new canister with the replacement SSD obtained from your partner, until you hear a click. Once you have inserted the new SSD, it will be detected the next time you start the appliance.

### SN2100 with RAID option, SN3100, SN-L-Series-2200, SN-L-Series-3200, SN6100, SN-XL-Series-5200 and SN-XL-Series-6200 (SSD in RAID 1)

This procedure is to be carried out on an appliance that is running. To remove the SSD, unlock the rack with the lever, then pull out the canister with the defective SSD. Insert the new canister with the replacement SSD obtained from your partner, until you hear a click. Once you have inserted the new SSD, type the following command to scan this new SSD: `nraid -z`.

Next, type the command to rebuild the RAID: `nraid -r`.

### RAID option (SN2100)

On the SN2100 model, the RAID option can be subscribed in order to add a second SSD and build a RAID1 on it.

On a powered up appliance:

1. In console mode, type the following command to build the RAID: `nraid -c`.
2. Unlock the rack with the lever, then pull out the empty canister (lower canister, LEDs off).
3. Insert the new canister with the optional SSD obtained from your partner, until you hear a click.
4. Type the following command to scan this new SSD: `nraid -z`.
5. type the following command to replicate the data on the RAID: `nraid -r`.

### Big Data option (SN2100, SN3100, SN-L-Series-2200, SN-L-Series-3200, SN6100, SN-XL-Series-5200 and SN-XL-Series-6200)

If you have subscribed the *Big Data* option (available on SN2100, SN3100, SN-L-Series-2200, SN-L-Series-3200, SN6100, SN-XL-Series-5200 and SN-XL-Series-6200 models), the original SSDs will be replaced with SSDs of greater capacity.

After you have shut down the appliance:

1. Unlock the rack with the levers, then pull out both SSD canisters.
2. Insert the new canisters with the replacement SSDs obtained from your partner, until you hear a click. They will be detected the next time you start the appliance.



## Appendix D. Exchanging a power supply module

### REMINDER

Before plugging any equipment into a -48VDC power supply module, please read the [Safety rules](#) carefully and follow them.

### SN1100, SN2100, SN3100, SN-L-Series-2200, SN-L-Series-3200, SN6100, SN-XL-Series-5200 and SN-XL-Series-6200 models

### NOTE

On SN1100 and SN2100 models, a second AC mains supply or -48VDC module can be ordered separately for redundant power supply. Modules are hot-swappable on products with a redundant power supply.



SN1100, SN2100, SN3100, SN-L-Series-2200, SN-L-Series-3200, SN-XL-Series-5200 and SN-XL-Series-6200 models





SN1100, SN2100 and SN3100 models

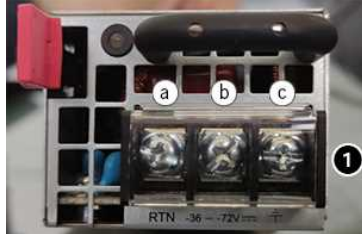

SN-L-Series-2200 and SN-L-Series-3200 models

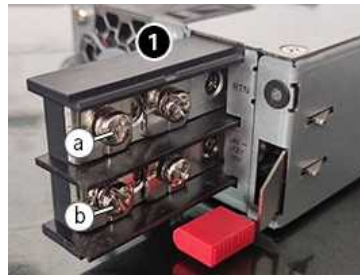

SN-XL-Series-5200 and SN-XL-Series-6200 models

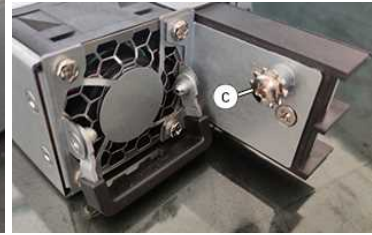

1. Disconnect the module from the power supply:
  - **AC mains supply:** disconnect the mains cable.
  - **- 48VDC supply:** first, disconnect the power cord from the 48VDC source. Next, on the module, remove the protective cover 1, then use a screwdriver to disconnect the three supply wires.
2. Extract the module: push the release lever sideways toward the extraction handle, and use the handle to pull the module. Hold the case of the module and remove it completely.
3. Insert the new module with the product label facing upwards. When the module is fully inserted, push until you hear a “click” that indicates that the module is locked in place. Check that the module is locked in place by pulling gently on the extraction handle: the module must not move.
4. Attach the new module to its power supply:
  - **AC mains supply:** connect the mains cable.
  - **- 48VDC:** with the power cord disconnected from the 48VDC supply, use a screwdriver to attach the three wires of the power cord to the module 1 as shown below:
    - a. Phase
    - b. Neutral
    - c. Grounding
5. Reattach the protective cover. The wires must be connected to the 48VDC module as shown above. Next, connect the power cord to the power supply source.

Each PSU module is equipped with a light showing its state (two colors: green/red for the AC mains module, blue/red for the -48VDC module):

#### Module working correctly

- Module connected to a power source but not installed in a firewall: green (AC mains)/blue (-48VDC).

#### SN1100, SN2100, SN3100, SN-L-Series-2200 and SN-L-Series-3200 models halted

- Module installed but not connected to a power source, and the other module is installed and connected: green (AC mains)/blue (-48VDC), blinking.
- Module installed and connected to a power source: green (AC mains)/blue (-48VDC), blinking.

#### SN1100, SN2100, SN3100, SN-L-Series-2200 and SN-L-Series-3200 models running

- Module installed and connected to a power source: green (AC mains)/blue (-48VDC), not blinking.
- Module installed and not connected to a power source: red, blinking (+ buzzer).

#### Module not functioning correctly



- Module connected to a power source: red, not blinking.

## SN6100

### **i** NOTE

This model is equipped with an internal redundant power supply and its modules are hot-swappable.



SN6100 model

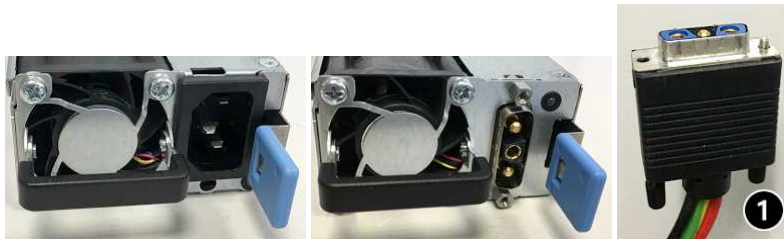

1. Disconnect the module from the power supply:
  - **AC mains supply:** disconnect the mains cable.
  - **-48VDC supply:** unscrew the knurled screw, then unplug the power cord on the module side.
2. Extract the module: push the release lever sideways toward the extraction handle, and pull the handle. Hold the case of the module and remove it completely.

### **!** WARNING

The module's metal case serves as a heat sink and its temperature can reach +60°C at full power. It is therefore advisable to use a glove to hold the case.

3. Insert the new module with the product label facing upwards. When the module is fully inserted, push until you hear a “click” that indicates that the module is locked in place. Check that the module is locked in place by pulling gently on the extraction handle: the module must not move.



4. Attach the new module to its power supply:

- **AC mains supply:** connect the mains cable.
- **-48VDC supply:** plug in the supply cable's connector 1. Screw in the knurled screws.

Each PSU module is equipped with a light showing its state (two colors: green/red):

**Module working correctly**

- Module connected to a power source but not installed in a firewall: green, blinking.

**SN6100 halted**

- Module installed but not connected to a power source, and the other module is installed and connected: red, not blinking.
- Module installed and connected to a power source: green, blinking.

**SN6100 (running)**

- Module installed and connected to a power source: green, not blinking.
- Module installed and not connected to a power source: red, not blinking (+ buzzer).

**Module not functioning correctly**

- Module connected to a power source: red, not blinking.



## Appendix E. Managing firewalls via IPMI

IPMI (Intelligent Platform Management Interface) is a network protocol that makes it possible to obtain hardware information remotely, monitor certain components and control appliances (control, reboot, interruption, etc.).

### SN6100, SN-XL-Series-5200 and SN-XL-Series-6200 models

#### Configuration

When the product is starting up, once the Stormshield logo appears, press <del> to access the BIOS. Next, go to the section "BMC network configuration" in the Server Mgmt menu in order to configure the network interface dedicated to IPMI, then save and quit.

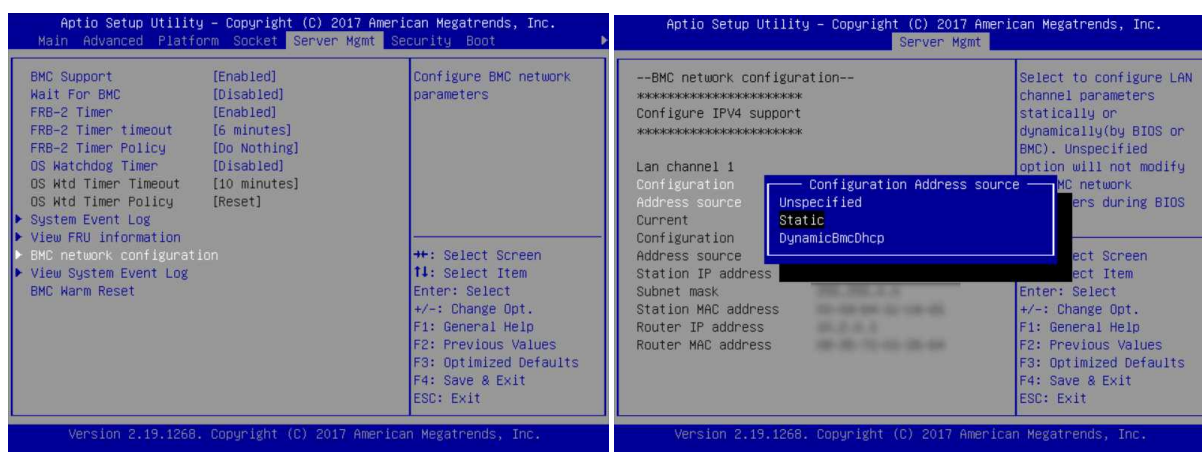

#### Connection

Plug the network cable into the dedicated network interface on the front of the appliance.

Launch your browser and connect to the dedicated interface by entering the address:  
[http://<ip\\_if\\_ipmi>](http://<ip_if_ipmi>).

- **SN6100**  
If an address has not yet been configured, the default IP address of the IPMI interface will be 192.168.0.100/24
- **SN-XL-Series-5200 and SN-XL-Series-6200**  
If an address has not yet been configured, the IPMI interface will not have an assigned default IP address; an address has to be entered.

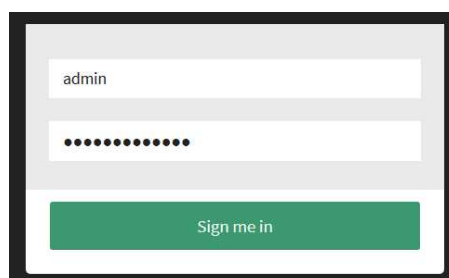

The login and password are **admin** by default.



The dashboard of the web interface will look like this:

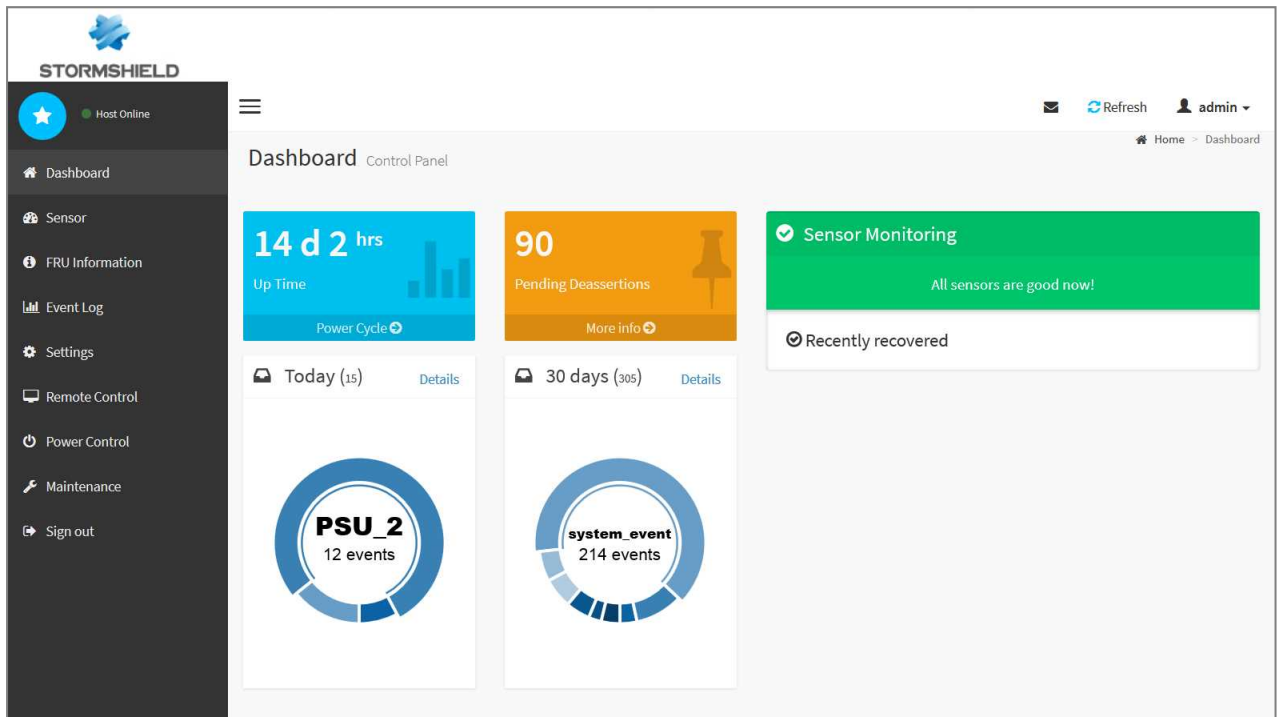

**! IMPORTANT**

Change your *admin* administrator password as soon as you can. You will be asked to change it during the initial connection. You are also advised to place the IPMI interface on a dedicated administration network.



**STORMSHIELD**

[documentation@stormshield.eu](mailto:documentation@stormshield.eu)

*All images in this document are for representational purposes only, actual products may differ.*

*Copyright © Stormshield 2024. All rights reserved. All other company and product names contained in this document are trademarks or registered trademarks of their respective companies.*